

# INDRO INDUSTRIES



AN ISO 9001: 2015 CERTIFIED COMPANY

ENGINEERS, MANUFACTURER & FABRICATORS

13/6, NATABAR PAUL ROAD (KADAMTALA) HOWRAH – 711 101. WEST BENGAL

TEL.NO.033-2643-8105, E.MAIL:indroindustries@yahoo.co.in Website: www.indroindustries.com

## QUOTATION

QUOTATION NO-II/Q/172/2023-24  
REF ENQ. NO. EN230601219 ✓

DATE 16.06.2023  
DATE 16.06.2023

TO,  
M/S. JINDAL ALUMINIUM LIMITED  
BHIWADI, RAJASTHAN

Dear Sir,

*After discussion with Mr. ~~Sushanta~~ Sushanta  
~~Behra~~ Behra. please see file.*

Thanking you for your above enquiry and we are pleased to submit our lowest best offer. Our terms & conditions are given below.

| SL.NO | ITEM CODE. | Materials Description  | Quantity | Prices   | Per  |
|-------|------------|--|----------|----------|------|
| 1.    | 08990044   | BEARING HOSING COVER, PART NO- 8 , AS PER DRAWING NO DP-ICM-06-A2                      | 02 NOS.  | 450/-    | EACH |
| 2.    | 08250047   | SPUR GEAR FOR INGOT CHARGING MACHINE AS PER DRG. NO.MF-10-42-A4                        | 01 NOS.  | 3,500/-  | EACH |
| 3.    | 06410047   | SPUR GEAR AS PER DRG.NO.MF-10-41-A4  | 01 NOS.  | 18,500/- | EACH |
| 4.    | 08990014   | M.S. BEARING BLOCK AS PER DRAWING NO DP-ICM-03-A2                                      | 04 NOS.  | REGRET   | EACH |
| 5.    | 08990024   | NON-DRIVE SHAFT FOR INGOT CHARGING MACHINE PART NO.-4, AS PER DRAWING NO. DP-ICM-06-A2 | 01 NOS.  | 1,300/-  | EACH |
| 6.    | 08990025   | DRIVE SHAFT FOR INGOT CHARGING MACHINE PART NO. -3, AS PER DRAWING NO. DP-ICM-019-A3/1 | 01 NOS.  | 2,600/-  | EACH |
| 7.    | 08990043   | M.S. BRACKET, PART NO-6 , AS PER DRAWING NO DP-ICM-06-A2                               | 01 NOS.  | 3,100/-  | EACH |
| 8.    | 08990015   | M.S. BRACKET PART NO.-6, AS PER DRAWING NO. DP-ICM-06-A2                               | 08 NOS.  | 3,100/-  | EACH |

HSN CODE 84834000

*→ 5% Discount on above price*

We trust our offer will be acceptable to you and will be favored with your valued order. *Above price see file*

### TERMS & CONDITIONS.

GOODS & SERVICE TAX : G.S.T. 18% WILL BE CHARGE EXTRA  
TRANSPORTATION : DOOR DELIVERY BASIS.  
PAYMENT : WITH IN 30 DAYS.  
DELIVERY : WITHIN 6-8 WEEKS  
INSPECTION : AT YOUR WORKS  
VALIDITY : 30 DAYS

PRICE BASIS : FOR BHIWADI. *FOR-JAL*

P & F : INCL. — / EXTRA —

GST/IGST : *18% Extra*

FOR INDRO INDUSTRIES

DELIVERY : *10-days*  
SUSANTA BERA

PAYMENT : *30-days*

GCW/CIC : —

VALIDITY : —

Mobile No. 9831030323

OUR G.S.T. NO. 19AAFFI1702C1ZX

*11/04*

# SHIVAM ENGINEERING

Deals in : All Kinds of Work Shop Facilities, Fabrication Work & Maintenance  
Contact For Plant & Machineries

WORKS : G1-568-B, RIICO INDL. AREA, BHIWADI-301019 (RAJ.)

On Monday, 19 June 2023 10:27 am IST, purchased from Shivam Engineering Private Limited <shivamengr@indialuminium.com> Write: <shivamengr@indialuminium.com>

Ref. No. ....

## QUOTATION

Date : 17/6/2023

To, M/s. Jindal Aluminium Ltd.  
SP-2/333 RIICO Ind. Area.  
Bhiwadi, Alwar (Raj)

Your Enquiry No - EN-230601219/DT 16.6.2023

Subj - Spares for Ingot charging m/c.

Kind. Attn :- Mr. Rajgopal C. Sarda / Mr. Vipul.

D/Siv. As above Spares New Supply (with Material) as per drawing, So, I am giving our prices as under-

- |  |                         |
|--|-------------------------|
| 1. Non Drive Shaft (Drg. No - DP-ICM-06-A2)<br>Part No - 4, Size - $\phi 55 \times 266$ mm Long.<br>Dia All over Grinding. | } Rs. 2650/-<br>Per Set |
| 2. Bearing Housing Cover (Drg. No - DP-ICM-06-A2)<br>Part No - 8, Size - $\phi 150 \times 111$ mm.                         |                         |
| 3. Drive Shaft (Drg. No - DP-ICM-019-A3)<br>Part No - 3; Size - $\phi 65 \times 399$ mm Long.<br>All over grinding.        | } Rs. 4350/-<br>Per Set |
| 4. Spur Gear - (Drg. No - MF-10-41-A4)<br>Size - $\phi 400 \times 80$ mm / No. of Teeth - 38                               |                         |
| 5. Spur Gear - Drg. No - MF-10-42-A4<br>Size - $\phi 170 \times 80$ mm / No. of Teeth - 15                                 | } Rs. 4150/-<br>Per Set |
| 6. M3 Bearing Block (Drg. No - DP-ICM-03-A2)<br>Size - $266 \times 216 \times 46$ mm / Part No - 5                         |                         |
| 7. M3 Pin (Drg. No - DP-ICM-06-A2)<br>Size - $216 \times 216 \times 46$ mm / Part No - 06                                  | } Rs. 5500/-<br>Per Set |
| 8. M3 Pin (Drg. No - DP-ICM-06-A2)<br>Size - $216 \times 216 \times 46$ mm / Part No - 06                                  |                         |

After discussion with  
Mr. Das Jiyani's faithfully  
price out first.  
(for Shivam Engineering)

DISCOUNT : ~~5%~~ 2%

PRICE BASIS : F.O.B. BHIWADI

P & F : INCL. / EXTRA

GST/IGST : 18% Extra

Payment

DELIVERY : 100% Material delivery

PAYMENT : 30-days

VALIDITY : 15/6/2023

CHECKED BY : Vipul

15/6/2023

# RAJPUT INDUSTRY.

BHIWADI, RAJSTHAN,  
301019  
06IHJPS9548M1Z2

→ Discount of 7% on  
Item code 2, 3, 4, 5, 7, 8

To  
M/s. JINDAL ALUMINIUM LIMITED  
Plot No. Sp-2/333 RIICO IND AREA BHIWADI  
GST NO - 08AAACJ4324M1ZH

→ Material is EN-8

Kind Attn.: Mr. JINDAL ALUMINIUM

→ After dimension with Mr. Sunny  
Roy, Price are find.

Respected Sir,  
Please check below quotation....

## CHECK LIST

DISCOUNT : Below price are find

PRICE BASIS : FOR BHIWADI FOR-JAL

DATE: 16.06.2023

P & F : INCL / EXTRA

PIN CODE  
GST NO.

GST/IGST : 18% Extra

DELIVERY : 10-days

PAYMENT : 15-days

GC/WC/TC : -

VALIDITY : Subject: Quotation

CHECKED BY: Vipul

19/06/2023

| S.No.    | Item Name & Discription                                     | HSN  | Qty. | Unit | Rate        | Amount                     |
|----------|---|------|------|------|-------------|----------------------------|
| 1        | Spur Gear For Ingot Charging Machine<br>No of MF-10-42-A4   | 7214 | 1    | Pcs  | 5520        | <del>5520</del> ✓ 3000/-   |
| 2 ✓      | M,S Bracket Dp-ICM-06-A2                                    | 7214 | 1    | Pcs  | 2900        | 2900 ✓                     |
| 3 ✓      | M,S Bracket DP-ICM-06-A2 Part No 6                          | 7214 | 6    | Pcs  | 2900        | <u>17400</u>               |
| 4 ✓      | M,S Bearing Block DP-ICM-03-A2 Part<br>No - 5               | 7214 | 4    | Pcs  | <u>3150</u> | <u>12600</u>               |
| 5 ✓      | Drive Shaft For Ingot charging<br>Machine DP-ICM-019-A3/1,, | 7214 | 1    | Pcs  | 2550        | 2550                       |
| 6        | Spur Gear DRG.NO.MF-10-41-A4,,                              | 7214 | 1    | Pcs  | 20700       | <del>20700</del> ✓ 12000/- |
| 7 ✓      | Bearing Housing Cover DP-ICM-06-A2                          | 7214 | 2    | Pcs  | <u>620</u>  | 1240                       |
| 8 ✓      | Non Drive Shaft For Ingot DP-ICM-06-<br>A2,,                | 7214 | 1    | Pcs  | <u>2150</u> | <del>2150</del> 1235/-     |
| G. Total |   |      |      |      |             | 65060.00                   |

Terms and Condition:



HARDEN TO 28-30 HRC.

Nos. of Teeth = 15.

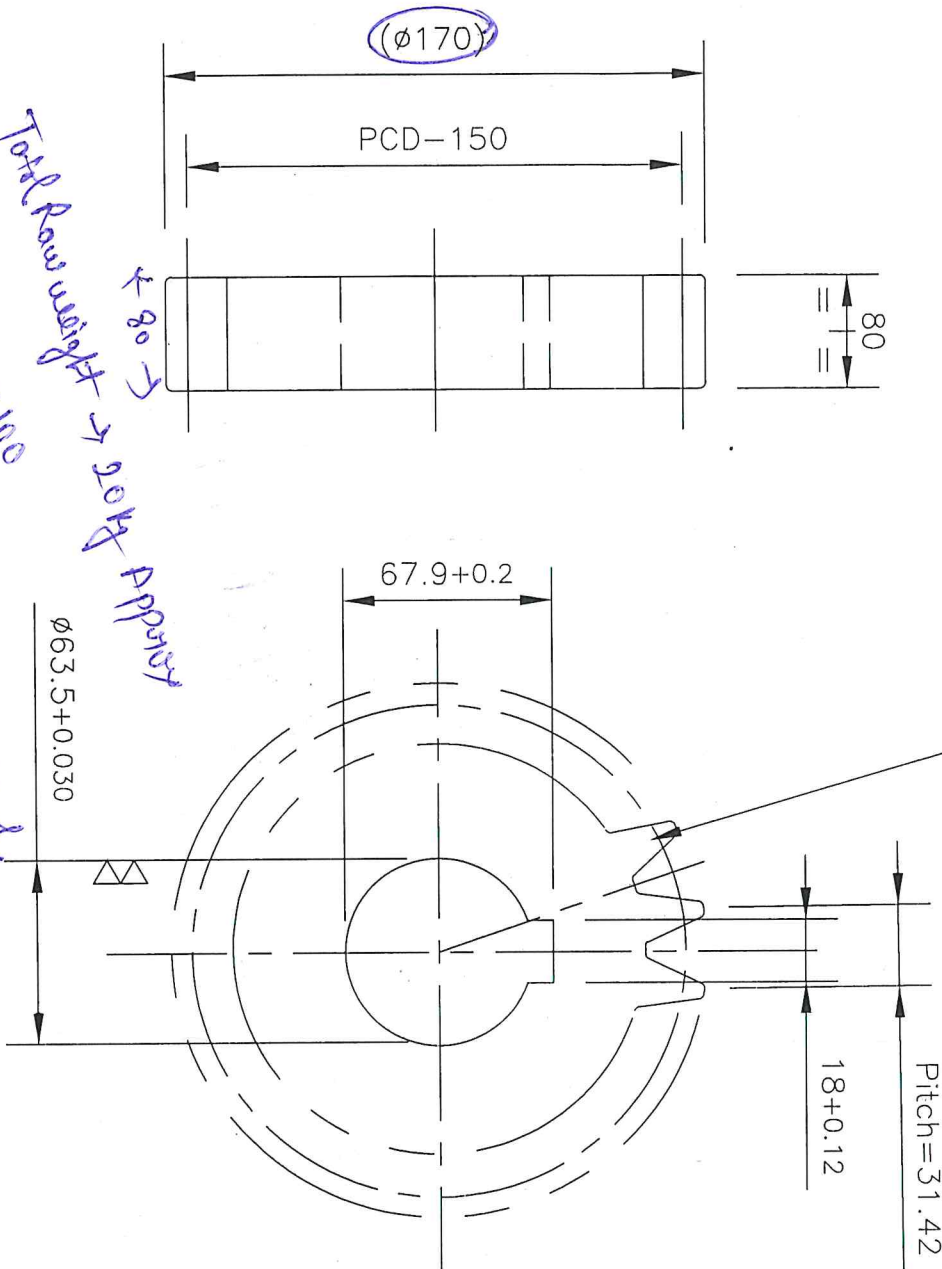

SPUR GEAR DATA

| Sl.No | Description             | DATA                |
|-------|-------------------------|---------------------|
| 1     | Nos. of Teeth on Pinion | $z = 15$ ✓          |
| 2     | Module                  | $m = 10$            |
| 3     | Pressure angle          | $\alpha = 20^\circ$ |
| 4     | Addendum                | $ha = 10$           |
| 5     | Dedendum                | $hf = 12.5$         |
| 6     | Tip Clearance           | $c = 2.5$           |
| 7     | Total tooth height      | $h = 22.5$          |
| 8     | Pitch Diameter          | $d = 150$           |
| 9     | Outside Diameter        | $da = 170$          |
| 10    | Pitch                   | $p = 31.42$         |

Total Raw weight  $\rightarrow$  200g Approx  
 Raw weight  $\rightarrow$  200g +/-  
 Including Machining 3000g +/-

| Rev. | Description | Initial | Date |
|------|-------------|---------|------|
|      |             |         |      |

  

|   |  |             |                   |
|---|--|-------------|-------------------|
| PART NO.  | 9  | QUANTITY    | 1                 |
| PART NAME   | PINION                                       | MATERIAL    | C45 [EN8]         |
| SUB ASSY.   | DRIVE ARRANGEMENT OF INGOT CHARGING MACHINE. | BLANK SIZE  | -                 |
| MAIN ASSY. TITLE  | INGOT CHARGING MACHINE.                      | DRAWN       | C.ARUU 12.09.2001 |
| SCALE   | 1:   | CHECKED     |                   |
| ALL DIMENSIONS ARE IN mm, UNLESS OTHERWISE SPECIFIED REMOVE ALL THE SHARP CORNERS |  | APPROVED    |                   |
| JINDAL ALUMINIUM LTD.   |  | DRAWING NO. | MF-10-42-A4       |
| BANGALORE-560073  |  |             |                   |



HARDEN TO 28-30 HRC.

Nos. of Teeth = 38.

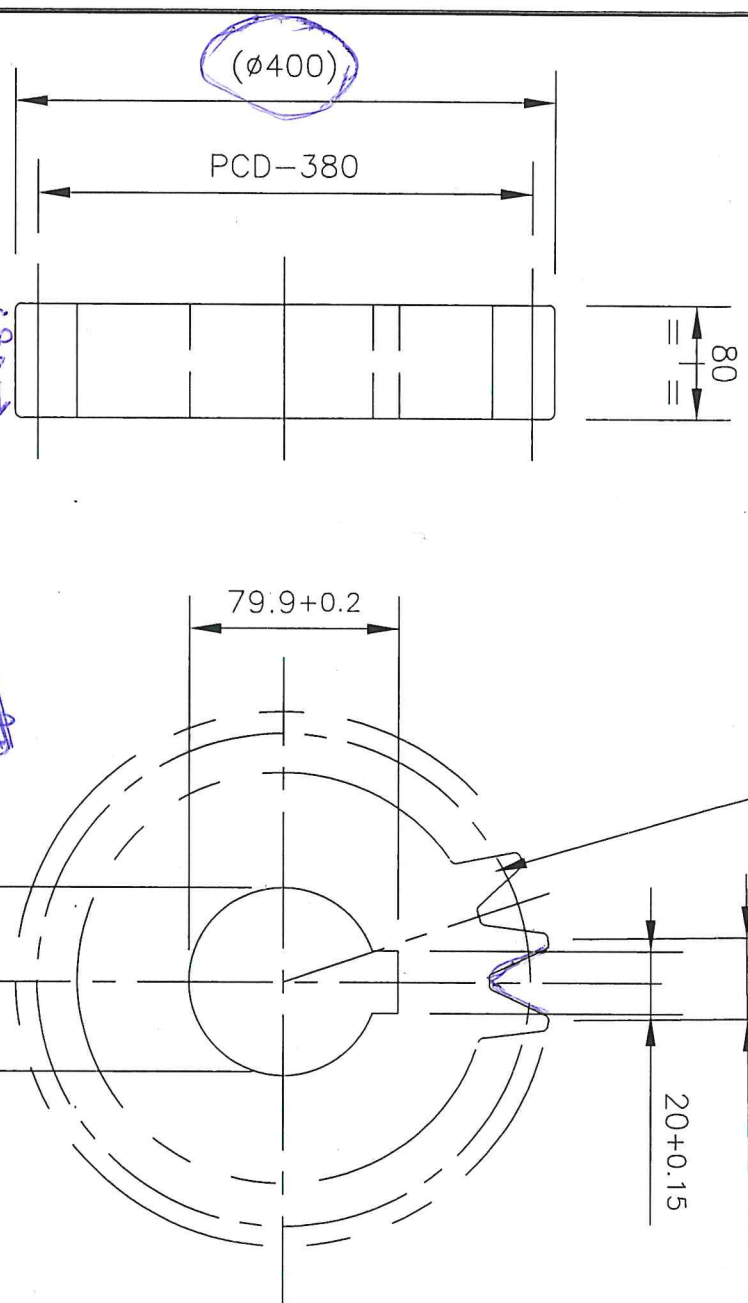

SPUR GEAR DATA

| Sl.No | Description           | DATA           |
|-------|-----------------------|----------------|
| 1     | Nos. of Teeth on Gear | $z = 38$       |
| 2     | Module                | $m = 10$       |
| 3     | Pressure angle        | $Q = 20^\circ$ |
| 4     | Addendum              | $ha = 10$      |
| 5     | Dedendum              | $hf = 12.5$    |
| 6     | Tip Clearance         | $c = 2.5$      |
| 7     | Total tooth height    | $h = 22.5$     |
| 8     | Pitch Diameter        | $d = 380$      |
| 9     | Outside Diameter      | $da = 400$     |
| 10    | Pitch                 | $p = 31.42$    |

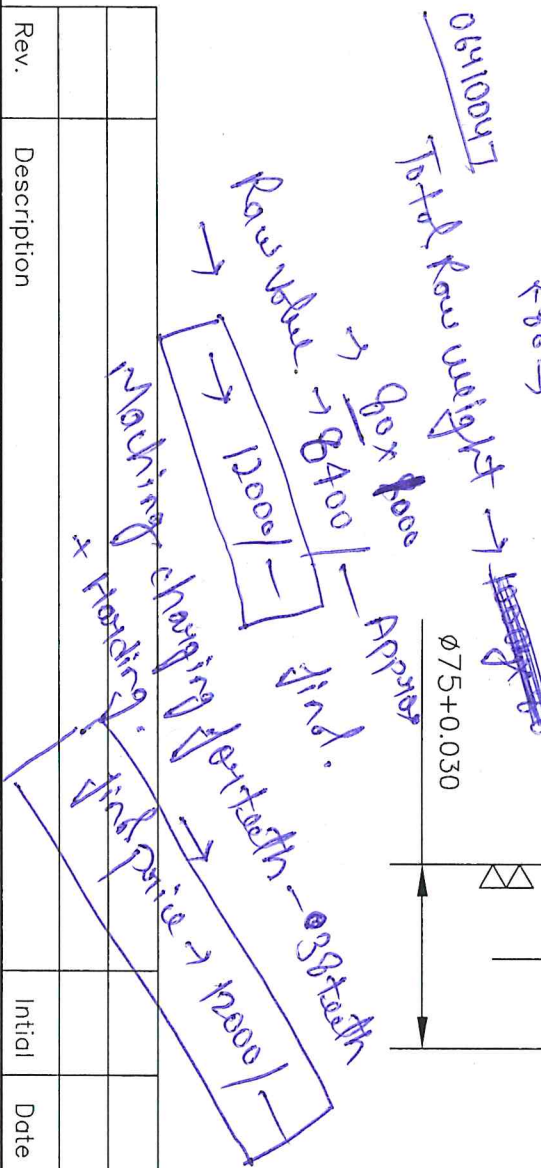

| PART NO.   | 10   | QUANTITY    | 1                 |
|--|--|-------------|-------------------|
| PART NAME  | SPUR GEAR  | MATERIAL    | C45 [EN8]         |
| SUB ASSY.  | DRIVE ARRANGEMENT OF INGOT CHARGING MACHINE. DWG. NO.: MF-10-09-A1 | BLANK SIZE  | -                 |
| MAIN ASSY. TITLE   |  | DRAWN       | C.ARUL 04.05.2001 |
| INGOT CHARGING MACHINE.  |  | CHECKED     |                   |
| ALL DIMENSIONS ARE IN mm., UNLESS OTHERWISE SPECIFIED REMOVE ALL THE SHARP CORNERS |  | APPROVED    |                   |
| SCALE 1:   |  | DRAWING NO. | MF-10-41-A4       |
| JINDAL ALUMINIUM LTD. BANGALORE-560073   |  |             |                   |

| Rev. | Description | Initial | Date |
|------|-------------|---------|------|
|      |             |         |      |