

*PROPOSAL DRAWING  
Q01596*

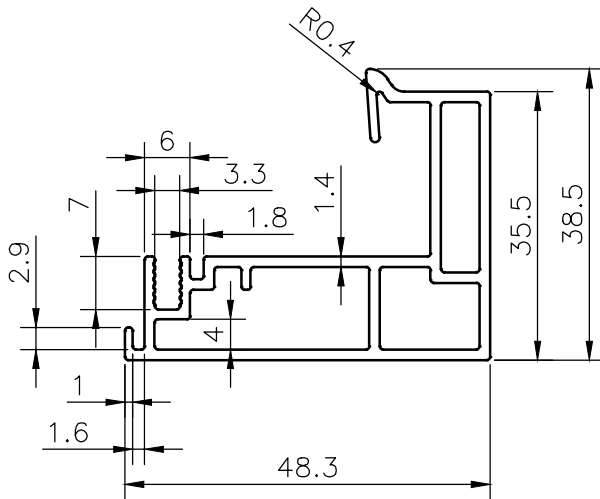

Area:291.505 Sq.mm. | Perimeter:224.293 mm. | Weight:0.787 Kg./mtr.

*PROPOSAL DRAWING  
Q01597*

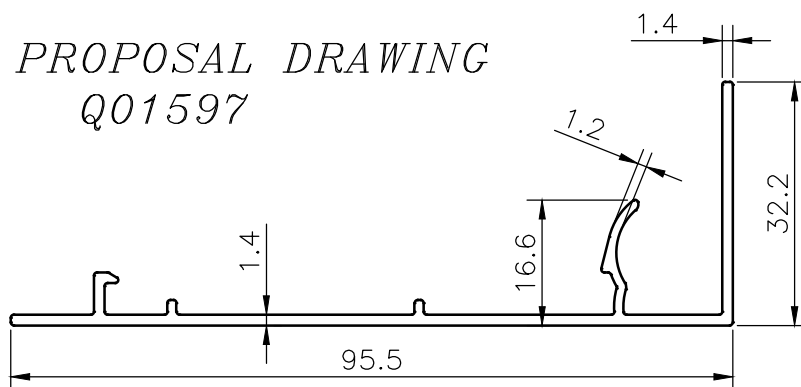

Area:212.691 Sq.mm. | Perimeter:306.84mm. | Weight:00.574 Kg./mtr.