

Date	DML N°	Ver	Modification	Request N°	E	Drawer

Classification of characteristics:
● Critical
▲ Key Instruction
○ Major,

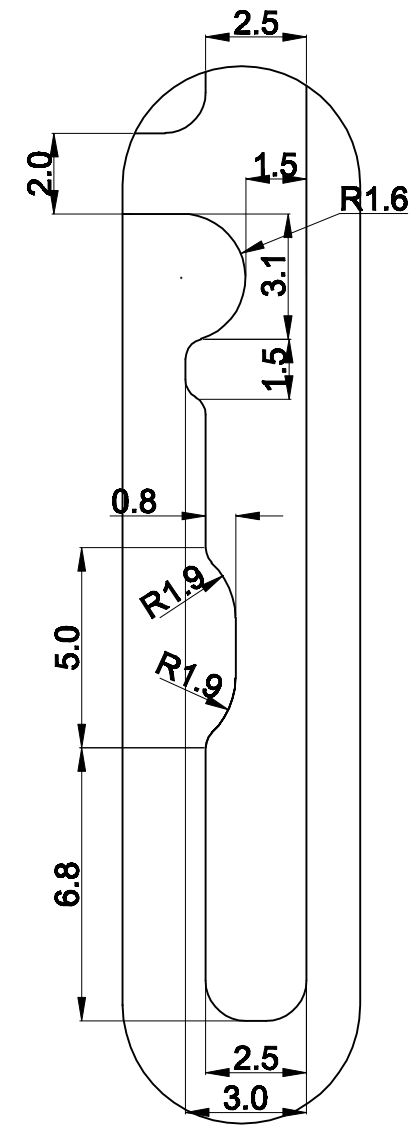

DETAIL "B"

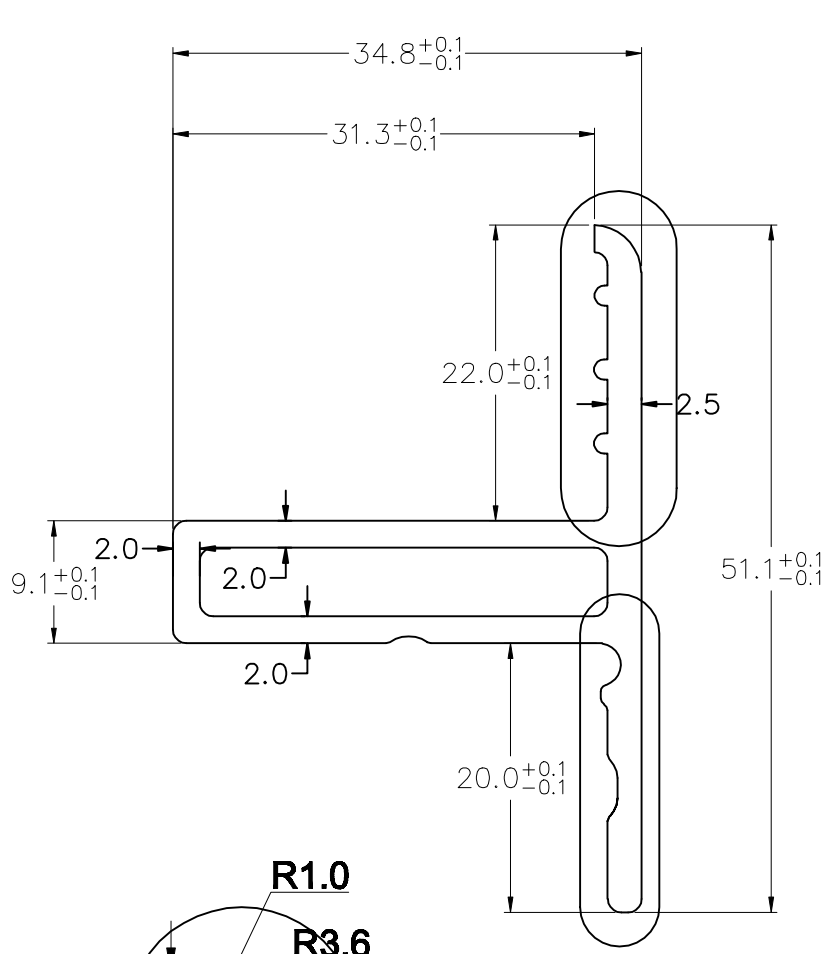
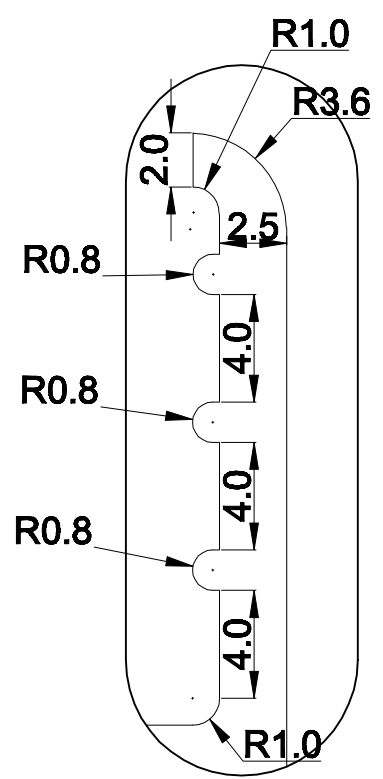

DETAIL "A"

MATERIAL: ALUMINIUM, ACCORDING TO EME 032/99
ALLOY: ABNT 6063 T6F (TEMPERED)
RADIUS: R=1mm & r=0.5mm
WEIGHT: 0.72 Kg/M
LENGTH: 6 Meter

UN specified, tolerances will be in accordance with
DIN ISO 2768-1 class f = fine

Dimension	0.5 - 3	3 - 6	6 - 30	30 - 120	120 - 400	400 - 1000	1000 - 2000	2000 - 4000
Longitudinal	+0.05	+0.1	+0.15	+0.2	+0.3	+0.5	+0.5	-
Chamber & Radius	±0.2	±0.5	±1	±1	±1	±1	±1	±0.5
Degree	Upto 10	10 - 50	50 - 120	120 - 400	above 400			
Minute	±1	±0.30	±0.20	±0.10	±0.05			



Scale: 1:1	Date: 02.06.10	Description: DRIVER DOOR WINDOW ALUMINIUM PROFILE TOP FRAME PROFILE	
View System:	Liquid weight (Kg):		
Origin:			
Product/Group: LCV	Surface Treatment: BLACK EPOXI COATING	Marcopolo P/N: NA	

Drawer: Mr. SHRINIVAS	Reviser: Mr. JOAO	Approved: Mr. SHIV	Use: LCV WINDOWS	TMMML Part Number: 9140 0204 2125
				Computer Aided Design

TML P/NO-4090 8800 2287