

Date	DML N°	Ver	Modification	Request No	E	Drawer

Classification of characteristics:
 ● Critical
 ▲ Key Instruction
 ● Major,

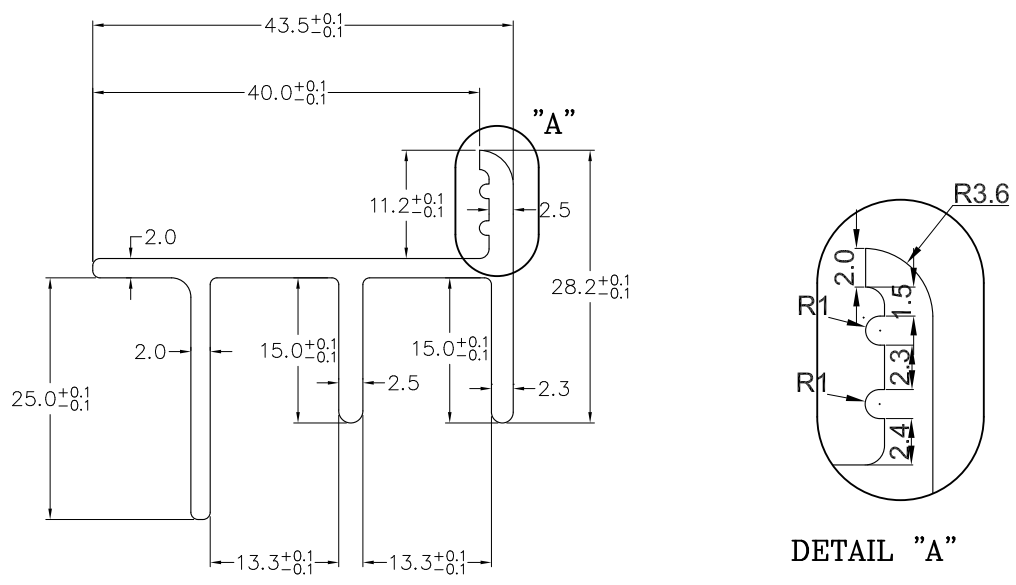

DETAIL "A"

UN specified, tolerances will be in accordance with
 DIN ISO 2768-1 class f = fine

Dimension	0.5 - 3	3 - 6	6 - 30	30 - 120	120 - 400	400 - 1000	1000 - 2000	2000 - 4000
Longitudinal	±0.05	±0.05	±0.1	±0.15	±0.2	±0.3	±0.5	-
Chamfer & Radius	0.5 - 3	3 - 6	6 - 30	30 Degree	Upto 10	10 - 50	50 - 120	above 400
	±0.2	±0.5	±1	±1'	±0.30'	±0.20'	±0.10'	±0.5'

MATERIAL: ALUMINIUM, ACCORDING TO EME 032/99
 ALLOY: ABNT 6063 T6F (TEMPERED)
 RADIUS: R=1mm & r=0.5mm
 WEIGHT: 0.64 Kg/M
 LENGTH: 6 Meter

	Scale: 1:1	Date: 02.06.10	Description: WINDOW ALUMINIUM PROFILE SIDE PROFILE_CURVED TYPE_Dri OPE & Co-Dri WINDOW	
	View System:	Liquid weight (Kg):	Origin:	
Product/Group: LCV	Surface Treatment: BLACK EPOXI COATING	Marcopolo P/N: NA		
Drawer: Mr. SHRINIVAS	Reviser: Mr. SIDDU	Approved: Mr. SHIV	Use: LCV WINDOWS	TMML Part Number: 9140 0204 2123

01 UN

Computer Aided Design

TML P/NO-4090 8800 2411