

minimum corner radius will be 0.30mm

19-04-2024
ALLOY-6063 T6

Area:1309.604 Sq.mm. | Perimeter:430.52mm. | Weight:3.536 Kg./mtr.

Q01709

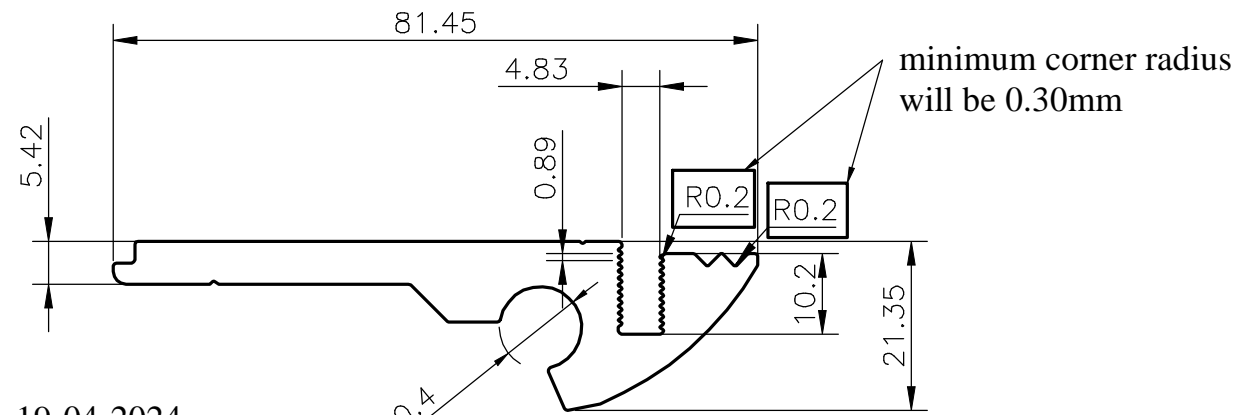

minimum corner radius will be 0.30mm

19-04-2024
ALLOY-6063 T6

Area:628.465 Sq.mm. | Perimeter:233.2mm. | Weight:1.697 Kg./mtr.

ASSEMBLY
SCALE 1:1

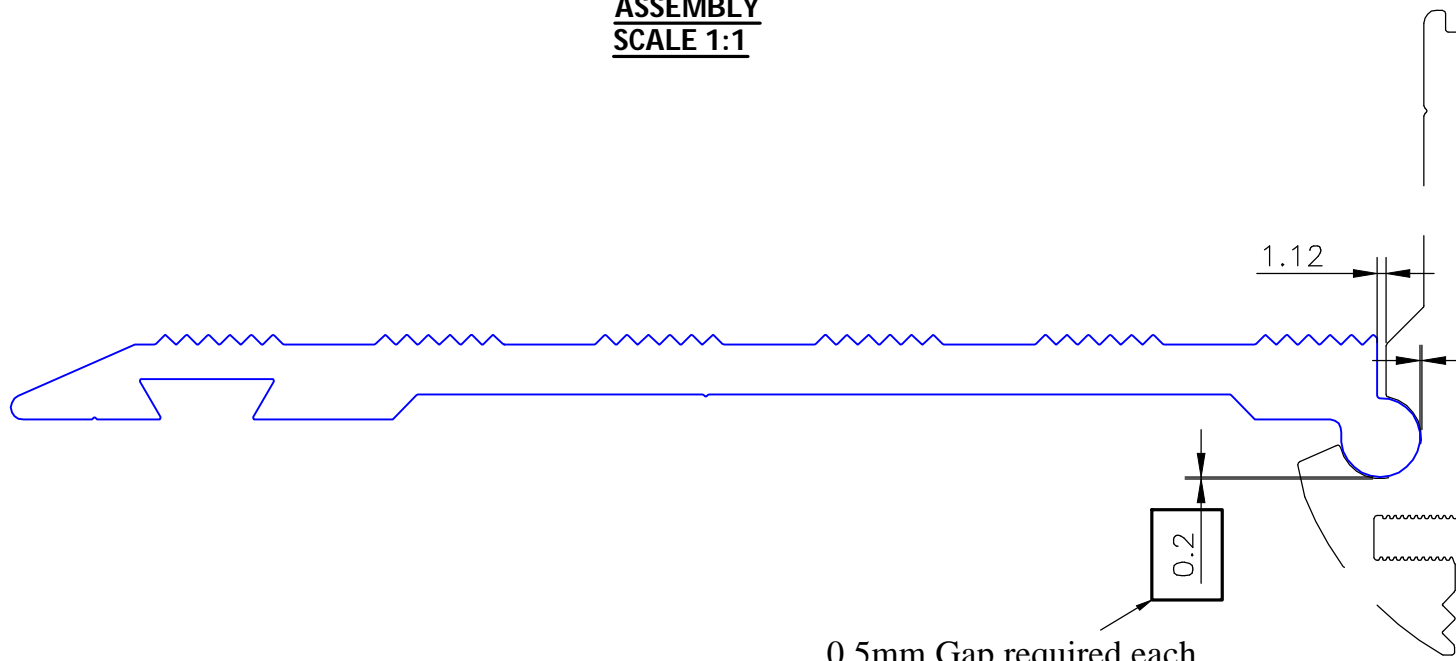

0.5mm Gap required each side

1. KINDLY CONFIRM ASSEMBLY LENGTH FROM THE CUSTOMER

0.5mm Gap required each side