

ENQUIRY NO./DATE : C-23-17 / 20-04-2017  
 CUSTOMER/CUSTOMER REF.NO: SILVER LINE / MULLION FI4XED  
 END USE:-

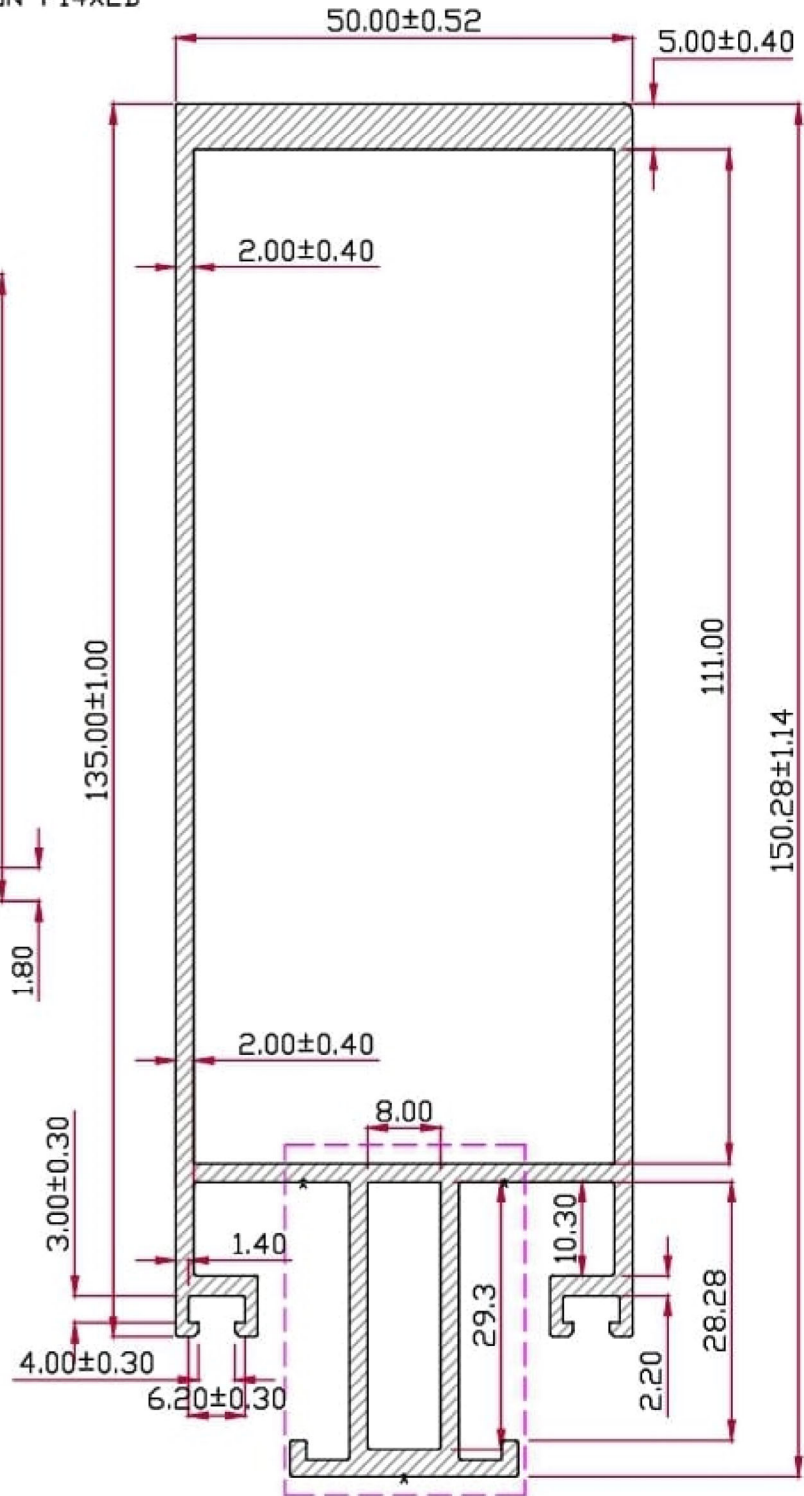
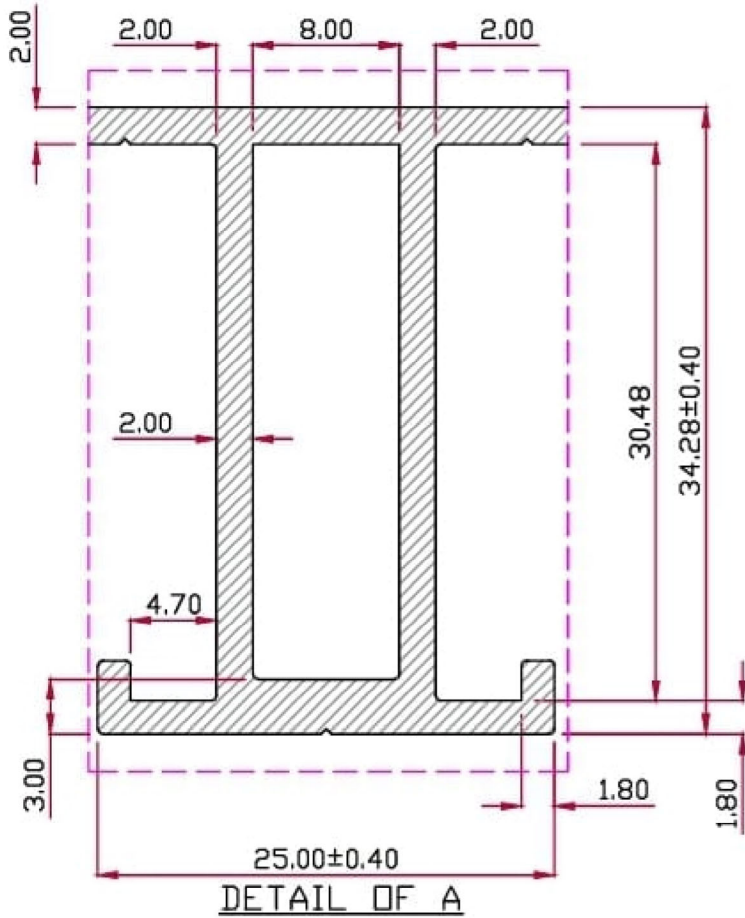

**S-9050**  
**2.944 kg/mtr**

V GROOVE=0.3x90°

- (1) ALL DIMENSIONS ARE IN MM.
- (2) ALL SHARP CORNERS REMOVED WITH 0.30 MM RADIUS
- (3) UNLESS OTHERWISE NOT SPECIFIED TOLERANCE IS:- IS:2673,IS:6477,IS:3965  
 NO WEIGHT RANGE WILL BE CONSIDERED. MATERIAL WILL BE SUPPLIED AS PER DIMENSION ONLY.
- (4) PLEASE MARK EXPOSED AREA DURING APPROVAL.
- (5) END SURFACE FINISH TO BE DONE AT CUSTOMER END: ANODIZING/POWDER COATING

REVISIONS:- -