

P-24549

-



SCALE:- 1:1

Q00211

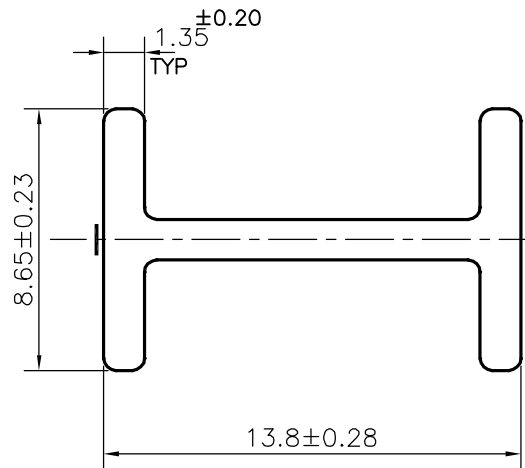

PLEASE NOTE:-

— DUE TO THICKNESS VARIATION
IMPRESSION MARK MAY APPEAR
IN THIS MARKED PORTION.

1. STRAIGHTNESS=1.7mm/M
2. TWIST=1.7mm/M
3. ANGULARITY= $\pm 2^\circ$
4. FLATNESS =0.007xWIDTH

1) THE WELDING LINE IN THE EXPOSED SURFACE OF PROFILE IS UNAVOIDABLE. 2) PLEASE SPECIFY IMPORTANT SIZES.
3) PLEASE SPECIFY IF THIS PROFILE MATCHES WITH OTHER PROFILES. 4) PLEASE SPECIFY EXPOSED SURFACE. OTHER
WISE CONSIDERED AS NO EXPOSED SURFACE. 5) FINISH :- MILL FINISH / ANODIZING / POWDER COATING



SYMBOL OF QUALITY
AN ISO 9001 COMPANY

JINDAL ALUMINIUM LTD.
BANGALORE-560073 (INDIA)

	NAME	DATE
DRAWN	J.P.KAUSHIK	26-10-2022
CHECKED		
APPROVED		

1. ALL DIMENSIONS ARE IN mm.
2. ROUND OFF ALL SHARP CORNERS WITH 0.40 mm.
3. TOLERANCES WILL BE AS PER IS:3965-1981, UNLESS OTHERWISE SPECIFIED

SCALE	4:1
AREA mm ²	38.203
PERIMETER mm.	57.44
WEIGHT kg/m	0.103

PARTY'S NAME	ALUMINIUM TRADING COMPANY, NEW DELHI		DRAWING No.	SECTION No.
PARTY'S DRAWING No.	AS PER SAMPLE		P-24549	-
ALLOY & TEMPER	6063 T6	PRODUCT CODE:-056	-	-
		HSN CODE:-76042990		
DESCRIPTION	ARCHITECTURAL SECTION			