

6

5

4

3

2

1

D

D

C

C

B

B

A

A

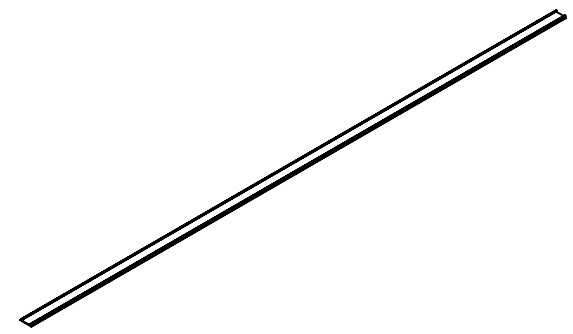
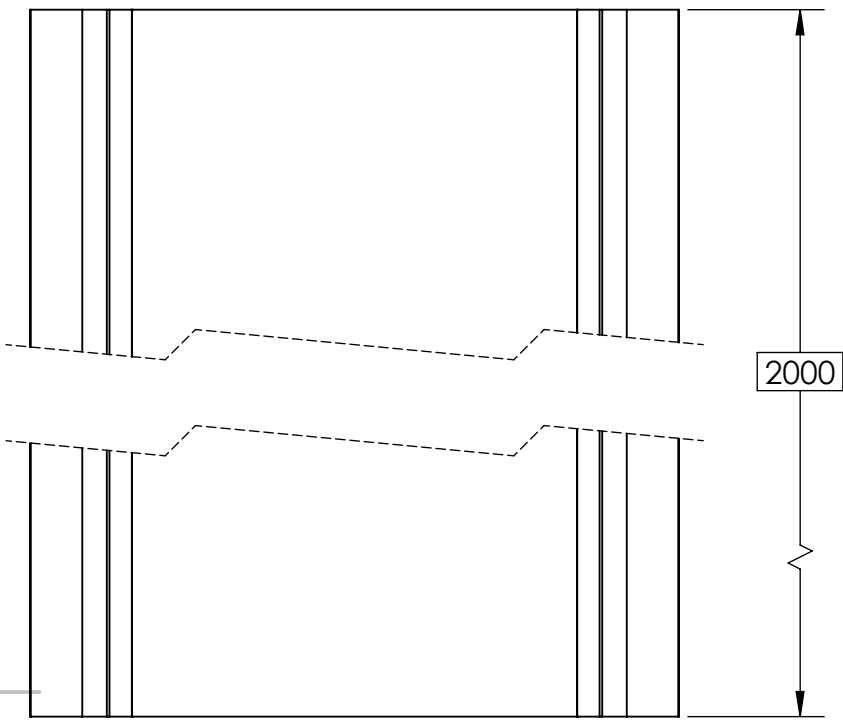

**Notes:**

1. Refer DXF file for detailed design and Dimensions.
2. Tolerances shown must be strictly adhered to.
3. Unspecified Radius shall be 0.20 mm.
4. Aluminium shall be IS:733 (latest) and of grade 6063, Temper Hardness-T6.
5. Profile shall be Anodized (Type-II Clear Anodizing)
6. Length shall be strictly 2000 mm.
7. No sharp Edges or Burr shall be there after profile cutting process.
8. Profile shall be Straight/Flat throughout the length without any unnecessary Bends/Twist or deflections.\*\*
9. Profiles shall be packed suitably to avoid any transit damages.

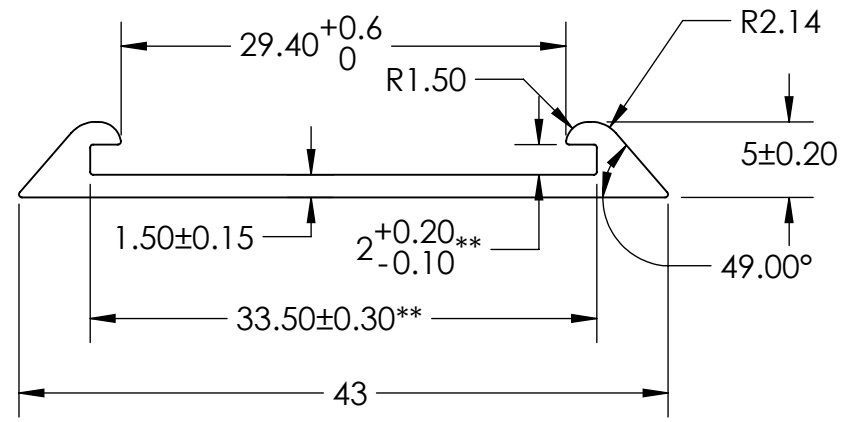

The Information contained in this drawing is the intellectual property of UPTech and should not in any way divulged to any third party without the prior written consent of the company

UNLESS OTHERWISE SPECIFIED:  
DIMENSIONS ARE IN MILLIMETERS

SURFACE FINISH LIMIT:  $\sqrt{0.6}$   
1.6

Deburr Sharp Edges\*\*

DIMENSIONS	Tolerance Dimension					
	0.5-3	>3-6	>6-30	>30-120	>120-400	>400-1000
ALL DIM. IN M.M.	±0.05	±0.05	±0.1	±0.15	±0.2	±0.3
* - IMPORTANT	±0.2	±0.5	±1	±1	±1	±1
** - CRITICAL	<±10	>±10-50	>±50-120	>±120-400	>±400	
*** - MOST CRITICAL	±1*	>±3*	>±5*	>±1*	>±5*	

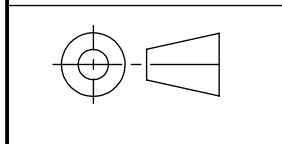

DRAWN BY	:DS	MATERIAL	6063-T6
DATE	:21-11-2022	SURFACE AREA	207446.66 mm <sup>2</sup>
CHECKED BY	:JK	VOLUME	165746.38mm <sup>3</sup>
DATE	:21-11-2022	Surface Treatment	:Anodizing
APPROVED BY	:JK	FINISH	:Extrusion
DATE	:21-11-2022	<b>PART NO.</b>	<b>UT-IS.01</b>
REVISION	:A		

Density	0.00 g/mm <sup>3</sup>
Drawing Weight	447.52 g
Actual Weight(g)	g

**TITLE** Aluminium Extrusion UT-IS

6

5

4

3

2

1