

P-JAL-B-557-1
 -
 -

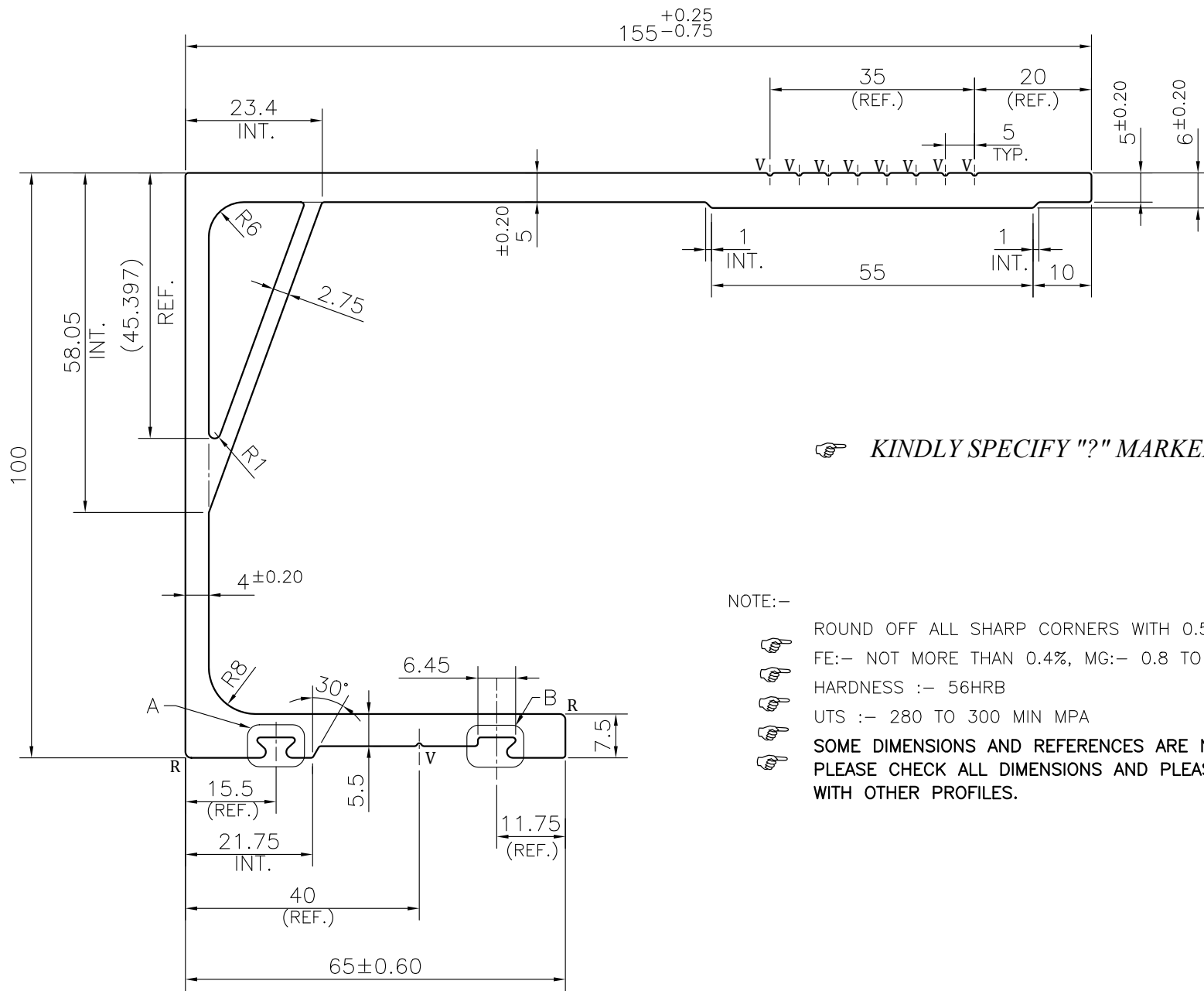

KINDLY SPECIFY "?" MARKED DIMENSIONS

NOTE:-
 ROUND OFF ALL SHARP CORNERS WITH 0.50 mm.
 FE:- NOT MORE THAN 0.4%, MG:- 0.8 TO 1.2%
 HARDNESS :- 56HRB
 UTS :- 280 TO 300 MIN MPA
 SOME DIMENSIONS AND REFERENCES ARE NOT SPECIFIED IN CUSTOMER DRAWING
 PLEASE CHECK ALL DIMENSIONS AND PLEASE SPECIFY IF THIS PROFILE MATCHES
 WITH OTHER PROFILES.



05 June 2024

NOTE:-
R= 1.0 RADIUS (5 PLACES)
V= 0.5x60° V-GROOVE (9 PLACES)

1. STRAIGHTNESS= 1.0mm/M
2. TWIST= 1.0mm/M
3. ANGULARITY= ±1°
4. FLATNESS= ±0.45mm

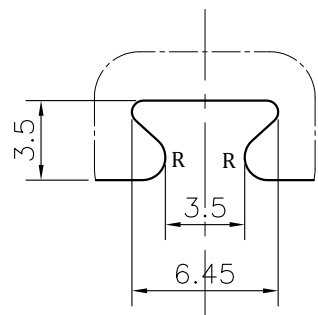

DETAIL A
SCALE 3:1

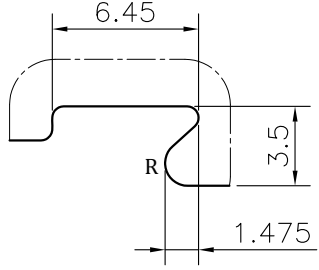

DETAIL B
SCALE 3:1

UNCONTROLLED COPY

1) THE WELDING LINE IN THE EXPOSED SURFACE OF PROFILE IS UNAVOIDABLE. 2) PLEASE SPECIFY IMPORTANT SIZES. 3) PLEASE SPECIFY IF THIS PROFILE MATCHES WITH OTHER PROFILES. 4) PLEASE SPECIFY EXPOSED SURFACE. OTHERWISE CONSIDERED AS NO EXPOSED SURFACE. 5) FINISH :- MILL FINISH / ANODIZING / POWDER COATING

 SYMBOL OF QUALITY AN ISO 9001 COMPANY	JINDAL ALUMINIUM LTD. BHIWADI-301019 (INDIA)		NAME	DATE
			DRAWN	ASHUTOSH 01-06-2024
1. ALL DIMENSIONS ARE IN mm. 2. ROUND OFF ALL SHARP CORNERS WITH 0.50 mm. 3. TOLERANCES WILL BE AS PER EN 12020-2, UNLESS OTHERWISE SPECIFIED			SCALE	1:1
			AREA mm ²	1742.11
			PERIMETER mm.	631.832
			WEIGHT kg/m	4.704
PARTY'S NAME	KNEST MANUFACTURERS LLP, PUNE		DRAWING No.	SECTION No.
PARTY'S DRAWING No.	AS PER DRAWING		P-JAL-B-557-1	-
ALLOY & TEMPER	6061 T6	PRODUCT CODE:-029	-	-
		HSN CODE:- 76042100		
DESCRIPTION	FORM WORK SECTION- J PROFILE 60 TO 90			