

P-JAL-B-585-1

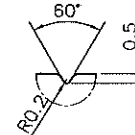
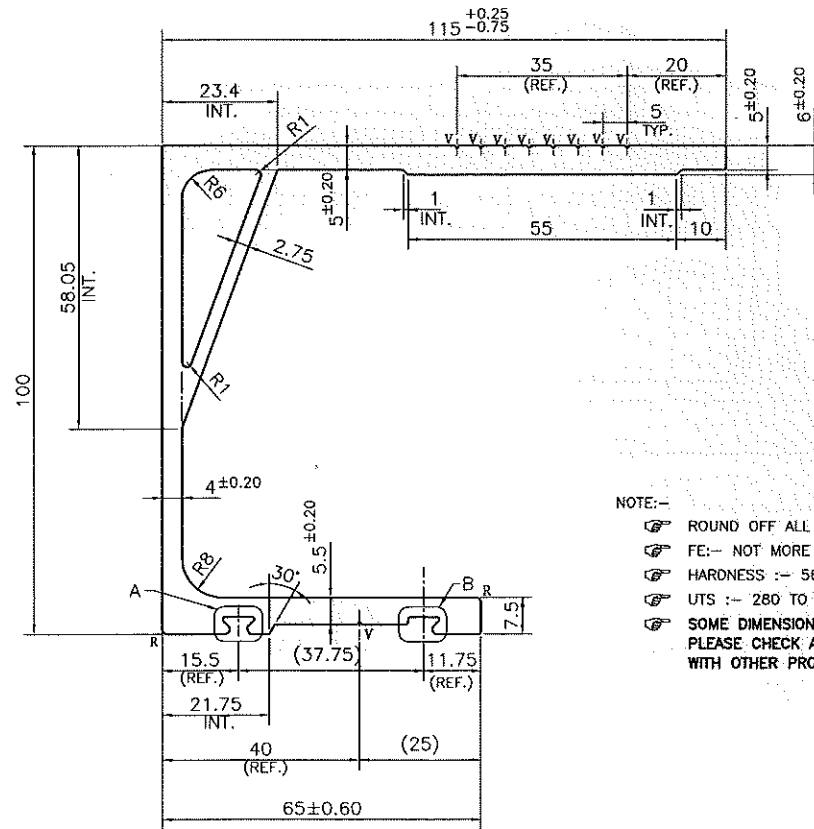

DETAIL V
SCALE 4:1

NOTE:-

- ☞ ROUND OFF ALL SHARP CORNERS WITH 0.50 mm.
- ☞ FE:- NOT MORE THAN 0.4%, MG:- 0.8 TO 1.2%
- ☞ HARDNESS :- 56HRB
- ☞ UTS :- 280 TO 300 MIN MPA
- ☞ SOME DIMENSIONS AND REFERENCES ARE DIFFERENT IN CAD & PDF DRAWING PLEASE CHECK ALL DIMENSIONS AND PLEASE SPECIFY IF THIS PROFILE MATCHES WITH OTHER PROFILES.



14 June 2024

NOTE:-

- R= 1.0 RADIUS (5 PLACES)
- V= 0.5x60° V-GROOVE (9 PLACES)

1. STRAIGHTNESS= 1.0mm/M
2. TWIST= 1.0mm/M
3. ANGULARITY= ±1°
4. FLATNESS= ±0.45mm

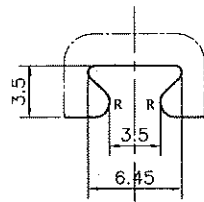

DETAIL A
SCALE 3:1

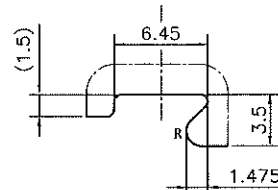

DETAIL B
SCALE 3:1

115x100 x4

Q01987

UNCONTROLLED COPY

- 1) THE WELDING LINE IN THE EXPOSED SURFACE OF PROFILE IS UNAVOIDABLE. 2) PLEASE SPECIFY IMPORTANT SIZES.
- 3) PLEASE SPECIFY IF THIS PROFILE MATCHES WITH OTHER PROFILES. 4) PLEASE SPECIFY EXPOSED SURFACE. OTHER WISE CONSIDERED AS NO EXPOSED SURFACE. 5) FINISH :- MILL FINISH / ANODIZING / POWDER COATING

 SYMBOL OF QUALITY AN ISO 9001 COMPANY	JINDAL ALUMINIUM LTD. BHIWADI-301019 (INDIA)	NAME	DATE
		DRAWN	ASHUTOSH 11-06-2024
1. ALL DIMENSIONS ARE IN mm. 2. ROUND OFF ALL SHARP CORNERS WITH 0.50 mm. 3. TOLERANCES WILL BE AS PER EN 12020-2, UNLESS OTHERWISE SPECIFIED		CHECKED	
PARTY'S NAME		APPROVED	
KNEST MANUFACTURERS LLP, PUNE		SCALE	1:1
PARTY'S DRAWING No.		AREA mm ²	1543.473
AS PER DRAWING		PERIMETER mm.	552.413
ALLOY & TEMPER		WEIGHT kg/m	4.167
6061 T6		DRAWING No.	SECTION No.
PRODUCT CODE:-029		P-JAL-B-585-1	--
HSN CODE:- 76042100			
DESCRIPTION			
FORM WORK SECTION- J PROFILE 20 TO 50			