

PRODUCT SPECIFICATIONS

Door Main Profile

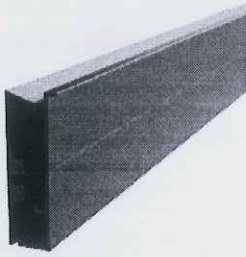

Brushed Stainless Steel



Brushed Black

Q02002

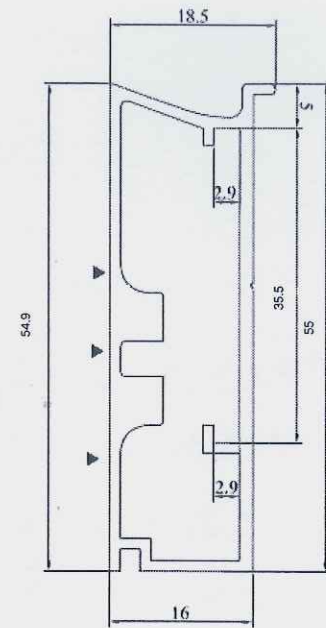

| | | |
|-------------------------------|--|---------------|
| Finish | Brushed Stainless Steel | Brushed Black |
| Material | Aluminium | |
| Length | 3000 mm | |
| Decorative Material Thickness | 3 – 6 mm (Up to 4 mm for glass and stone) | |
| Back Panel Thickness | 2 mm (Material Recommended: Aluminium Composite Sh | |

PRODUCT SPECIFICATIONS

Door Handle Profile



Brushed Stainless Steel

Q02003

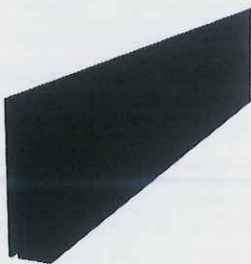

Brushed Black

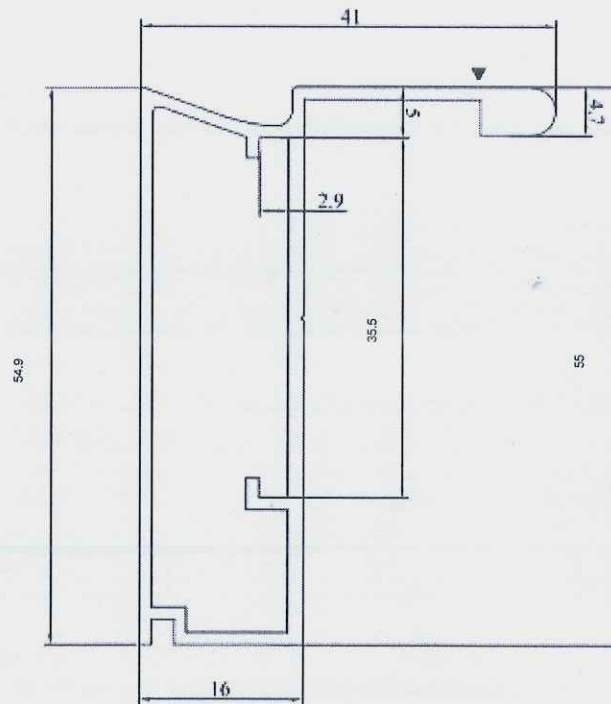

| | | | | | | |
|-------------------------------|--|--------|---------|---------|---------|---------|
| Material | Aluminium | | | | | |
| Length | 200 mm | 500 mm | 1000 mm | 1800 mm | 3200 mm | 3200 mm |
| Handle Length | 100 mm | 200 mm | 500 mm | 1000 mm | 1200 mm | 1200 mm |
| Decorative Material Thickness | 3 – 6 mm (Up to 4 mm for glass and stone) | | | | | |
| Back Panel Thickness | 2 mm (Material Recommended: Aluminium Composite Sheet) | | | | | |
| Application | Handle side of the shutter frame | | | | | |