

DRAWING FOR APPROVAL

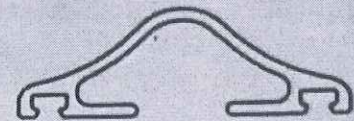
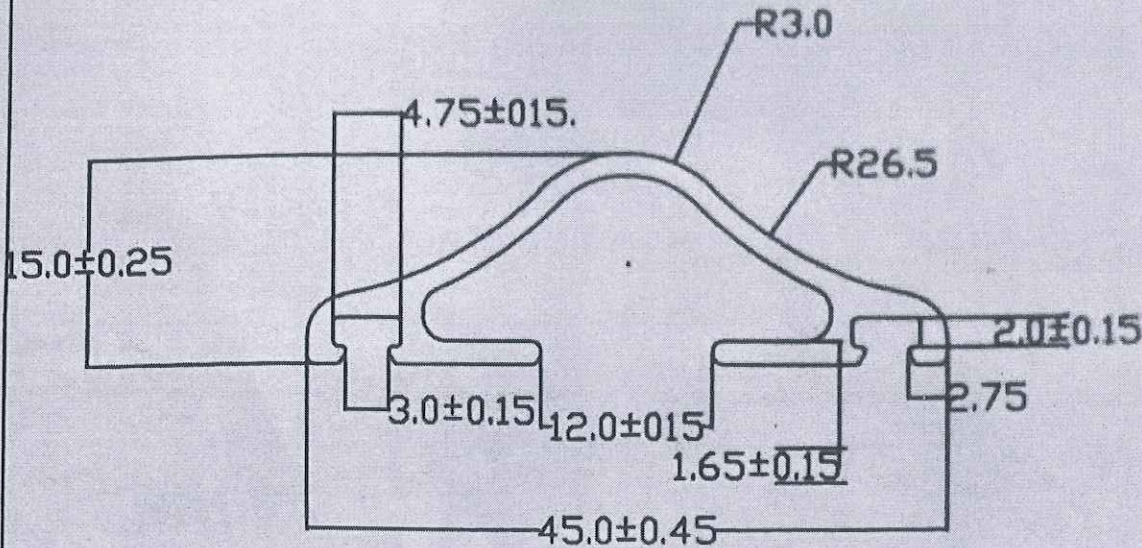

SCALE 1:1

NOTES:-

- 1) WALL THICKNESS IS TO BE 1.65 mm. UNLESS OTHERWISE SPECIFIED.
- 2) ALL CORNERS MAY BE 0.30 RADIUS.
- 3) CROSS SECTION AREA 154.85 mm.
- 4) PERIMETER : 158.85 mm.
- 5) WT./15' : 1.900 Kg
- 6) WT./METER -0.418 Kg
- 7) UNSPECIFIED TOLERANCES ±0.20

Q02019

1ST REVISION									
DIE O.D.:-		DIE PLATE :-		BAKER :-		POCKET DEEP:-		APPROVED:-	
ALL DIM ARE IN MM		CRITICAL DIM*		DRAWN:-DEEPAK SINGH		CHECKED BY:-DEEPAK SINGH		DATE:25-02-2017	
UNSPECIFIED CORNER RADIUS-0.25				UNSPECIFIED TOLERANCES ±0.2				SCALE :- 1:1	
CONTAINER	PERIMETER	AREA	WEIGHT	QNTY	EXT.RATIO	BACKER	BOLSTER	STRAIGHTNESS	
NISHA METALS A-163 RICO INDUSTRIAL AREA EXTENSION BAGRU PHASE-2 JNPUR(RAJ.)				PARTY :-		REF.DRAWING	ALLOY	HARNESS	
				TITLE :					