

FORMAT NO:	PDWPL/FRM/DWG/AED/R0
MOC:	AL 6063
GRADE:	T6
CCD:	
AREA:	
PERIMETER:	
WEIGHT/M	
FINISH	MILL
STD. SIZE	5800 MM

ASSEMBLY:

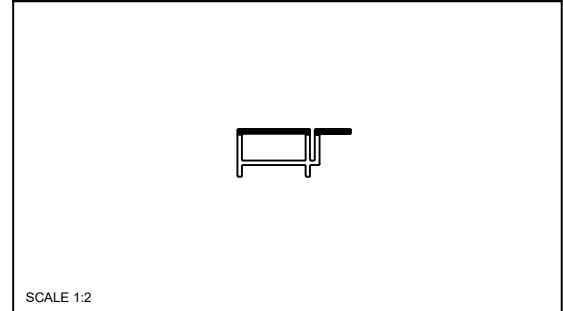
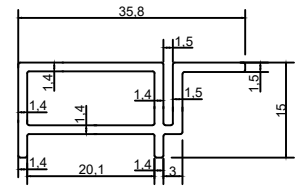

SCALE 1:2

NOTE:

1. ALL DIMENSIONS IN MM UNLESS SPECIFIED
2. UNSPECIFIED RADII : 0.3MM
3. TOLERANCES AS PER DIN EN 12220-2 : 2008 UNLESS SPECIFIED
4. CRITICAL DIMENSIONS ENCIRCLED

EXPOSED SURFACE	
HIDDEN SURFACE	
SEMI-EXPOSED SURFACE	

REV. NO.	REV. DATE	REMARKS
R0	20/01/2022	ORIGINAL DRAWING

DESCRIPTION:	SECURITY MESH CLIP	SCALE:	1:1	SIGN/STAMP
PART CODE:	PF0075	STATUS:	FOR FEASIBILITY	
DRAWN BY:	MONI	REVISION NO:	R0	
CHECKED BY:	-	DRAWING NO:	PDWPL/DWG/AED/0075	
APPROVED BY:	-	DATE:	20/01/2022	



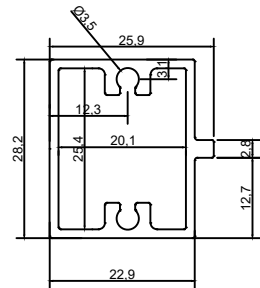

FORMAT NO: PDWPL/FRM/DWG/AED/R0

MOC:	AL 6063
GRADE:	T6
CCD:	
AREA:	
PERIMETER:	
WEIGHT/M	
FINISH	MILL
STD. SIZE	5800 MM

ASSEMBLY:



SCALE 1:2

NOTE:

1. ALL DIMENSIONS IN MM UNLESS SPECIFIED
2. UNSPECIFIED RADII : 0.3MM
3. TOLERANCES AS PER DIN EN 12220-2 : 2008 UNLESS SPECIFIED
4. CRITICAL DIMENSIONS ENCIRCLED

EXPOSED SURFACE	
HIDDEN SURFACE	
SEMI-EXPOSED SURFACE	

REV. NO.	REV. DATE	REMARKS
R0	20/01/2022	ORIGINAL DRAWING



DESCRIPTION:	SECURITY MESH MIDRAIL	SCALE:	1:1	SIGN/STAMP
PART CODE:	PF0077	STATUS:	FOR FEASIBILITY	
DRAWN BY:	MONI	REVISION NO:	R0	
CHECKED BY:	-	DRAWING NO:	PDWPL/DWG/AED/0076	
APPROVED BY:	-	DATE:	20/01/2022	

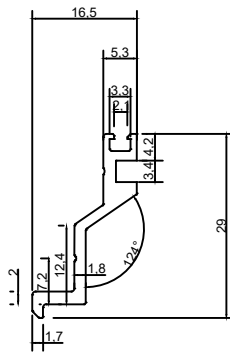

FORMAT NO: PDWPL/FRM/DWG/AED/R0

MOC:	AL 6063
GRADE:	T6
CCD:	
AREA:	
PERIMETER:	
WEIGHT/M	
FINISH	MILL
STD. SIZE	5800 MM

ASSEMBLY:

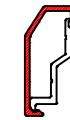

SCALE 1:2

NOTE:

1. ALL DIMENSIONS IN MM UNLESS SPECIFIED
2. UNSPECIFIED RADII : 0.3MM
3. TOLERANCES AS PER DIN EN 12220-2 : 2008 UNLESS SPECIFIED
4. CRITICAL DIMENSIONS ENCIRCLED

EXPOSED SURFACE	
HIDDEN SURFACE	
SEMI-EXPOSED SURFACE	

REV. NO.	REV. DATE	REMARKS
R0	20/01/2022	ORIGINAL DRAWING



DESCRIPTION:	DRAINAGE COVER ADAPTER	SCALE:	1:1	SIGN/STAMP
PART CODE:	PF0078	STATUS:	FOR FEASIBILITY	
DRAWN BY:	MONI	REVISION NO:	R0	
CHECKED BY:	-	DRAWING NO:	PDWPL/DWG/AED/0078	
APPROVED BY:	-	DATE:	20/01/2022	

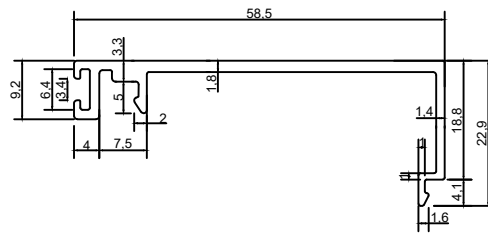

FORMAT NO: PDWPL/FRM/DWG/AED/R0

MOC:	AL 6063
GRADE:	T6
CCD:	
AREA:	
PERIMETER:	
WEIGHT/M	
FINISH	MILL
STD. SIZE	5800 MM

ASSEMBLY:

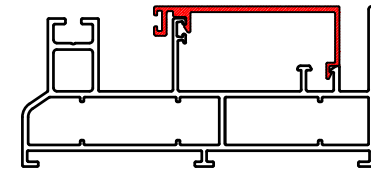

SCALE 1:2

NOTE:

1. ALL DIMENSIONS IN MM UNLESS SPECIFIED
2. UNSPECIFIED RADII : 0.3MM
3. TOLERANCES AS PER DIN EN 122020-2 : 2008 UNLESS SPECIFIED
4. CRITICAL DIMENSIONS ENCIRCLED

EXPOSED SURFACE	
HIDDEN SURFACE	
SEMI-EXPOSED SURFACE	

REV. NO.	REV. DATE	REMARKS
R0	20/01/2022	ORIGINAL DRAWING



DESCRIPTION:	MONORAIL COVER	SCALE:	1:1	SIGN/STAMP
PART CODE:	PF0080	STATUS:	FOR FEASIBILITY	
DRAWN BY:	MONI	REVISION NO:	R0	
CHECKED BY:	-	DRAWING NO:	PDWPL/DWG/AED/0080	
APPROVED BY:	-	DATE:	20/01/2022	

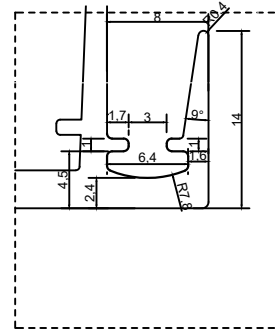
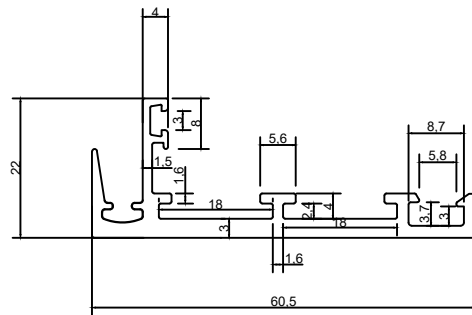

FORMAT NO: PDWPL/FRM/DWG/AED/R0

MOC:	AL 6063
GRADE:	T6
CCD:	
AREA:	
PERIMETER:	
WEIGHT/M	
FINISH	MILL
STD. SIZE	5800 MM

ASSEMBLY:



SCALE 1:2

NOTE:

1. ALL DIMENSIONS IN MM UNLESS SPECIFIED
2. UNSPECIFIED RADII : 0.3MM
3. TOLERANCES AS PER DIN EN 122020-2 : 2008 UNLESS SPECIFIED
4. CRITICAL DIMENSIONS ENCIRCLED

EXPOSED SURFACE	
HIDDEN SURFACE	
SEMI-EXPOSED SURFACE	

REV. NO.	REV. DATE	REMARKS
R0	20/01/2022	ORIGINAL DRAWING



DESCRIPTION:	MONORAIL MIDRAIL	SCALE:	1:1	SIGN/STAMP
PART CODE:	PF0081	STATUS:	FOR FEASIBILITY	
DRAWN BY:	MONI	REVISION NO:	R0	
CHECKED BY:	-	DRAWING NO:	PDWPL/DWG/AED/0081	
APPROVED BY:	-	DATE:	20/01/2022	

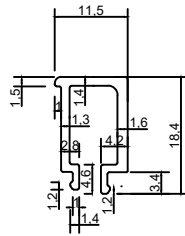

FORMAT NO: PDWPL/FRM/DWG/AED/R0

MOC:	AL 6063
GRADE:	T6
CCD:	
AREA:	
PERIMETER:	
WEIGHT/M	
FINISH	MILL
STD. SIZE	5800 MM

ASSEMBLY:

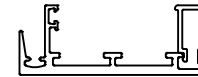

SCALE 1:2

NOTE:

1. ALL DIMENSIONS IN MM UNLESS SPECIFIED
2. UNSPECIFIED RADII : 0.3MM
3. TOLERANCES AS PER DIN EN 12220-2 : 2008 UNLESS SPECIFIED
4. CRITICAL DIMENSIONS ENCIRCLED

EXPOSED SURFACE	
HIDDEN SURFACE	
SEMI-EXPOSED SURFACE	



DESCRIPTION:	MONORAIL BEAD	SCALE:	1:1
PART CODE:	PF0103	STATUS:	FOR FEASIBILITY
DRAWN BY:	MONI	REVISION NO:	R0
CHECKED BY:	-	DRAWING NO:	PDWPL/DWG/AED/0103
APPROVED BY:	-	DATE:	20/01/2022

SIGN/STAMP

REV. NO.	REV. DATE	REMARKS
R0	20/01/2022	ORIGINAL DRAWING

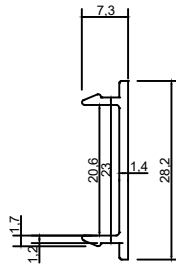

FORMAT NO:	PDWPL/FRM/DWG/AED/R0
MOC:	AL 6063
GRADE:	T6
CCD:	
AREA:	
PERIMETER:	
WEIGHT/M	
FINISH	MILL
STD. SIZE	5800 MM

ASSEMBLY:



SCALE 1:2

NOTE:

1. ALL DIMENSIONS IN MM UNLESS SPECIFIED
2. UNSPECIFIED RADII : 0.3MM
3. TOLERANCES AS PER DIN EN 12220-2 : 2008 UNLESS SPECIFIED
4. CRITICAL DIMENSIONS ENCIRCLED

EXPOSED SURFACE	
HIDDEN SURFACE	
SEMI-EXPOSED SURFACE	



DESCRIPTION:	SECURITY MESH MIDRAIL COVER	SCALE:	1:1	SIGN/STAMP
PART CODE:	PF0105	STATUS:	FOR FEASIBILITY	
DRAWN BY:	MONI	REVISION NO:	R0	
CHECKED BY:	-	DRAWING NO:	PDWPL/DWG/AED/0105	
APPROVED BY:	-	DATE:	20/01/2022	

REV. NO.	REV. DATE	REMARKS
R0	20/01/2022	ORIGINAL DRAWING