

DIE SIZE	NO. OF HOLES	MIN. CONT.	EXT. RATIO	ANGULARITY :-	CUSTOMER'S APPROVAL
				FLATNESS:- 0.007 MM/MM OF WIDTH	
				TWIST:- 1.0 MM/M	
				STRAIGHTNESS:- 1.0 MM/M	END USE :-
TYP. WALL THICKNESS UNLESS INDICATED OTHERWISE				MATCHING NO.	
TYP. RADIUS AT ALL CORNERS UNLESS INDICATED OTHERWISE				o SOLID o SEMI-HOLLOW o HOLLOW	

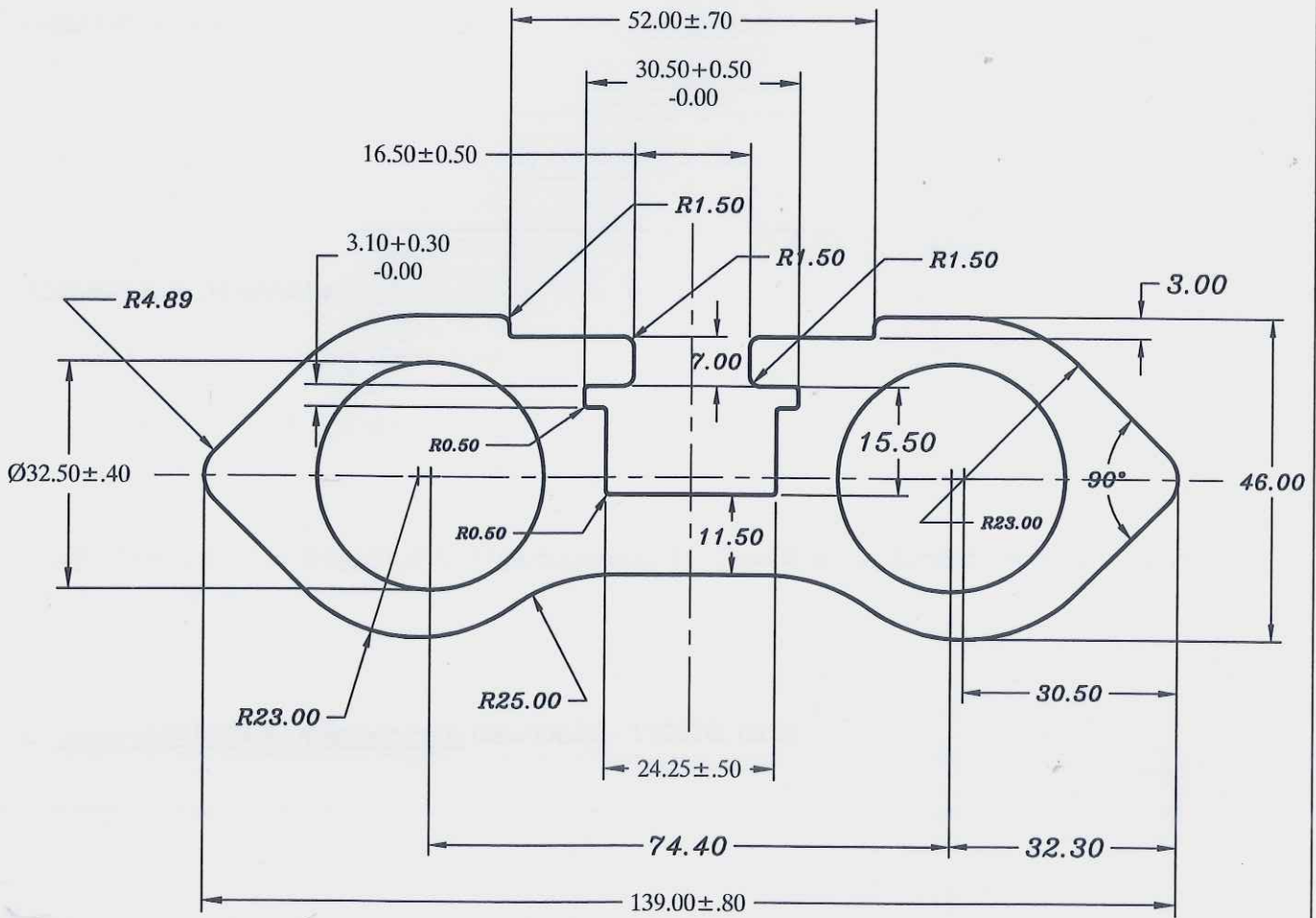

Q02049

REVISION	(1) SLOT OF 3.10 MM REVISED AS PER CUSTOMER SAMPLE ON DT-24/01/07 (MS)

HINDALCO INDUSTRIES LIMITED
 FABRICATION - EXTRUSION & DIESHOP
 P.O RENUKOOT, DIST SONEBHADRA, UP, INDIA
 FAX NO. 0091-5446-252107, 252427



AREA	Wt. (Kg/m)	PERIMETER	FACTOR	CCD	SCALE	DATE	DRAWN	CHECKED
2684.17	7.274	597.03	82	139	1:1	20/10/06	RAMDHANI	S.K. Pandey
UNLESS NOTED OTHERWISE ALL DIMENSIONS WILL BE IN ACCORDANCE WITH HINDALCO'S PUBLISHED STANDARD TOLERANCES. "ALL DIMENSIONS ARE IN MM"							ALLOY	CUSTOMER'S DWG NO :- Sketch
CUSTOMER APPROVAL OF DIMENSIONS AND TOLERANCES CONSTITUTE ACCEPTANCE OF MATERIAL WITHIN PRINT							6351	1-12882
EXT-D/S-9 RO							SECTION NO : SP-6383-R-1	