

BILL OF MATERIAL							
ITEM	QTY	PART NAME	PART NUMBER	MATERIAL	TSA (In ²)	CA (In ²)	MASS (Kg.)
1	1	INNER	E10525727-D11	AL 6082-T6	18.46	10.81	0.108

VERSION	PLACES	DESCRIPTION	CHANGED BY	DATE	APD. BY
A		INITIAL RELEASE		26.09.23	S.ADHIMOOLAM

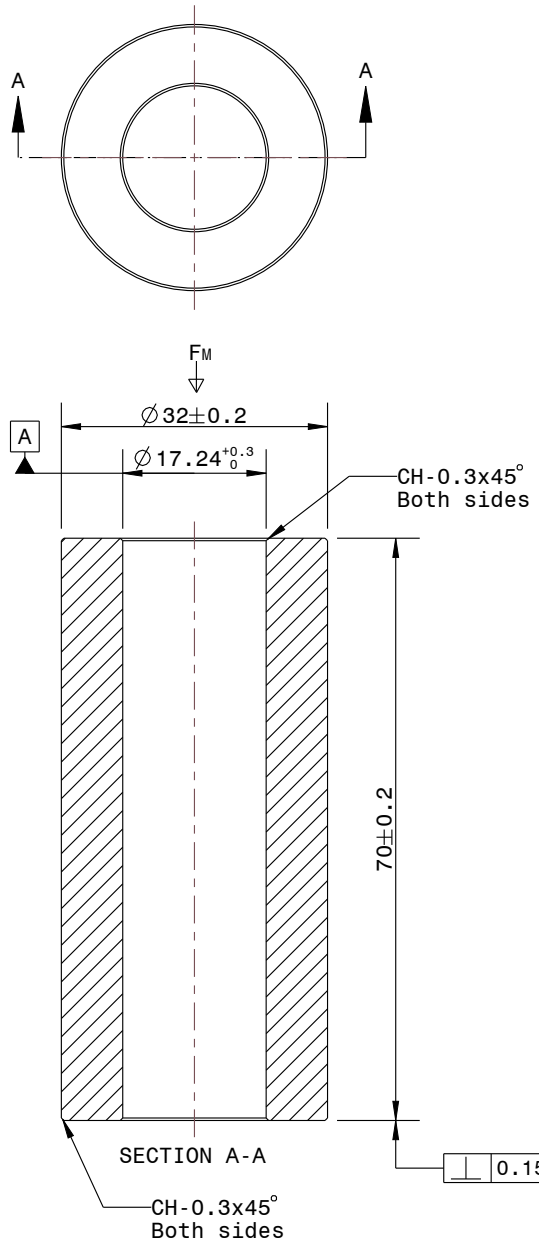

NOTES:-

CRUSH TEST:
 F1=60kN FM=120 kN (FM= MAXIMUM CLAMP LOAD)

- 1)APPLY AN AXIAL LOAD OF 'F1' kN AT A RATE OF 2mm/min. THIS INDICATES INITIAL HEIGHT h1.
- 2)CONTINUE WITH THE APPLICATION OF THE AXIAL LOAD AT A RATE OF 2mm/min UNTILL 'FM' KN IS ACHIEVED.
- 3)CHECK THE HEIGHT OF INNER AFTER FM LOAD, hm.
- 4)MAX ALLOWANCE PERMANANT SET L=(hm-h1) IS 0.16% OF THE INITIAL LENGTH.

<input checked="" type="checkbox"/> FOR QUOTATION <input type="checkbox"/> PROPOSED <input type="checkbox"/> FOR DEVELOPMENT <input type="checkbox"/> FOR SERIAL PRODUCTION	DRAWN BY ANIL CHECKED BY AMIT CHAWLA APPROVED BY S.ADHIMOOLAM CAD SYSTEM:- Creo 6.0 MASS:-	ANIL AMIT CHAWLA S.ADHIMOOLAM Creo 6.0 CALCULATED DATE:-	PART NAME INNER PART NUMBER E10525727-D11 MODEL IS MASTER FOR ALL NON-DIMENSIONAL FEATURE	 ANAND NVH PRODUCTS (P) LTD. N.H-8 SECTOR-35 GURGAON HARYANA 122001 (INDIA) PROPERTY OF ANP <small>THIS DRAWING IS SOLE PROPERTY OF ANP. IT SHOULD NOT BE COPIED BY ANYONE WITHOUT WRITTEN PERMISSION OF ANP</small>	
	FOR METAL TOLERANCED: ISO 2768-mk ISO 8015 FOR RUBBER TOLERANCED: DIN ISO 3302-1 M3 PROTECTION MARK: ISO 16015	SHEET A4 SCALE NTS UNIT mm REFERENCE PART NO.	<input type="checkbox"/>		
	FOR SERIAL PRODUCTION		DATE:-	MODEL IS MASTER FOR ALL NON-DIMENSIONAL FEATURE	REFERENCE PART NO.
	FOR SERIAL PRODUCTION		DATE:-	MODEL IS MASTER FOR ALL NON-DIMENSIONAL FEATURE	REFERENCE PART NO.