

D

C

B

A

Bill of Material

ITEM	DESCRIPTION	MATERIAL	QTY
1	INNER EXTRUSION	6063 T6	1/

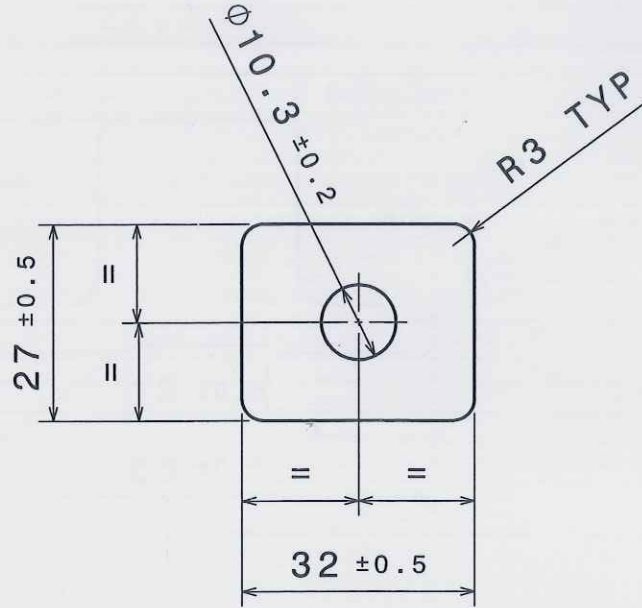
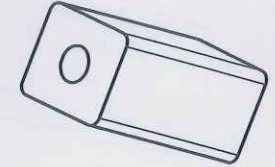

Q02171

NOTE:

- 1) FOR MORE DIM. REFER TO 3D MODEL.
- 2) PART SHOULD BE FREE FROM BURR, DENT, SCRATCH AND CUT MARKS
- 3) EXTRUSION OPEN LENGTH

Unspecified tolerances as per ISO 2768-mk						All dimensions in mm unless otherwise stated.		Special Characteristic Symbol	Safety Related	Key Fit & Function	0	
Dimensions	≤ 6	>6 & ≤30	>30 & ≤120	>120 & ≤400	>400 & ≤1000	>1000	Do not scale drawing					
Metal	±0.1	±0.2	±0.3	±0.5	±0.8	±1.2						
DRN	Vijay	13.07.2024	 Stork Rubber Products Pvt Ltd		F							
CHD	OPN				E							
APD	BALBIR				D							
SIZE	A4				C							
			INNER EXTRUSION OPEN LENGTH		B							
SCALE	WEIGHT (gms)	PART NUMBER			A	13.07.2024	INITIAL REVISION					
NTS	120	1301319 1006567			REV NO.	DATE	REVISION DETAIL		ECN NO	DRN BY	APP D.BY	

The information contained in this document is property of Stork Rubber Product Pvt Ltd. It is not to be shared or reproduced without permission.

D

A