

NOTE : 'R' DENOTES 1.57

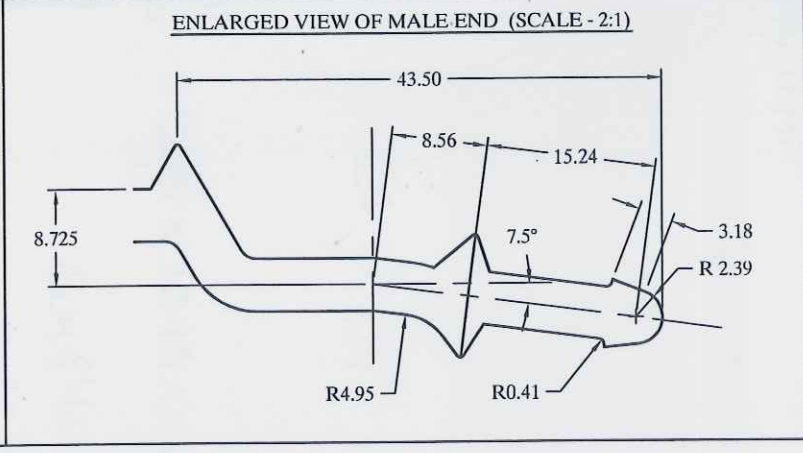
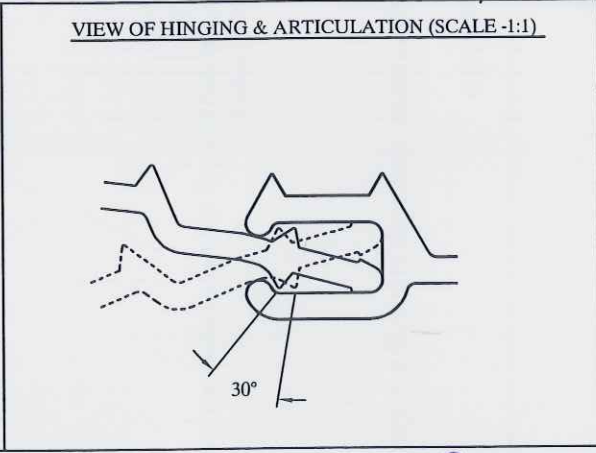
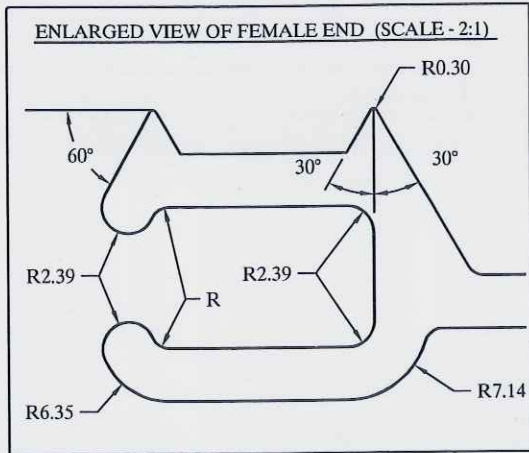
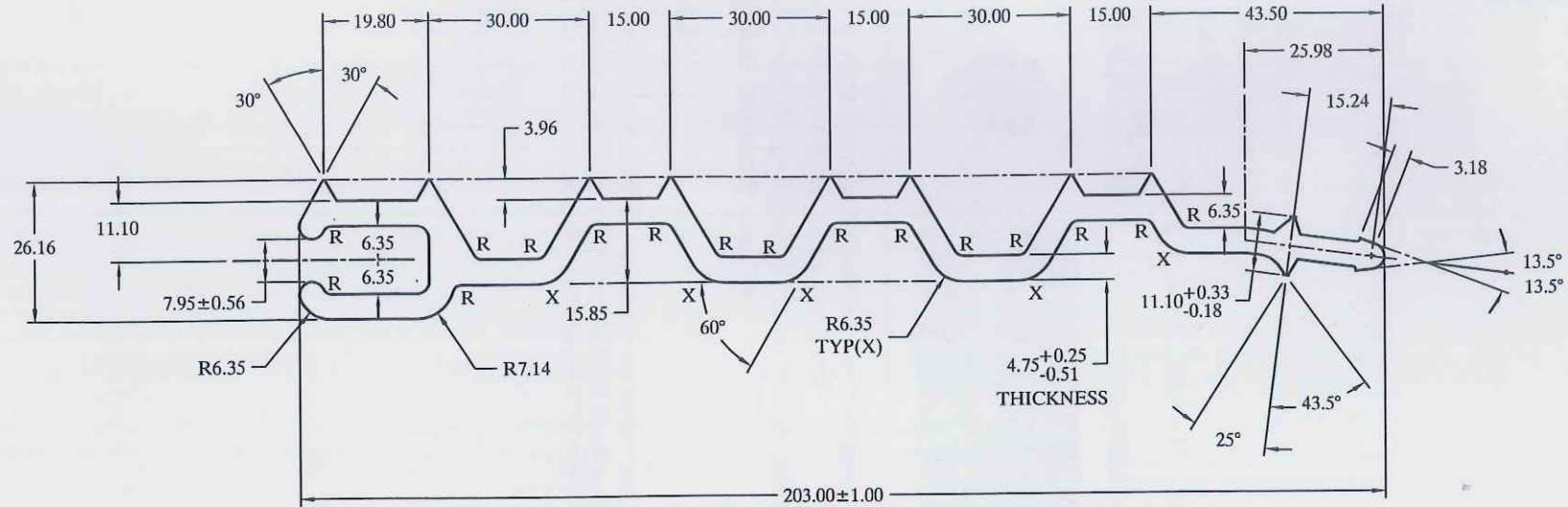

Q46400

PRESS NO.	DIE SIZE	NO OF HOLES	MIN CONT	EXT RATIO	ANGULARITY $\pm 2^\circ$	CUSTOMER'S APPROVAL	HINDALCO INDUSTRIES LIMITED EXTRUSION & DIESHOP P.O.- RENUKOOT, DISTT.- SONEBHADRA, UP, INDIA FAX. NO. 0091-5446-252107,252427 E-mail: hindalcoart@adityabirla.com								
I					FLATNESS 0.007 MM/MM OF WIDTH		REVISIONS	AREA	WT. (KG/M)	PERIMETER	FACTOR	SCALE	DATE	DRAWN	CHECKED
II					TWIST 1.70 MM/M			1430.71	3.877	596.84	1.54	1:1, 2:1	NIL-01.11.05	NLB/SLK	RAMDHANI
III					STRAIGHTNESS 1.70 MM/M	END USE :-		UNLESS NOTED OTHERWISE ALL DIMENSIONS WILL BE IN ACCORDANCE WITH HINDALCO'S PUBLISHED STANDARD TOLERANCES. "ALL DIMENSIONS ARE IN MM" CUSTOMER APPROVAL OF DIMENSIONS AND TOLERANCES CONSTITUTE ACCEPTANCE OF MATERIAL WITHIN PRINT.				ALLOY	HE 30-T6	EPD-4099/1/A	
TYP. WALL THICKNESS UNLESS INDICATED OTHERWISE					MATCHING NO. SELF	DEFENCE	EXT-D/S-9 RO				SECTION NO: SP-790 M				
0.30 TYP. RADIUS AT CORNERS UNLESS INDICATED OTHERWISE					SOLID SEMI-HOLLOW HOLLOW										