

GL01387

A

B

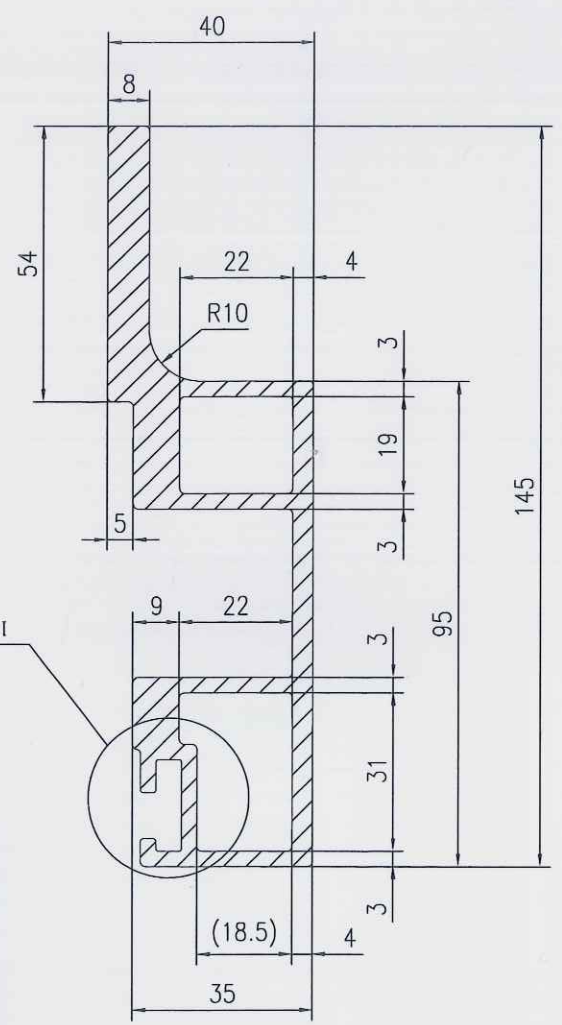

mm	mm	mm	mm	mm	mm
250	250	250	250	250	250
300	300	300	300	300	300
350	350	350	350	350	350
400	400	400	400	400	400
450	450	450	450	450	450
500	500	500	500	500	500
550	550	550	550	550	550
600	600	600	600	600	600
650	650	650	650	650	650
700	700	700	700	700	700
750	750	750	750	750	750
800	800	800	800	800	800
850	850	850	850	850	850
900	900	900	900	900	900
950	950	950	950	950	950
1000	1000	1000	1000	1000	1000
1050	1050	1050	1050	1050	1050
1100	1100	1100	1100	1100	1100
1150	1150	1150	1150	1150	1150
1200	1200	1200	1200	1200	1200
1250	1250	1250	1250	1250	1250
1300	1300	1300	1300	1300	1300
1350	1350	1350	1350	1350	1350
1400	1400	1400	1400	1400	1400
1450	1450	1450	1450	1450	1450
1500	1500	1500	1500	1500	1500
1550	1550	1550	1550	1550	1550
1600	1600	1600	1600	1600	1600
1650	1650	1650	1650	1650	1650
1700	1700	1700	1700	1700	1700
1750	1750	1750	1750	1750	1750
1800	1800	1800	1800	1800	1800
1850	1850	1850	1850	1850	1850
1900	1900	1900	1900	1900	1900
1950	1950	1950	1950	1950	1950
2000	2000	2000	2000	2000	2000

Q02217

2

版本	更改内容	更改文样号	更改人
00	原始版本	无	张正华ZZH/2014

1/2:1

All全部 3.2/

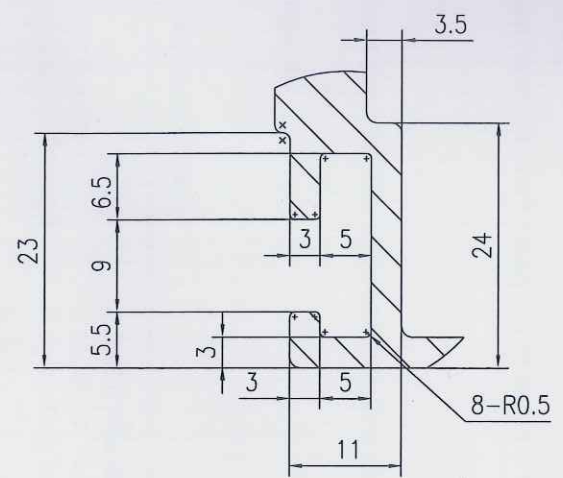

技术要求/NOTE

- 截面母线的直线度不超过1mm/m, 扭拧度不超过1mm/m.
Straightness of section generatrix no larger than 1mm/m
Torsion degree not exceeding 1mm/m.
- 化学成分和物理性能执行GB3190, 符合GB6892.
Chemical composition and physical GB/T 3190,
Performance acc.to GB6892.
屈服强度Rp0.2≥130Mpa; 抗拉强度Rm≥175Mpa; 延伸率A≥8%.
Mechanical Properties Rp0.2≥130Ma Rm≥175MPa A≥8%.
- 未注公差值执行EN12020-2 A类标准.
Tolerance not noted to be according to EN 12020-2 A.
- 2处标记“x”圆角R=0.75, 8处标记“+”圆角R=0.5, 未注倒角R=1.
Two positions marked with "x": R=0.75, 8 positions with "+": R=0.5, R=1 U.N.O.

状态 STATUS	DESIGNED 设计		MANAGER 经理		PROJECT 项目	6063-T5	ULTIMATE Corporation Limited 青岛欧特美股份有限公司 Frame bottom profile section 对接框下横梁型材	REV. 版本 00
	DRAWN 审核		APPROVED 批准		WEIGHT 重量 kg	SCALE 比例 1:1		
PROCESS 工艺					ISO-128	4	FORMAT 图幅 A3	GL01387
STANDARD 标准					PAGE 页码 1/1			

2