

REF NO: B-31

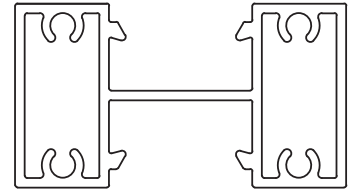

SCALE: 1:1

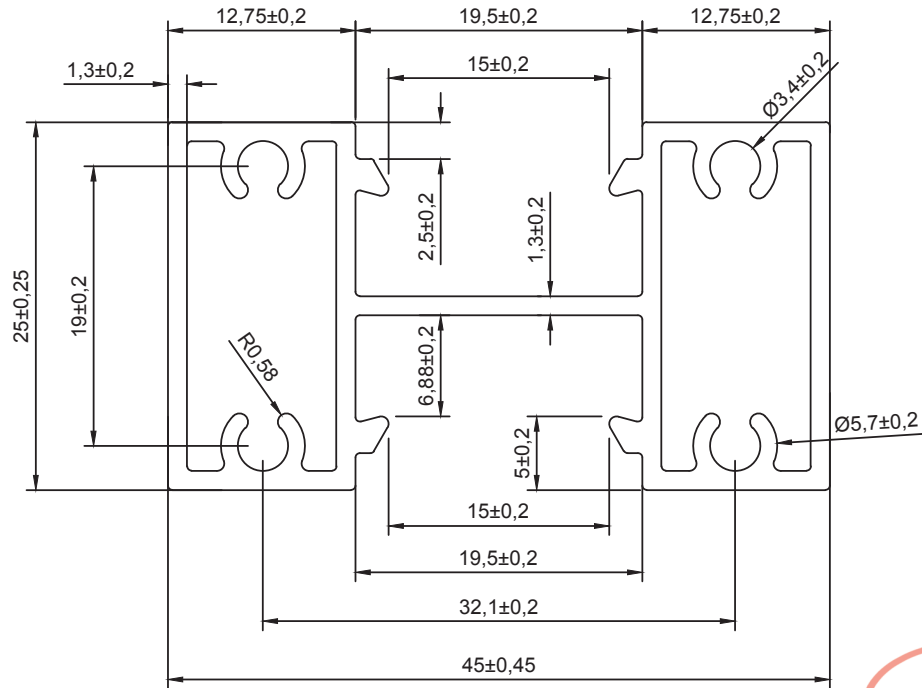

OK
28/1/22

CODE : SEW/STA/S1/536
REV : 00 / Dt : 28.01

NOTE:- ALL DIMENSIONS ARE IN mm.

UNSPECIFIED RADIUS:-0.50

WITH DIN ISO 2768-1 class C = Coarse		120-120	120-400	400-1000
Dimension	0.5 - 3	3 - 6	6 - 30	30 - 120
Longitudinal	±0.2	±0.3	±0.5	±0.8
chamfer & radius	0.5 - 3	3 - 6	6 - 30	30 - 120
radius	±0.4	±1.0	±2.0	±0.8
Degrees & Minutes	at 10	10-50	50-120	120-400
	±1°30'	±1°	±0°30'	±0°15'
				over 400
				±0°10'

AREA: 265.197 Sqmm [^]	ALLOY/TEMPER:-	DRAWN BY: RAJE
PERIMETER: 212.434	FLATNESS:-±0.8mm [^]	DATE: 28/01/2022
WEIGHT: 2.620 Kg/12'	TOLERANCES:	REVISION:-
DESCRIPTION :	ANGULARITY:	CHECKED BY:-
PARTY DRG NO:	straightness:	APPROVED BY:-
SECTION NO:	TWIST:-1.70mm/meter	SCALE:- 2:1