

SCALE: 1:1

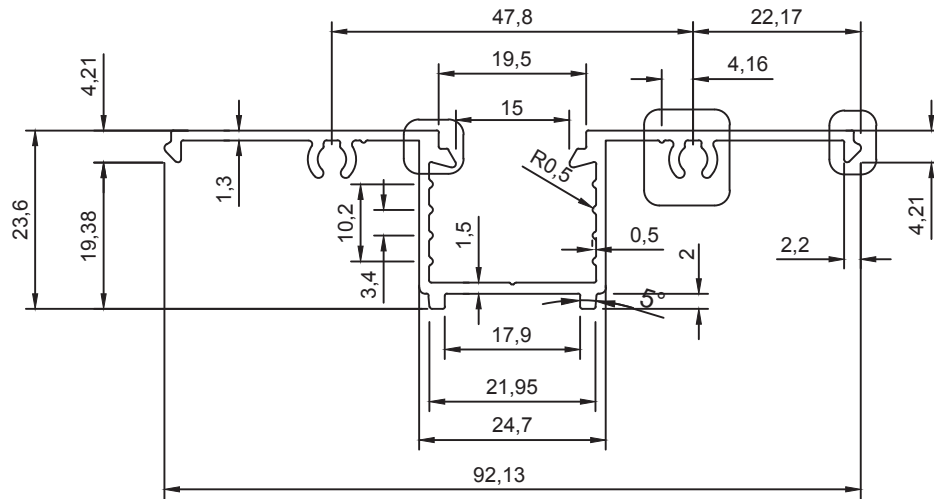

V-0.3X90°

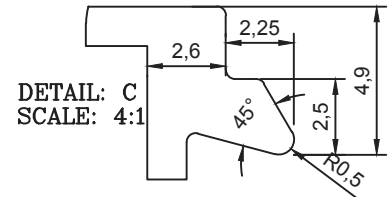
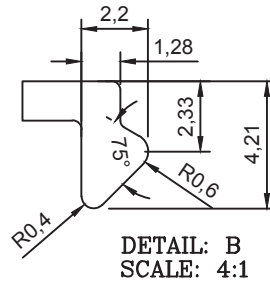
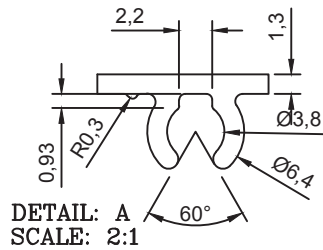

CODE : SEW/STA/S1/877

REV : 00 / Dt : 18.07

UNSPECIFIED RADIUS:-0.40

NOTE:- ALL DIMENSIONS ARE IN mm.

WITH DIN ISO 2768-1 class C = Coarse

Dimension	0.5 - 3	3 - 6	6 - 30	30-120	120-400	400-1000
Longitudinal	±0.2	±0.3	±0.5	±0.8	±1.2	±2.0
chamfer & radius	0.5 - 3 ±0.4	3 - 6 ±1.0	6 - 30 ±2.0	30-120 ±0.8	120-400 ±1.5	over 400 ±0.10°
Degrees & Minutes	at 10 ±1°30'	10-50 ±1°	50-120 ±0°30'	120-400 ±0°15'	over 400 ±0°10'	

AREA: 243.117 Sqmm ^	ALLOY/TEMPER:-	DRAWN BY: VENKY
PERIMETER: 336.286	FLATNESS:-±0.8mm ^	DATE: 18/07/2022
WEIGHT: 2.402 Kg/12'.	TOLERANCES:	REVISION:-
DESCRIPTION :	ANGULARITY:	CHECKED BY:-
PARTY DRG NO:	straightness:	APPROVED BY:-
SECTION NO:	TWIST:-1.70mm/meter	SCALE:- 1:1