

UNSPECIFIED TOLERANCES WILL BE IN ACCORDANCE WITH DIN ISO 2768-1 class C = Coarse

Dimension	0.5 - 3	3 - 6	6 - 30	30-120	120-400	400-1000
Longitudinal	±0.2	±0.3	±0.5	±0.8	±1.2	±2.0
chamfer & radius	±0.4	±1.0	±2.0	±0.8		
Degrees & Minutes	at 10	10-50	50-120	120-400	over 400	
	±1°30'	±1°	±0°30'	±0°15'	±0°10'	

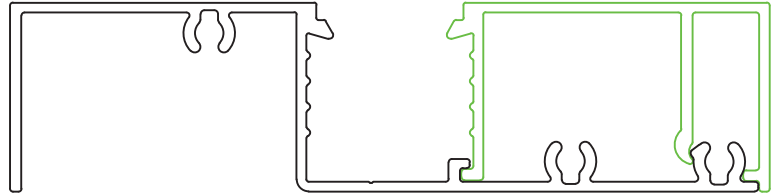

SCALE: 1:1

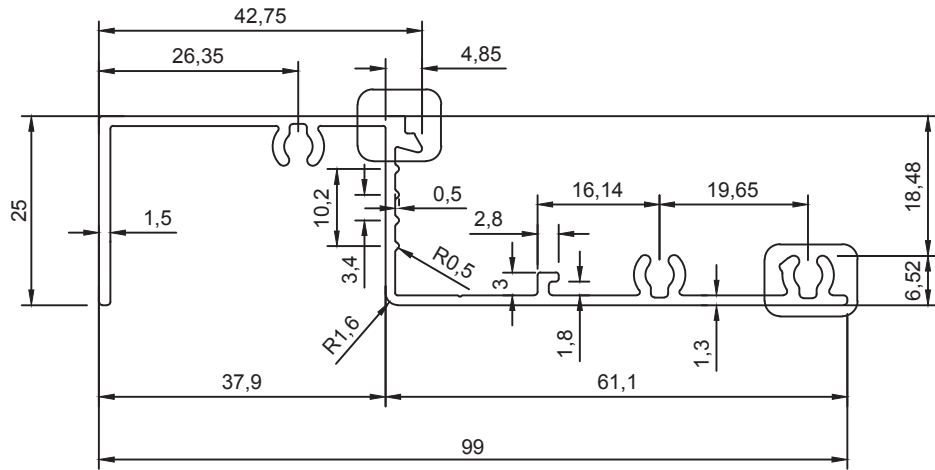
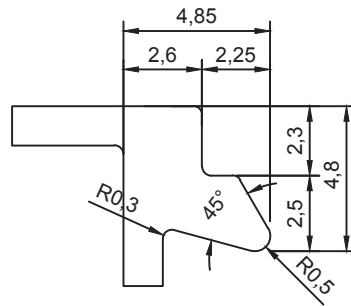
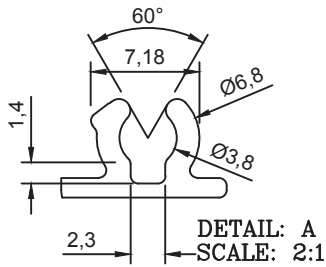

DETAIL: B
SCALE: 4:1

CODE : SEW/STA/S1/884
REV : 00 / Dt : 03.06

NOTE:- ALL DIMENSIONS ARE IN mm.

UNSPECIFIED RADIUS:-0.30

AREA: 260.219 Sqmm [^]	ALLOY/TEMPER:- 6063 T6	DRAWN BY: RAJE
EX PERIMETER: 373.105	FLATNESS:-±0.8mm [^]	DATE: 18/07/2022
WEIGHT: 2.571 Kg/12'	TOLERANCES:	REVISION:-
TYPE: HOLLOW	ANGULARITY:-±2°	CHECKED BY:-
PARTY DRG NO:	straightness:-1.70mm	APPROVED BY:-
SECTION NO:	TWIST:-1.70mm/meter	SCALE: 1:1