

SCALE: 1:1

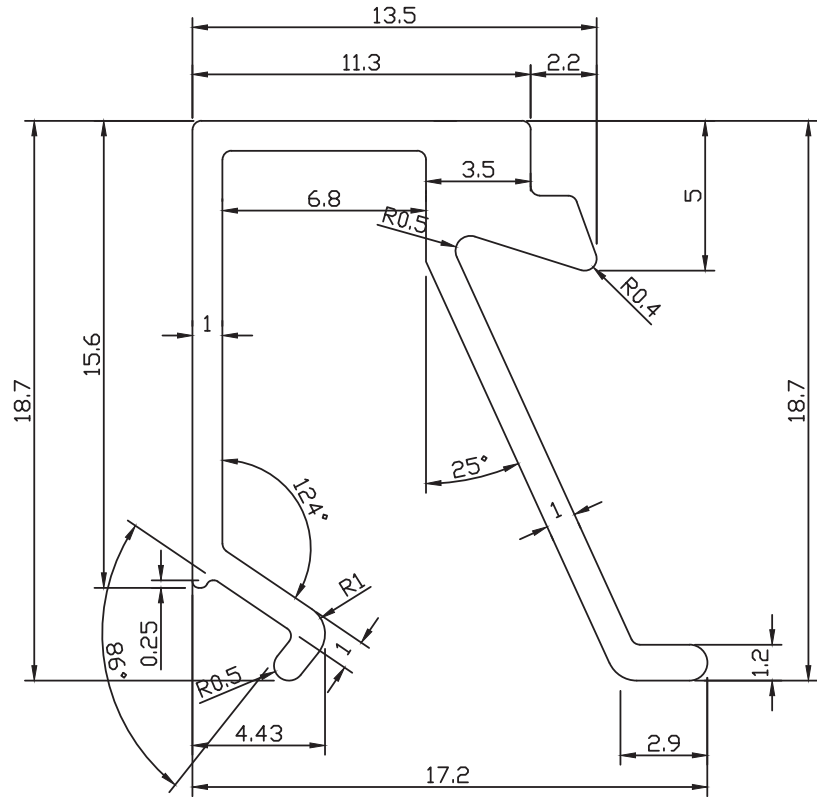

CODE : SEW/STA/S1/880
REV : 00 / Dt : 03.06

NOTE:- ALL DIMENSIONS ARE IN mm.

UNSPECIFIED RADIUS:-0.40

WITH DIN ISO 2768-1 class C = Coarse		120-400	400-1000
Dimension	0.5 - 3	3 - 6	6 - 30
Longitudinal	±0.2	±0.3	±0.5
chamfer & radius	0.5 - 3 ±0.4	3 - 6 ±1.0	6 - 30 ±2.0
Degrees & Minutes	at 10 ±1'30"	10-50 ±1°	50-120 ±0°30"
		120-400 ±0°15"	over 400 ±0°10"

AREA: 64.749 Sqmm [^]	ALLOY/TEMPER:-	DRAWN BY: VENKY
PERIMETER: 110.685	FLATNESS:-±0.8mm [^]	DATE: 03/06/2022
WEIGHT: 0.639 Kg/12'	TOLERANCES:	REVISION:-
DESCRIPTION :	ANGULARITY:	CHECKED BY:-
PARTY DRG NO:	straightness:	APPROVED BY:-
SECTION NO:	TWIST:-1.70mm/meter	SCALE:- 4:1