

CUSTOMER :-

ENQUIRY NO :-

ANGULARITY	- ±2'
FLATNESS	- 0.007MM PER mm OF WIDTH
TWIST	- 1.70MM PER METER
STRAIGHTNESS	- 1.70MM PER METER

r = 0.5 mm Radius
s = 0.2 mm Radius

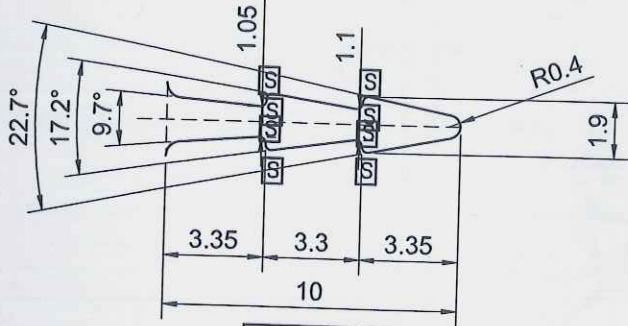

Detail = A
SCALE = 4:1

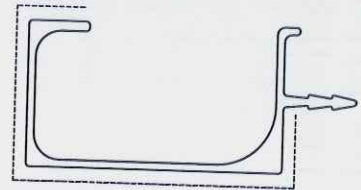

SCALE = 1:1

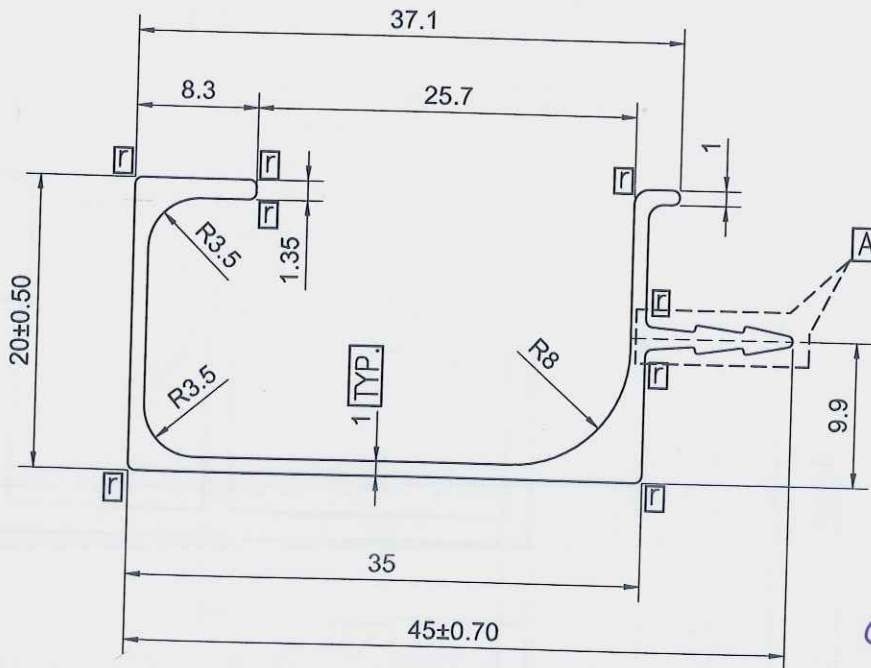

SCALE = 2:1

Q47297

Shilpa 22152

REVISIONS:-

NOTES: CORNERS MAY HAVE A RADIUS OF 0.50MM MAX IF NOT SPECIFIED FOR PROFILES
CORNERS MAY HAVE A RADIUS OF 0.80MM MAX IF NOT SPECIFIED FOR FLAT AND SQUARE BARS
HINDALCO STANDARD TOLERANCE SHALL APPLY UNLESS OTHERWISE SPECIFIED
STANDARD TOLERANCE - EN 755-9
ALL DIMENSIONS ARE IN MM

TYP = TYPICAL, IP = INTERSECTION POINT
C = CRITICAL DIMENSION, \diamond = FIT/FUNCTIONS
() - BRACKET DIMENSIONS ARE ONLY FOR REFERENCE
SHADE LINES MAY APPEAR ON PROFILE SURFACE
PRIMARY EXPOSED / VISIBLE SURFACE
SECONDARY EXPOSED / VISIBLE SURFACE

ALUPURAM SEC NO:
KUPPAM SEC NO:
SILVASSA SEC NO:
RENUKOOT SEC NO:

NOTE: DUE TO THE EXTRUSION PROCESS THERE WILL BE LIGHT HANDLING MARKS ON THE RUNOUT SURFACES WHICH WILL NOT BE GROUNDS FOR REJECTIONS



HINDALCO INDUSTRIES LTD

Central Die Shop, Khanvel
Silvassa - 396230
Dadra and Nagar Haveli



AREA	117.364	DIE CATEGORY		SURFACE : CLASS	
PERIMETER	177.768	END USE CODE		DIE ORDER NO	
EXTERNAL PERIMETER		SCALE	1:1	TYPE OF PROFILE	S
WEIGHT: kg/m	0.317	THICKNESS MAX	1	END SEGMENT	
WEIGHT RANGE:kg/m		THICKNESS MIN	1	PRODUCT	
DIE FACTOR	560.989	IDEAL CONTAINER	7"	END APPLICATION	
CCD	47	ALLOY	6063-T6	DATE	04/09/2023
LENGTH OF EXPOSED SURFACE		DIE DIFFICULTY RATINGS		DRAWN	YUVRAJ

APPROVED

CUSTOMER REF NO :-

ENQUIRY CAD NO :- CE-323-23-001

SECTION NO: 101202