

*DRAWING WAS DRAWN BY USING DAMAGED SAMPLE WHICH MAY LEAD SOME DEVIATION  
SO, KINDLY CHECK ALL DIMENSIONS PROPERLY*

*THICKNESS CONFIRM BY MR. VIPUL SIR 1.9MM*

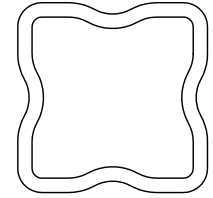

*SCALE 1:1*

Q02566

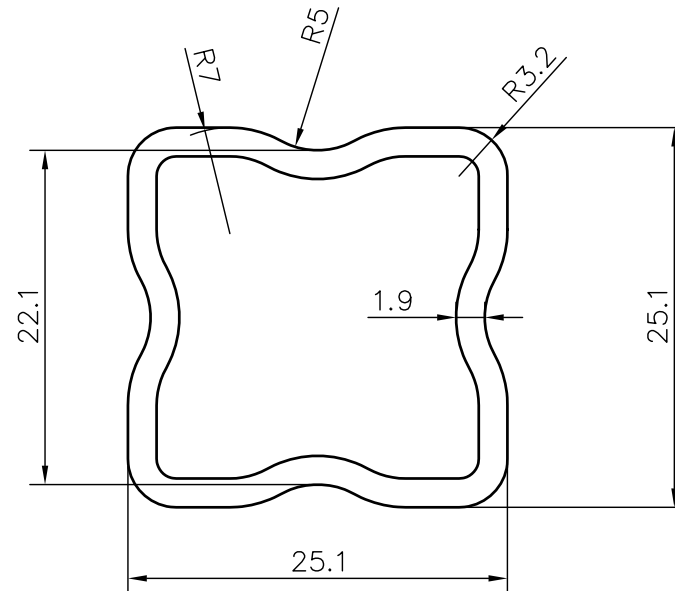

*SCALE 2:1*

Area: 172.854 Sq.mm. | Perimeter: 96.945 mm. | Weight: 0.467 Kg./mtr.