

B (2:1)

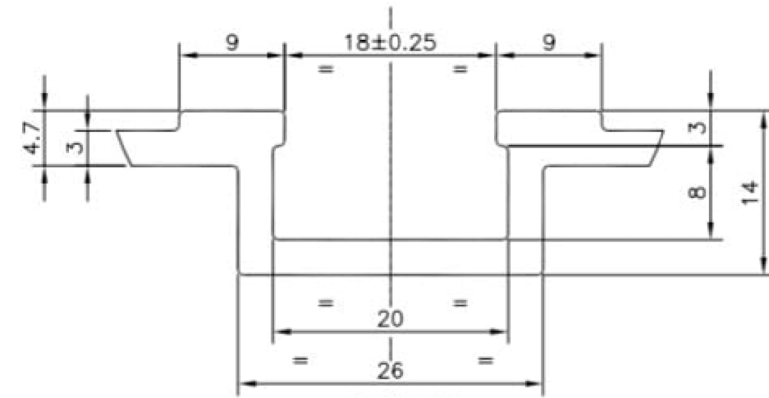

E (2:1)

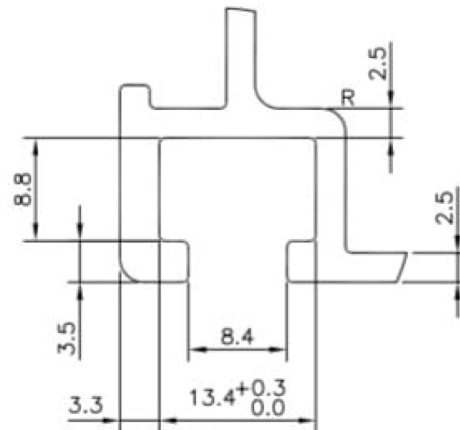

C (2:1)

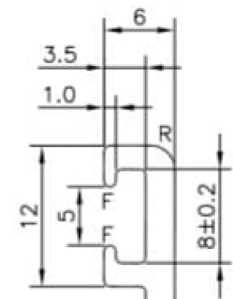

A (2:1)

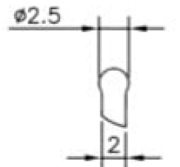

D (2:1)

1. ROUND OFF ALL SHARP CORNERS WITH 0.5 mm.
2. R = 2.0 RADIUS (14)
3. F = FULL RADIUS (2)
4. OUT SIDE SURFACE TO BE SMOOTH & FREE FROM DIE LINES
5. PRODUCT SHOULD BE FREE FROM SCRATCHES & BURRS
6. TWIST & BENDS SHOULD BE ≤ 1 mm./M.