

SF1  
SLIDING FRAME(VERTICAL&TOP) KG./M. 1.141

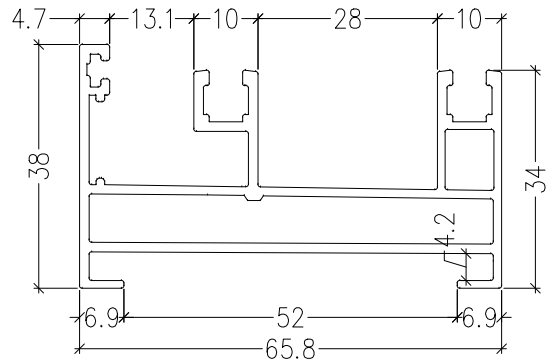

SF2  
SLIDING FRAME KG./M. 1.107

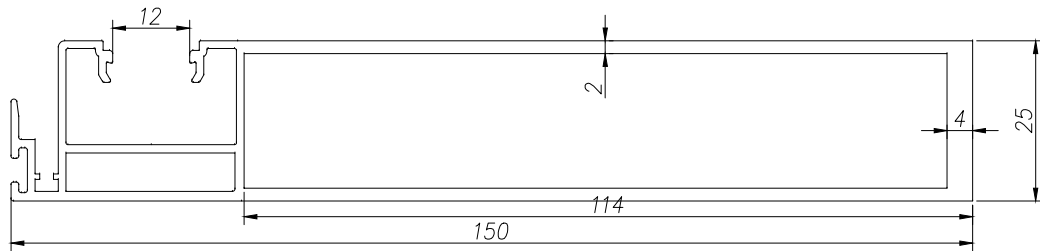

IL3  
SLIDING INTERLOCK SHUTTER KG./M. 2.005

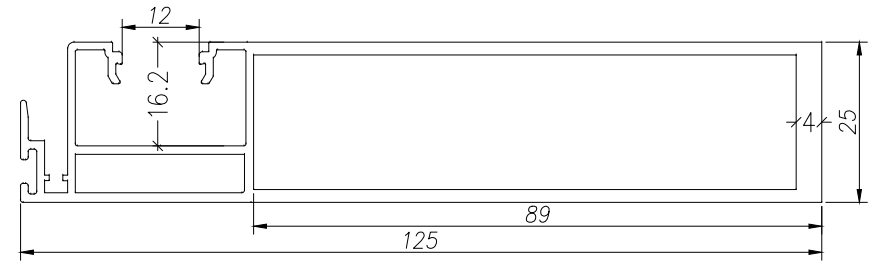

IL2  
SLIDING INTERLOCK SHUTTER KG./M. 1.732

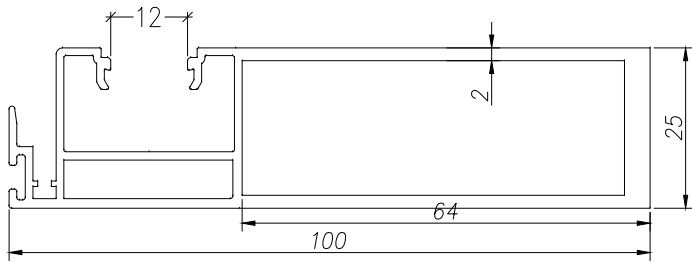

IL1  
SLIDING INTERLOCK SHUTTER KG./M. 1.462

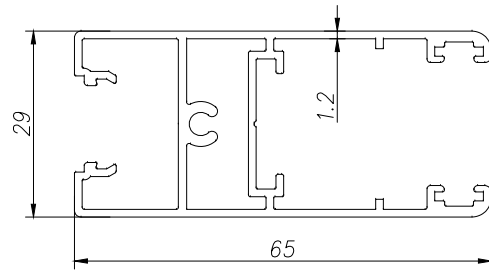

SH  
SLIDING HANDRAIL SHUTTER KG./M. 0.870

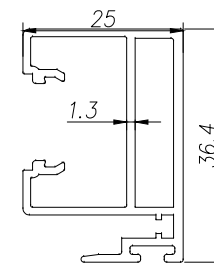

IL  
SLIDING INTERLOCK SHUTTER KG./M. 0.575

\*\*kindly check track as/ Sliding Roller

**Q01523**

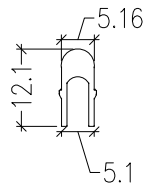

RL  
TRACK KG./M 0.092