

REMOVE ALL SHARP CORNERS/EDGES

CAD DRAWING DO NOT MODIFY

DO NOT SCALE DRAWING

UNCONTROLLED COPY
NOT FOR PRODUCTION
UNLESS OVERSTAMPED
"CONTROLLED"
IN RED INK

BY	DATE	ALTERATIONS	ISSUE
KKB	10/01/2013	PRODUCTION RELEASE. PR13-004.	A
KKB	10-01-2013	11.0 WA 12.7, R0.8 WAS R2.0, AREA WAS 388.68, WEIGHT WAS 1.0533kg/M, R1.0 (TOP RIGHT) WAS R0.5, 56.4 WAS 57.5, 3.0 THICKNESS AT BASE WAS 4.1 GEOMETRIC TOLERANCES ADDED	2
CA	11-10-2012	FOR COSTING ONLY CE12-322	1
-	-	-	-

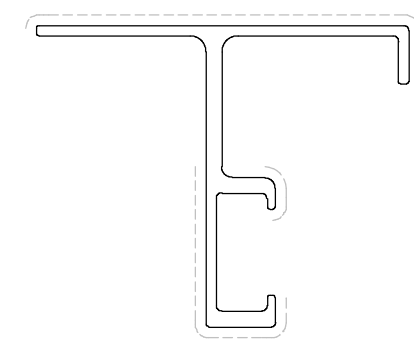
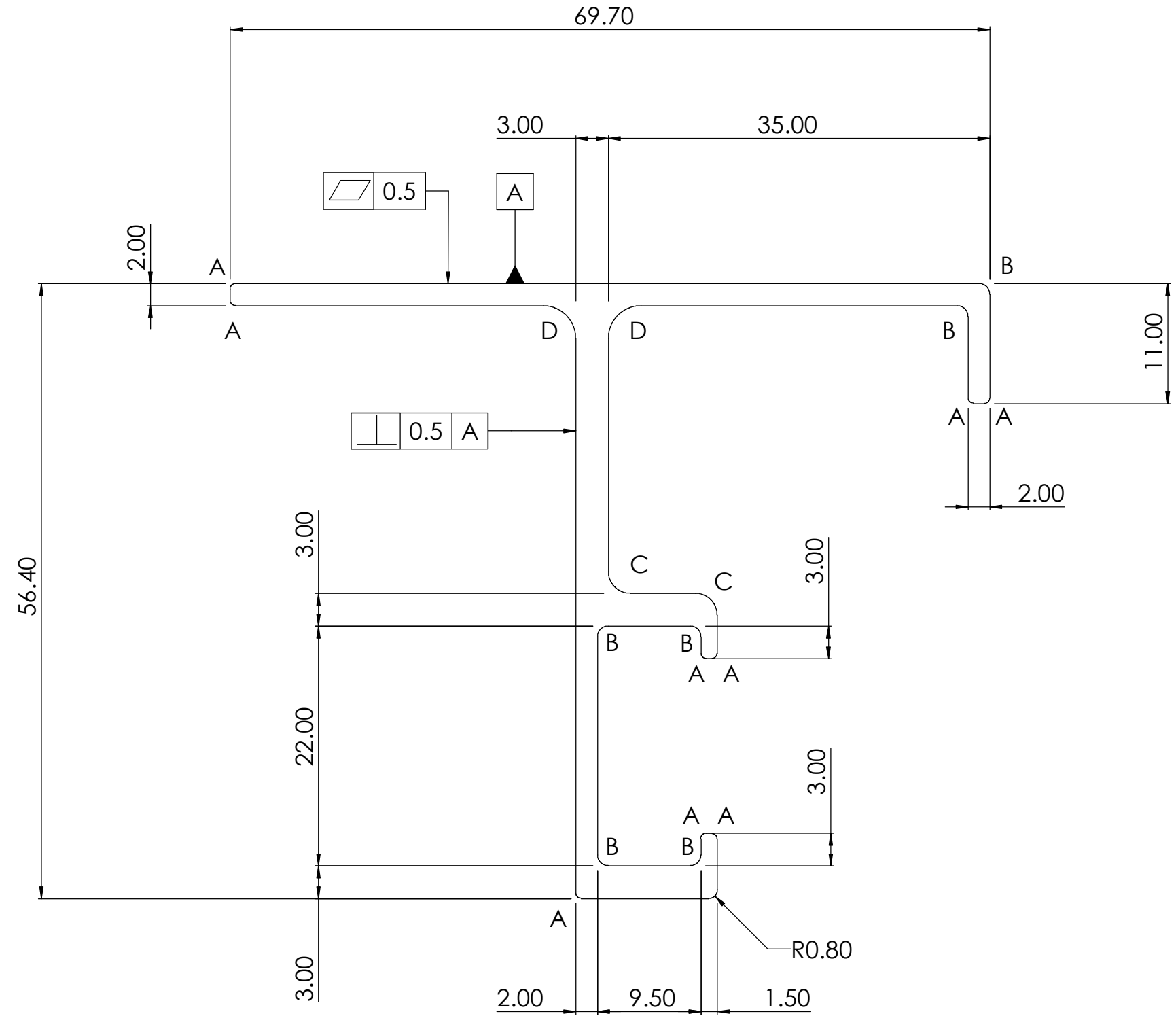

SCALE 1:1

A DENOTES R0.5 RAD
B DENOTES R1.0 RAD
C DENOTES R2.0 RAD
D DENOTES R3.0 RAD
----- DENOTES VISIBLE SURFACE

COMPONENT INFORMATION

1. AREA - 371.701mm²
2. MATERIAL - ALUMINIUM ALLOY 6063-T6 TO BE EN 755. WEBSTER HARDNESS 12 MIN
3. WEIGHT - 1.0073kg/m

DESIGNER	PH 23/04/2014
TOLERANCES UNLESS OTHERWISE SPECIFIED	
X	±
X.X	±
X.XX	± EN755: 1997
HOLE CRS	±
ANGULAR	± 0.5°
MATERIAL	SEE NOTES
FINISH	SEE NOTES
WEIGHT	CE No. CE12-322



TITLE
OUTER FRAME SECTION

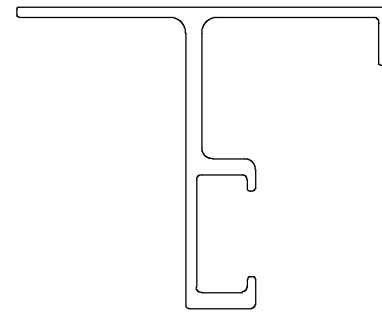

Part Number 29/61545
Description OUTER FRAME SECTION
CE12-322
Material SEE NOTES
Material SEE NOTES
issue A
Date
scale 1:1