

1121

10095

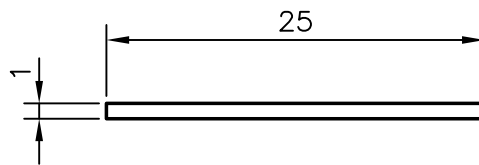

1:1



**JINDAL ALUMINIUM LTD.**

**BANGALORE-560073**

NAME

DATE

DRAWN

R.D.Sharma

01-07-97

1. ALL DIMENSIONS ARE IN mm.  
2. ROUND OFF ALL SHARP CORNERS WITH 0.4 mm.  
3. TOLERANCES WILL BE AS PER IS: 3965-1981 ,UNLESS OTHERWISE SPECIFIED

CHECKED

APPROVED

PARTY'S NAME

-

SCALE

2:1

PARTY'S DRAWING No.

-

WEIGHT kg/m

0.068

ALLOY &amp; TEMPER

HE9 WP

SECTION No.

10095

LENGTH

3658 mm.

DRAWING No.

DESCRIPTION

FLAT BAR

10095