

P-9396

S2244

10396

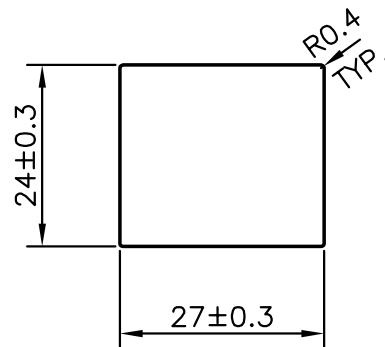

SYMBOL OF QUALITY
AN ISO 9001 COMPANY

JINDAL ALUMINIUM LTD.
BANGALORE-560073 (INDIA)

| | NAME | DATE |
|----------|-------------|------------|
| DRAWN | RAGHAVENDRA | 14-07-2009 |
| CHECKED | | |
| APPROVED | | |

1. ALL DIMENSIONS ARE IN mm.
2. ROUND OFF ALL SHARP CORNERS WITH 0.40 mm.
3. TOLERANCES WILL BE AS PER IS:3965-1981 UNLESS OTHERWISE SPECIFIED

| | |
|----------------------|---------|
| SCALE | 1:1 |
| AREA mm ² | 647.863 |
| PERIMETER mm. | 101.31 |
| WEIGHT kg/m | 1.749 |

PARTY'S NAME GLOBAL AUTOTECH LTD., NOIDA

| DRAWING No. | SECTION No. |
|-------------|-------------|
| P-9396 | - |
| S2244 | S2244 |
| 10396 | 10396 |

PARTY'S DRAWING No. TC-EX-030

ALLOY & TEMPER 65032 WP

DESCRIPTION FLAT BAR-TUBE CONNECTOR