

P-11891-2

10405

1:1

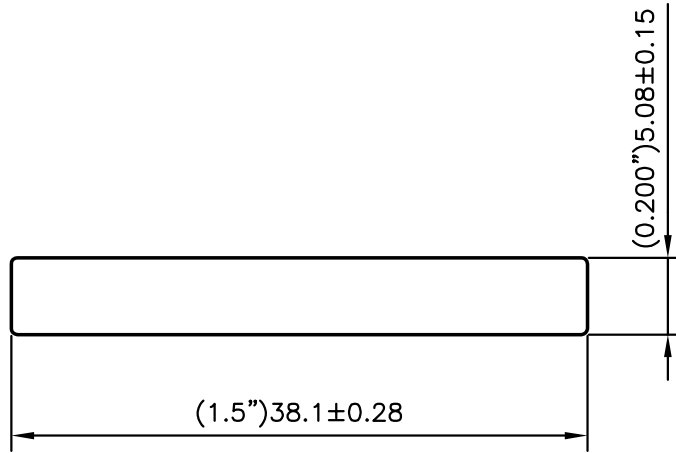

REQUIRED IN COIL FORM

PART No	GE spec
CDE10054	B12H60C



SYMBOL OF QUALITY
AN ISO 9001 COMPANY

JINDAL ALUMINIUM LTD.
BANGALORE-560073 (INDIA)

	NAME	DATE
DRAWN	J.P.KAUSHIK	12-07-2012
CHECKED		
APPROVED	S.S.GARG	17-07-2012

1. ALL DIMENSIONS ARE IN mm.
2. ROUND OFF ALL SHARP CORNERS WITH 0.40 mm.
3. TOLERANCES WILL BE AS PER ASTM-B317M-07 UNLESS OTHERWISE SPECIFIED

SCALE	2:1
AREA mm ²	193.411
PERIMETER mm.	85.673
WEIGHT kg/m	0.522

PARTY'S NAME	GENERAL CONSUMER & INDUSTRIAL, USA	DRAWING No.	P-11891-2	SECTION No.	-
PARTY'S DRAWING No.	AS PER SPECIFICATION		10405		10405
ALLOY & TEMPER	6101 T63				
DESCRIPTION	FLAT BAR (BUS BAR)				