

P-11893-2

10409

1:1

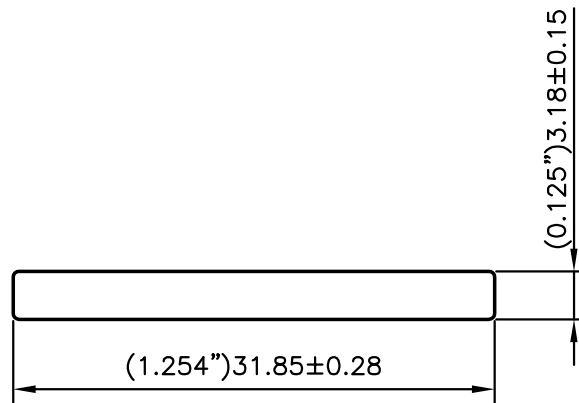

PART No	GE spec
CDE22293	B12H60C



SYMBOL OF QUALITY  
AN ISO 9001 COMPANY

**JINDAL ALUMINIUM LTD.**  
BANGALORE-560073 (INDIA)

	NAME	DATE
DRAWN	J.P.KAUSHIK	12-07-2012
CHECKED		
APPROVED	S.S.GARG	10-09-2012
SCALE		2:1
AREA mm <sup>2</sup>		101.146
PERIMETER mm.		69.373
WEIGHT kg/m		0.273
DRAWING No.	SECTION No.	
P-11893-2	-	
10409	10409	

1. ALL DIMENSIONS ARE IN mm.
2. ROUND OFF ALL SHARP CORNERS WITH 0.40 mm.
3. TOLERANCES WILL BE AS PER ASTM-B317M-07 UNLESS OTHERWISE SPECIFIED

PARTY'S NAME	GENERAL ELECTRIC COMPANY, USA
PARTY'S DRAWING No.	AS PER SPECIFICATION
ALLOY & TEMPER	6101 T63
DESCRIPTION	FLAT BAR (BUS BAR)