

P-11895-2

10411

1:1

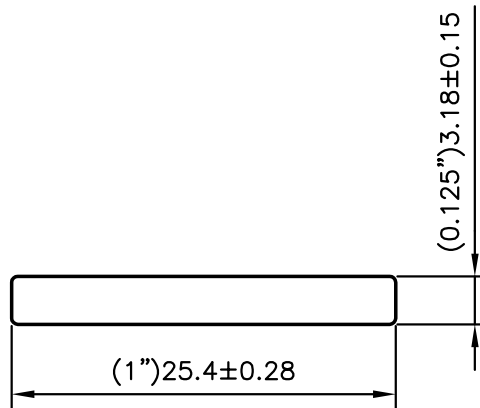

TENSILE:-22 TO 32 ksi

YIELD:-12 TO 27 ksi

CONDUCTIVITY:-Min. 56.5 %

PART No	GE spec
CDE0024	B12H60G

ISSUE:-2

TEMPER CHANGED FROM 6101 T63 TO 6101 T65



SYMBOL OF QUALITY
AN ISO 9001 COMPANY

JINDAL ALUMINIUM LTD.
BANGALORE-560073 (INDIA)

	NAME	DATE
DRAWN	J.P.KAUSHIK	11-09-2012
CHECKED		
APPROVED	S.S.GARG	14-09-2012
SCALE		2:1
AREA mm ²		80.635
PERIMETER mm.		56.473
WEIGHT kg/m		0.218
DRAWING No.		SECTION No.
P-11895-2		-
10411		10411(ISSUE-2)

1. ALL DIMENSIONS ARE IN mm.
2. ROUND OFF ALL SHARP CORNERS WITH 0.40 mm.
3. TOLERANCES WILL BE AS PER ASTM-B317M-07 UNLESS OTHERWISE SPECIFIED

PARTY'S NAME	GENERAL ELECTRIC COMPANY, USA
--------------	-------------------------------

PARTY'S DRAWING No.	AS PER SPECIFICATION
---------------------	----------------------

ALLOY & TEMPER	6101 T65
----------------	----------

DESCRIPTION	FLAT BAR (BUS BAR)
-------------	--------------------