

P-11890-4

10421

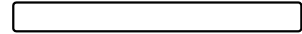

1:1

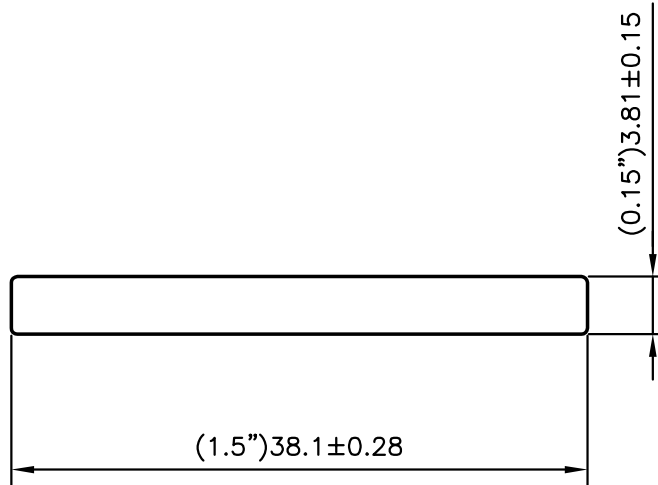

REQUIRED IN COIL FORM

PART No	GE spec
CDE22704	B12H60C



SYMBOL OF QUALITY
AN ISO 9001 COMPANY

JINDAL ALUMINIUM LTD.
BANGALORE-560073 (INDIA)

	NAME	DATE
DRAWN	J.P.KAUSHIK	06-11-2012
CHECKED		
APPROVED	S.S.GARG	09-11-2012
SCALE		2:1
AREA mm ²		145.024
PERIMETER mm.		83.133
WEIGHT kg/m		0.392
DRAWING No.	SECTION No.	
P-11890-4	-	
10421	10421	

1. ALL DIMENSIONS ARE IN mm.
2. ROUND OFF ALL SHARP CORNERS WITH 0.40 mm.
3. TOLERANCES WILL BE AS PER ANSI:H35.2-2009 UNLESS OTHERWISE SPECIFIED

PARTY'S NAME	GENERAL ELECTRIC COMPANY, USA
PARTY'S DRAWING No.	AS PER SPECIFICATION
ALLOY & TEMPER	6101 T63
DESCRIPTION	FLAT BAR (BUS BAR)