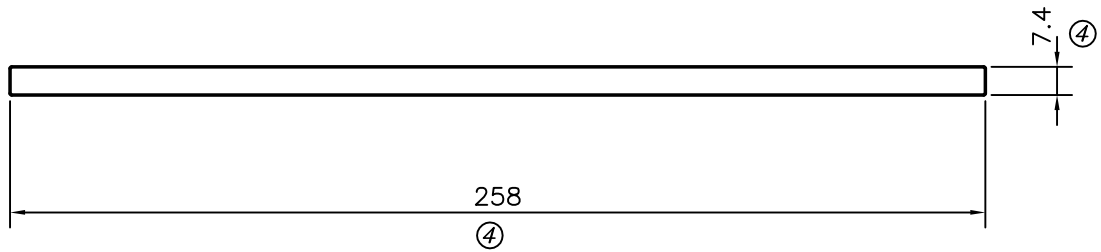

P-12312

10427

**ISSUE (2) :-**

- ☞ TOLERANCE ADDED ON THICKNESS.

ISSUE (3) :-

- ☞ THICKNESS CHANGED FROM 5.9 TO 9 mm.
- ☞ WEIGHT ALSO CHANGED FROM 4.094 Kg/M. TO 6.245 Kg/M.

ISSUE (4) :-

- ☞ THICKNESS CHANGED FROM 9.0 TO 7.4 mm.
- ☞ DIMENSION CHANGED FROM 257 TO 258 mm.
- ☞ WEIGHT ALSO CHANGED FROM 6.245 Kg/M. TO 5.154 Kg/M.



SYMBOL OF QUALITY
AN ISO 9001 COMPANY

JINDAL ALUMINIUM LTD.
BANGALORE-560073 (INDIA)

	NAME	DATE
DRAWN	PARVESH	21-10-2013
CHECKED		
APPROVED	S.S.GARG	21-10-2013
SCALE		0.5:1
AREA mm ²		1909.063
PERIMETER mm.		530.113
WEIGHT kg/m		5.154
DRAWING No.		SECTION No.
P-12312		-
10427		10427(ISSUE-4)

1. ALL DIMENSIONS ARE IN mm.
2. ROUND OFF ALL SHARP CORNERS WITH 0.40 mm.
3. TOLERANCES WILL BE AS PER IS:3965-1981, UNLESS OTHERWISE SPECIFIED

PARTY'S NAME	BANGALORE MARKET (ROLLING MILL DIVISION)
PARTY'S DRAWING No.	AS PER SPECIFICATION
ALLOY & TEMPER	19700
DESCRIPTION	FLAT BAR