

P-7298

11143

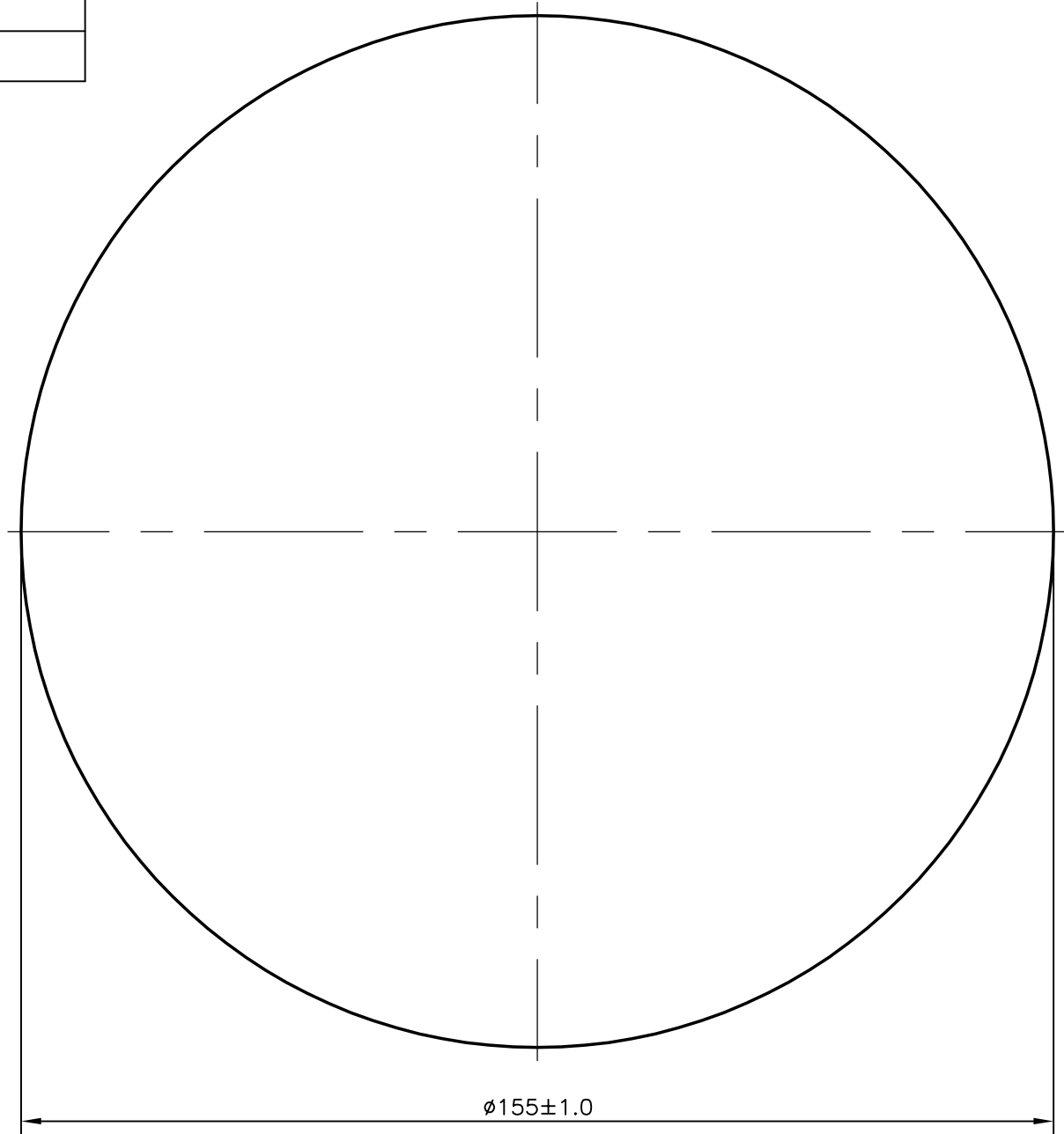

$\phi 155 \pm 1.0$



SYMBOL OF QUALITY
AN ISO 9001 COMPANY

JINDAL ALUMINIUM LTD.
BANGALORE-560073 (INDIA)

	NAME	DATE
DRAWN	PRASANN.H	25-05-2007
CHECKED		
APPROVED		

1. ALL DIMENSIONS ARE IN mm.
2. ROUND OFF ALL SHARP CORNERS WITH 0.40 mm.
3. TOLERANCES WILL BE AS PER BS:EN-755 UNLESS OTHERWISE SPECIFIED

SCALE	1:1
AREA mm ²	18869.191
PERIMETER mm.	486.947
WEIGHT kg/m	50.947

PARTY'S NAME	AMANDLA METAL TRADERS SA.PTY.LTD.,S.AFRICA
PARTY'S DRAWING No.	AS PER SPECIFICATION
ALLOY & TEMPER	6082 T6
DESCRIPTION	ROUND ROD

DRAWING No.	SECTION No.
P-7298	-
11143	11143