

1876

12021

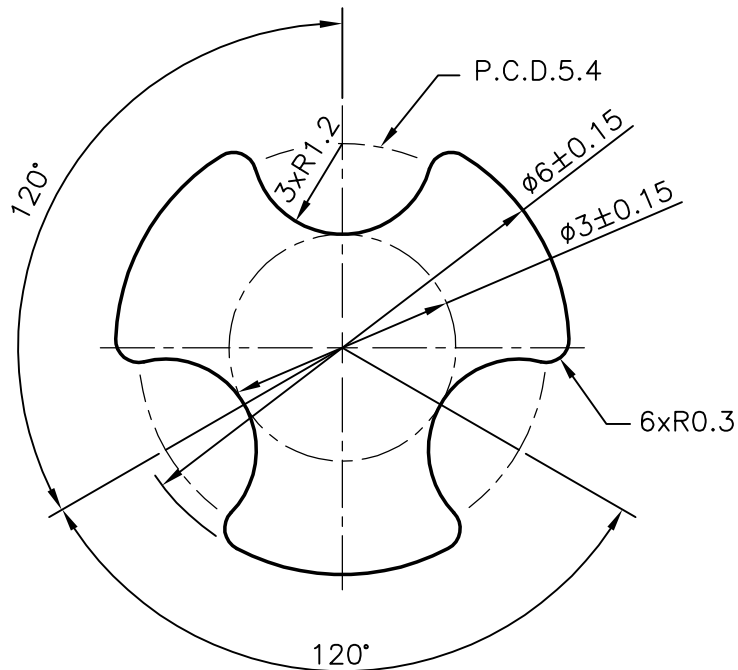

1:1



JINDAL ALUMINIUM LTD.

BANGALORE-560073

NAME

DATE

DRAWN

R.D.Sharma

29-09-98

CHECKED

APPROVED

1. ALL DIMENSIONS ARE IN mm.
2. ROUND OFF ALL SHARP CORNERS WITH 0.4 mm.
3. TOLERANCES WILL BE AS PER IS: 3965-1981 ,UNLESS OTHERWISE SPECIFIED

PARTY'S NAME

INTERPLAST CO LTD., SHARJAH, U.A.E.

SCALE

1:1 & 10:1

PARTY'S DRAWING No.

103-198

WEIGHT kg/m

0.053

ALLOY & TEMPER

HE9 WP (6063 T6)

SECTION No.

12021

LENGTH

AS PER PURCHASE ORDER $+2.00$
 -3.00 mm.

DRAWING No.

12021

DESCRIPTION

3 PRONG PINION