

P-17216

S5607

12314

BCDE

∇	0.15/100
----------	----------

CD

\perp	0.1	A
---------	-----	---

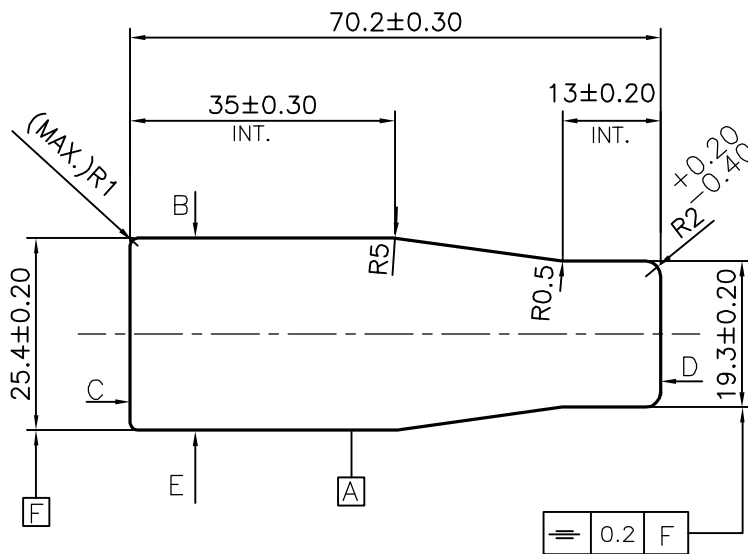

TOLERANCES ON OVERALL WIDTHS & WIDTHS ACROSS FLATS OF BARS, & REGULAR SECTIONS

UPTO 6.40mm - ±0.20	UPTO 32.0mm - ±0.38	UPTO 120.0mm - ±0.85	UPTO 320.00mm - ±1.70
UPTO 10.0mm - ±0.23	UPTO 50.0mm - ±0.46	UPTO 160.0mm - ±1.02	
UPTO 12.0mm - ±0.25	UPTO 60.0mm - ±0.53	UPTO 200.0mm - ±1.14	
UPTO 16.0mm - ±0.28	UPTO 80.0mm - ±0.69	UPTO 250.0mm - ±1.40	
UPTO 25.0mm - ±0.30	UPTO 100.0mm - ±0.75	UPTO 300.0mm - ±1.65	



SYMBOL OF QUALITY
AN ISO 9001 COMPANY

JINDAL ALUMINIUM LTD.
BANGALORE-560073 (INDIA)

	NAME	DATE
DRAWN	J.P.KAUSHIK	05-06-2017
CHECKED		
APPROVED	B.NATARAJA	08-12-2017

- ALL DIMENSIONS ARE IN mm.
- ROUND OFF ALL SHARP CORNERS WITH 0.4 mm.
- TOLERANCES WILL BE AS PER IS:3965-1981, UNLESS OTHERWISE SPECIFIED

SCALE	1:1
AREA mm ²	1633.919
PERIMETER mm.	183.34
WEIGHT kg/m	4.412

PARTY'S NAME	EGELHOF CONTROLS INDIA PVT. LTD., GREATER NOIDA
PARTY'S DRAWING No.	014.254-000
ALLOY & TEMPER	6262 T6
DESCRIPTION	MISC. BAR

DRAWING No.	SECTION No.
P-17216	-
S5607	S5607
12314	12314