

P-3719

S832

20153

13356

1. BOTH I.D & O.D SHOULD SMOOTH SURFACE FINISH REQUIRED
2. CONCENTRICITY OF BOTH DIA SHOULD BE WITHIN  $\pm 0.5\text{mm}$
3. TOLERANCES FOR STRAIGHTNESS AS PER IS ONLY

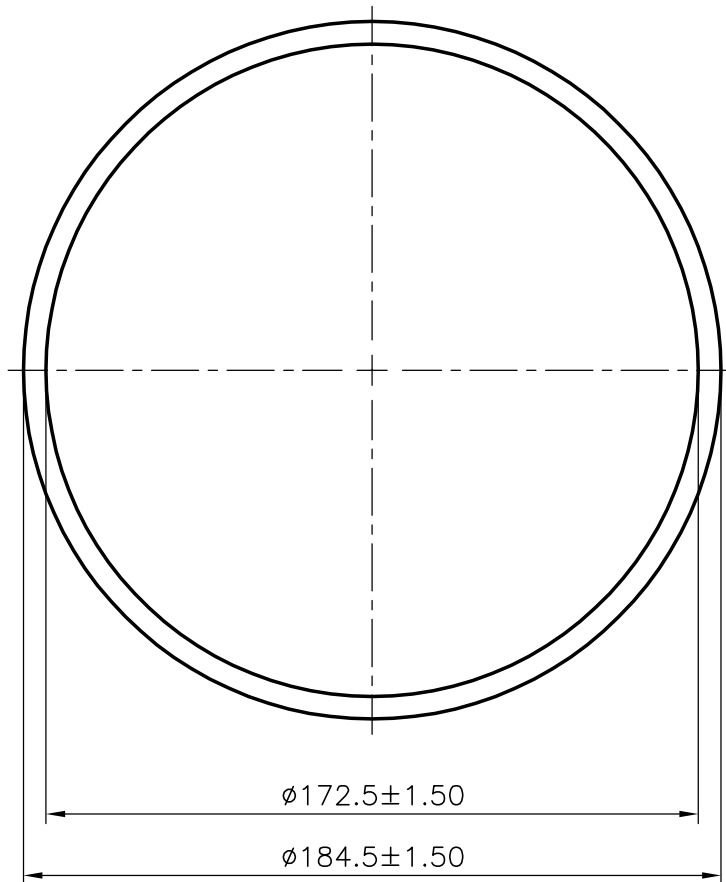

SYMBOL OF QUALITY  
AN ISO 9002 COMPANY

**JINDAL ALUMINIUM LTD.**  
BANGALORE-560073 (INDIA)

	NAME	DATE
DRAWN	RAGHAVENDRA	05-01-02
CHECKED		
APPROVED		

1. ALL DIMENSIONS ARE IN mm.
2. ROUND OFF ALL SHARP CORNERS WITH 0.40 mm.
3. TOLERANCES WILL BE AS PER IS 2673-1979 UNLESS OTHERWISE SPECIFIED

SCALE	1:2
AREA mm <sup>2</sup>	3364.65
PERIMETER	579.62mm
WEIGHT kg/m	9.084
SECTION No.	13356
DRAWING No.	13356

PARTY'S NAME	DABIR INDUSTRIES THANE
PARTY'S DRAWING No.	AS PER SPECIFICATION
ALLOY & TEMPER	6061 T4
DESCRIPTION	ROUND TUBE