

P-19919-1

S6437

14196

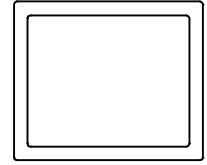

SCALE:- 1:1

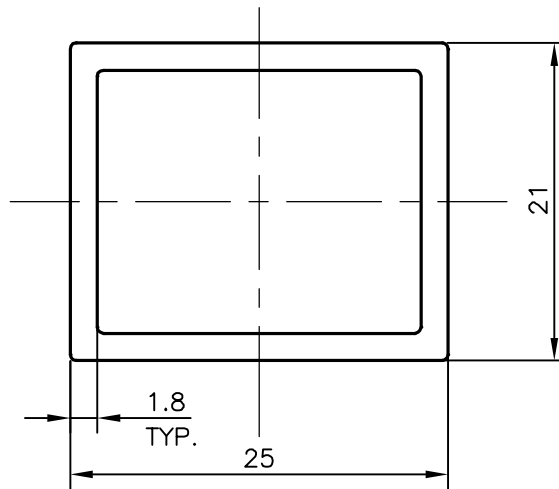

TOLERANCES ON OVERALL DIMENSIONS OF HOLLOW SECTIONS

UPTO 20.0mm - ±0.30	UPTO 80.0mm - ±0.70	UPTO 180.0mm - ±1.27	1. STRAIGHTNESS=1.7mm/M 2. TWIST=1.7mm/M 3. ANGULARITY= ±1° 4. FLATNESS =0.006xWIDTH
UPTO 30.0mm - ±0.38	UPTO 100.0mm - ±0.80	UPTO 200.0mm - ±1.40	
UPTO 40.0mm - ±0.45	UPTO 120.0mm - ±0.90	UPTO 225.0mm - ±1.52	
UPTO 50.0mm - ±0.52	UPTO 140.0mm - ±1.00		
UPTO 60.0mm - ±0.60	UPTO 160.0mm - ±1.14		



SYMBOL OF QUALITY  
AN ISO 9001 COMPANY

**JINDAL ALUMINIUM LTD.**  
BANGALORE-560073 (INDIA)

		NAME	DATE
DRAWN		DARPAN	02-08-2019
CHECKED			
APPROVED		B.NATARAJA	14-08-2019
SCALE			2:1
AREA mm <sup>2</sup>			152.64
PERIMETER mm.			91.313
WEIGHT kg/m			0.412
DRAWING No.		SECTION No.	
P-19919-1		-	
S6437		S6437	
14196		14196	

1. ALL DIMENSIONS ARE IN mm.
2. ROUND OFF ALL SHARP CORNERS WITH 0.40 mm.
3. TOLERANCES WILL BE AS PER IS:6477-1983 , UNLESS OTHERWISE SPECIFIED

PARTY'S NAME	LOMA CO-DEVELOPERS 2 PRIVATE LIMITED., NAVI MUMBAI.
PARTY'S DRAWING No.	AS PER AUTOCAD DRAWING 3488
ALLOY & TEMPER	6063 T6
DESCRIPTION	RECTANGULAR TUBE