

2641

14912

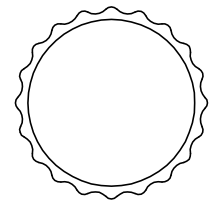

SCALE 1:1

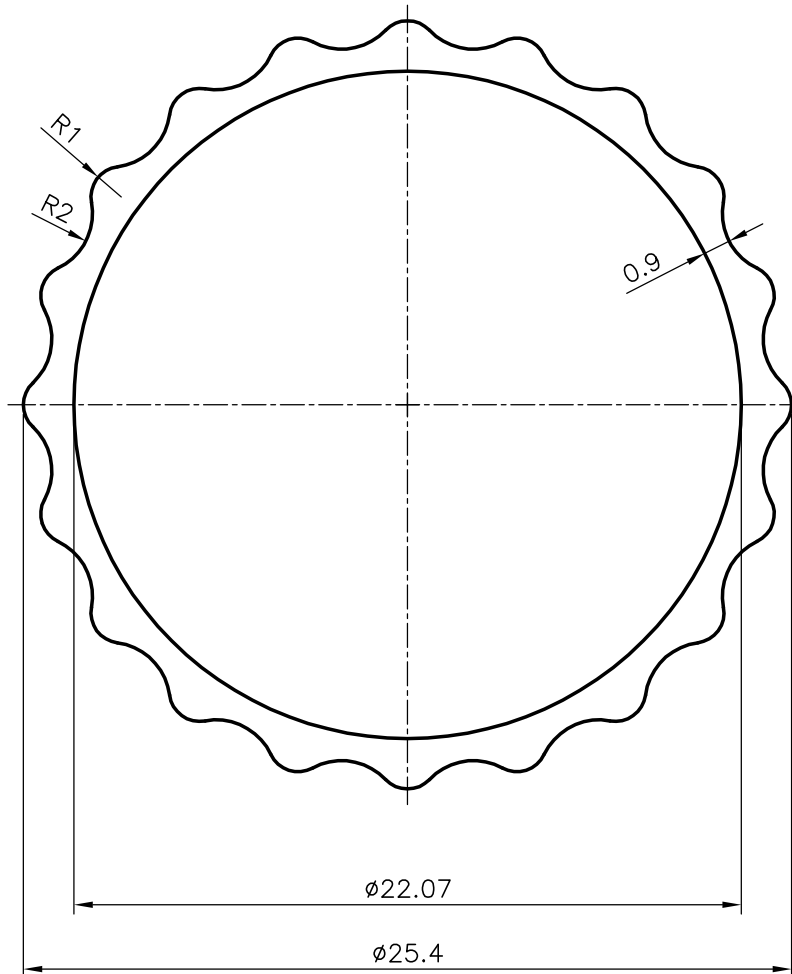

3658 mm, LONG PIECES IN 100 Kgs = 110 (AVERAGE)



SYMBOL OF QUALITY
AN ISO 9002 COMPANY

JINDAL ALUMINIUM LTD.
BANGALORE-560073 (INDIA)

| | NAME | DATE |
|----------|-------------|------------|
| DRAWN | RAGHAVENDRA | 25-02-2004 |
| CHECKED | | |
| APPROVED | | |

1. ALL DIMENSIONS ARE IN mm.
2. ROUND OFF ALL SHARP CORNERS WITH 0.40 mm.
3. TOLERANCES WILL BE AS PER IS:6477-1983 UNLESS OTHERWISE SPECIFIED

| | |
|----------------------|--------|
| SCALE | 4:1 |
| AREA mm ² | 91.383 |
| PERIMETER mm. | 85.025 |
| WEIGHT kg/m | 0.247 |

| PARTY'S NAME | GENERAL CATEGORY | DRAWING No. | SECTION No. |
|---------------------|-------------------|-------------|-------------|
| PARTY'S DRAWING No. | — | 2641 | 2641 |
| ALLOY & TEMPER | HE9 WP | 14912 | 14912 |
| DESCRIPTION | FLUTED ROUND TUBE | | |