

P-13263-1

S4068

15259

☞ *SINCE THICKNESS VARIATION IS HIGH,
& THIS IS IN HARD ALLOY (6061)
THERE MAY BE SOME IMPRESSION MARK
OR COLOUR DIFFERENCE ON SURFACE
IN EXTRUDED PRODUCTS.
AT FOUR JOINTS AS SHOWN.*

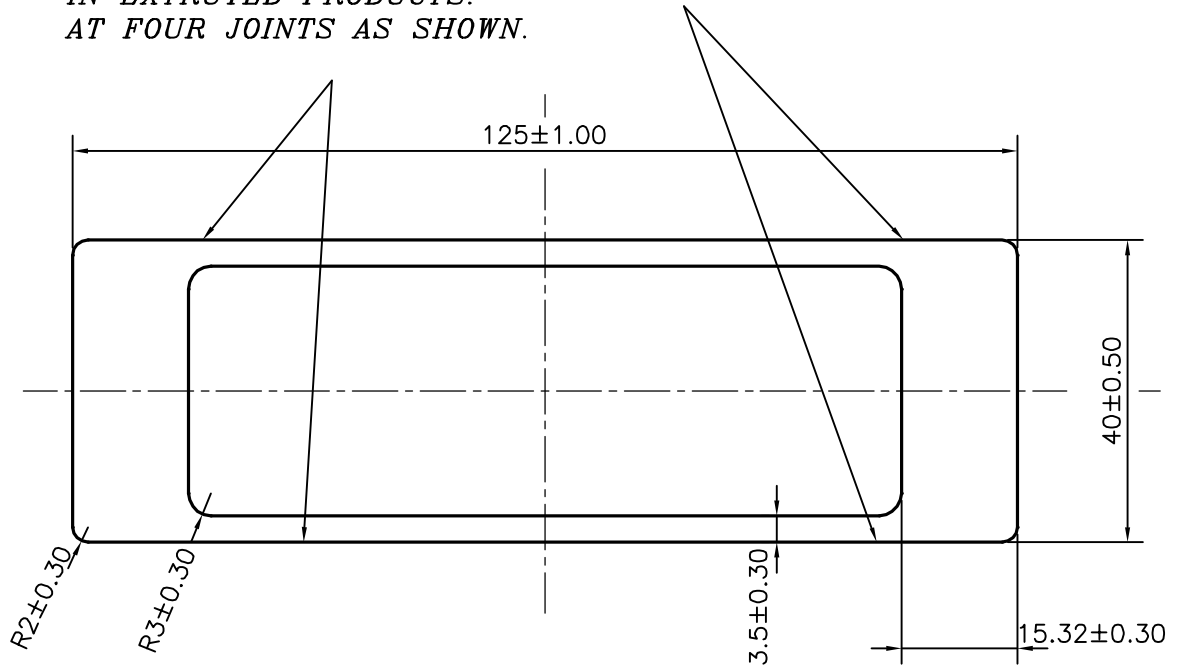

NOTE: CUT LENGTH : 475 ^{+5.00}/_{-0.00}



SYMBOL OF QUALITY
AN ISO 9001 COMPANY

JINDAL ALUMINIUM LTD.
BANGALORE-560073 (INDIA)

	NAME	DATE
DRAWN	SRIVATHSA	24-12-2013
CHECKED		
APPROVED	S.S.GARG	26-03-2014
SCALE		1:1
AREA mm ²		1890.412
PERIMETER mm.		326.566
WEIGHT kg/m		5.104
DRAWING No.	SECTION No.	
P-13263-1	-	
S4068	S4068	
15259	15259	

1. ALL DIMENSIONS ARE IN mm.
2. ROUND OFF ALL SHARP CORNERS WITH 0.40 mm.
3. TOLERANCES WILL BE AS PER BS:EN-755-9 , UNLESS OTHERWISE SPECIFIED

PARTY'S NAME	THE DIRECTOR, IIA INDIAN INSTITUTE OF ASTROPHYSICS, BANGALORE
PARTY'S DRAWING No.	M1S-100-01263 REV. B
ALLOY & TEMPER	6061 T651
DESCRIPTION	MISC. RECTANGULAR TUBE