

P-9615

15739

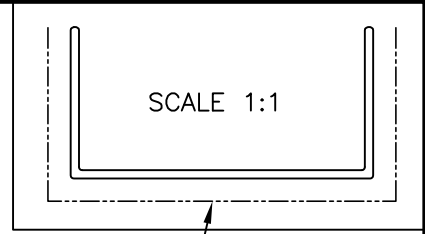

EXPOSED SURFACE
BETTER FINISH REQUIRED

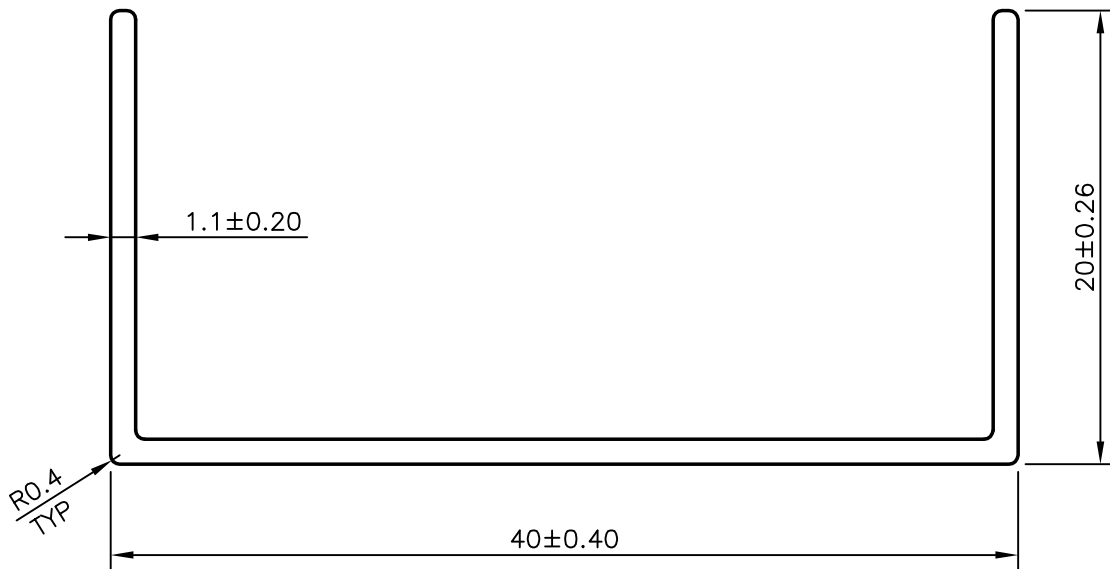

SYMBOL OF QUALITY
AN ISO 9001 COMPANY

JINDAL ALUMINIUM LTD.
BANGALORE-560073 (INDIA)

	NAME	DATE
DRAWN	RAGHAVENDRA	05-11-2009
CHECKED		
APPROVED		

1. ALL DIMENSIONS ARE IN mm.
2. ROUND OFF ALL SHARP CORNERS WITH 0.40 mm.
3. TOLERANCES WILL BE AS PER BS:EN-755, UNLESS OTHERWISE SPECIFIED

SCALE	3:1
AREA mm ²	85.443
PERIMETER mm.	156.427
WEIGHT kg/m	0.231

PARTY'S NAME	EASA HUSAIN AL-YOUSIFI & SONS CO., KUWAIT	DRAWING No.	P-9615	SECTION No.	-
PARTY'S DRAWING No.	AS PER DRAWING (718-A)		15739		15739
ALLOY & TEMPER	6063 T6				
DESCRIPTION	CHANNEL SECTION				