

3166
16011

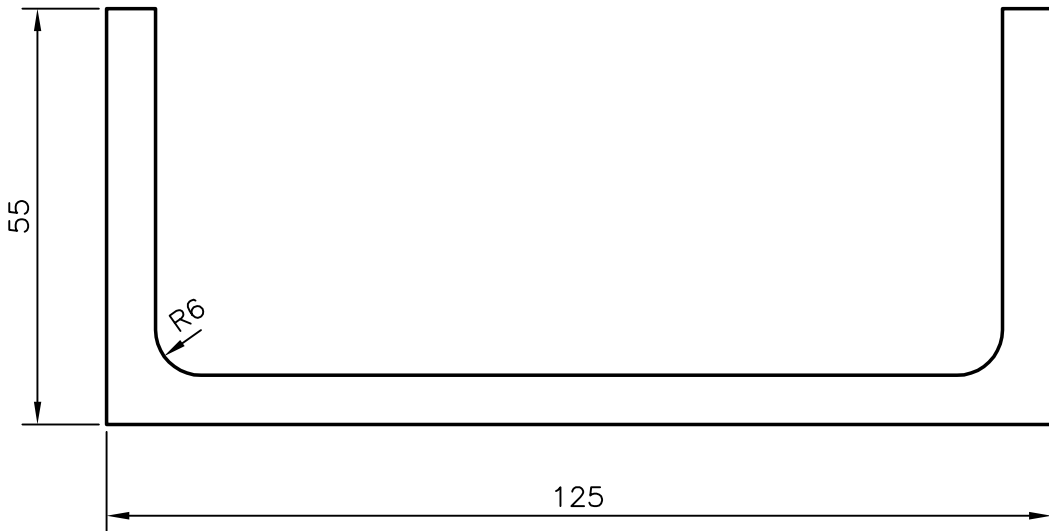

GENERAL WALL THICKNESS :- 6.50 mm.

<i>JINDAL ALUMINIUM LTD.</i> <i>BANGALORE-560073</i>			NAME	DATE
		DRAWN	R.D.Sharma	26-11-97
1. ALL DIMENSIONS ARE IN mm. 2. ROUND OFF ALL SHARP CORNERS WITH 0.4 mm. 3. TOLERANCES WILL BE AS PER IS: 3965-1981 ,UNLESS OTHERWISE SPECIFIED		CHECKED		
		APPROVED		
		SCALE	1:1	
PARTY'S NAME	POONA BEARING INDUSTRIES (P) LTD., POONA	WEIGHT kg/m	3.938	
PARTY'S DRAWING No.	-	SECTION No.	16011	
ALLOY & TEMPER	HE30 WP	DRAWING No.	16011	
LENGTH	4110 mm.			
DESCRIPTION	CHANNEL- ROUND FILLET TOES			