

P-16384

16156

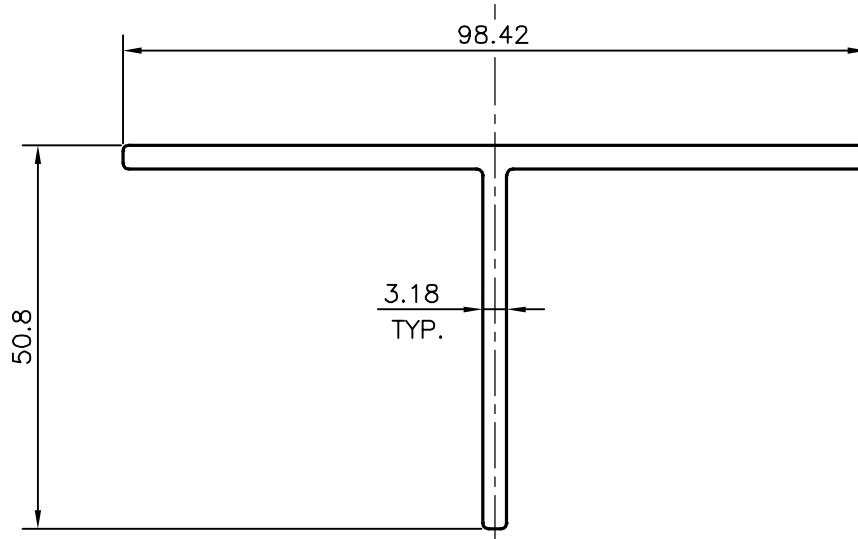

COMMON RADIUS WILL BE 0.80 mm, UNLESS OTHERWISE SPECIFIED



SYMBOL OF QUALITY
AN ISO 9001 COMPANY

JINDAL ALUMINIUM LTD.
BANGALORE-560073 (INDIA)

	NAME	DATE
DRAWN	KIRAN	21-09-2016
CHECKED		
APPROVED	S.S. GARG	23-09-2016

1. ALL DIMENSIONS ARE IN mm.
2. ROUND OFF ALL SHARP CORNERS WITH 0.40 mm.
3. TOLERANCES WILL BE AS PER EN:755/9 , UNLESS OTHERWISE SPECIFIED

SCALE	1:1
AREA mm ²	463.858
PERIMETER mm.	295.693
WEIGHT kg/m	1.252

PARTY'S NAME	COPALCOR TRADING, SOUTH AFRICA
--------------	--------------------------------

PARTY'S DRAWING No.	AC31424
---------------------	---------

ALLOY & TEMPER	6063 T6
----------------	---------

DESCRIPTION	T-SECTION
-------------	-----------

DRAWING No.	SECTION No.
P-16384	-
16156	16156