

P-6539-1

19602

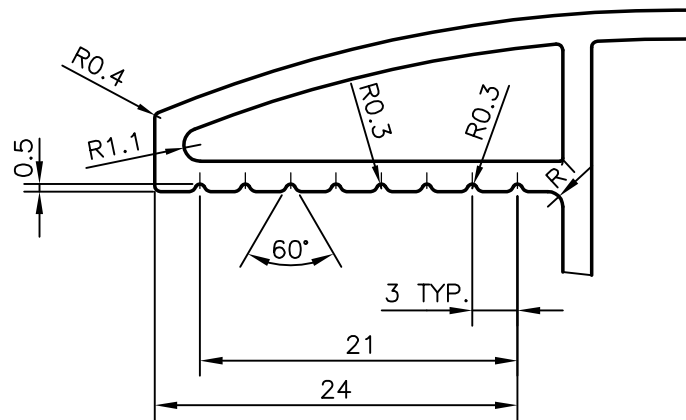

DETAIL AT "A"

(SCALE 2:1)

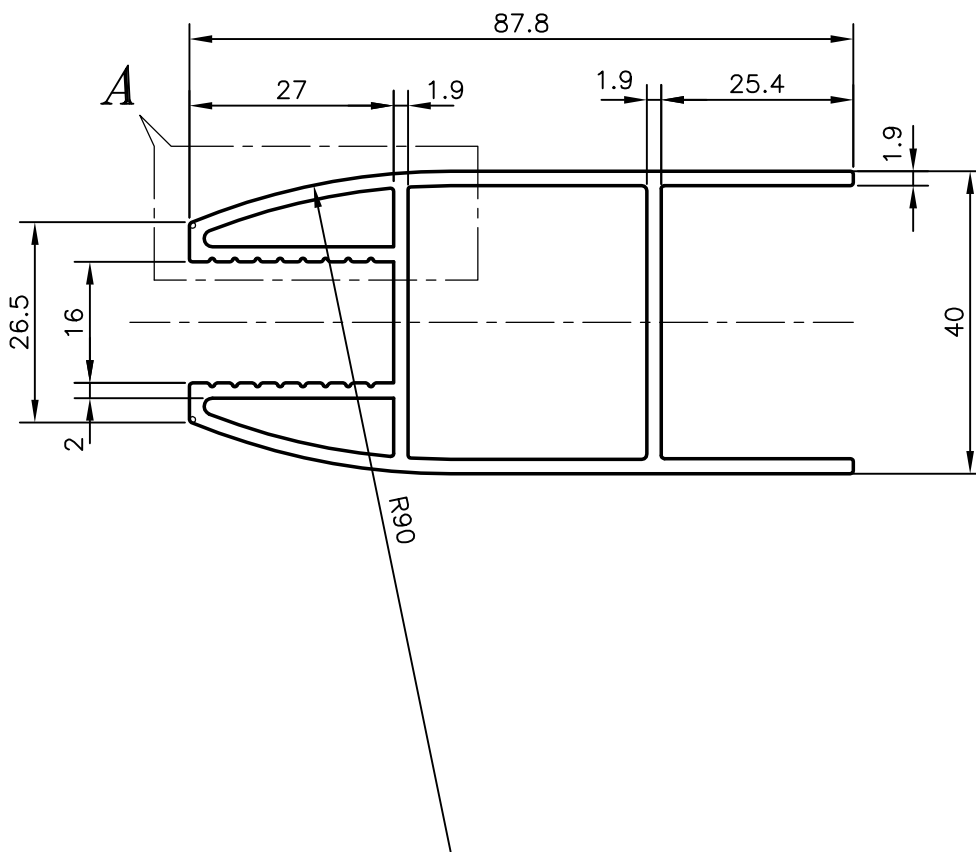

SYMBOL OF QUALITY
AN ISO 9001 COMPANY

JINDAL ALUMINIUM LTD.
BANGALORE-560073 (INDIA)

| | NAME | DATE |
|----------|-------------|------------|
| DRAWN | J.P.KAUSHIK | 09-10-2007 |
| CHECKED | | |
| APPROVED | | |

1. ALL DIMENSIONS ARE IN mm.
2. ROUND OFF ALL SHARP CORNERS WITH 0.40 mm.
3. TOLERANCES WILL BE AS PER IS:6477-1983 UNLESS OTHERWISE SPECIFIED

| | |
|----------------------|---------|
| SCALE | 1:1 |
| AREA mm ² | 585.654 |
| PERIMETER mm. | 353.78 |
| WEIGHT kg/m | 1.581 |

| | |
|---------------------|---------------------------------|
| PARTY'S NAME | GENERAL CATEGORY, COCHIN MARKET |
| PARTY'S DRAWING No. | AS PER SAMPLE |
| ALLOY & TEMPER | HE9 WP |
| DESCRIPTION | DOOR SECTION |

| DRAWING No. | SECTION No. |
|-------------|----------------|
| P-6539-1 | - |
| 19602 | 19602(ISSUE-2) |