

P-5368

X379

20121

EXPOSED SURFACE
BETTER FINISH REQUIRED

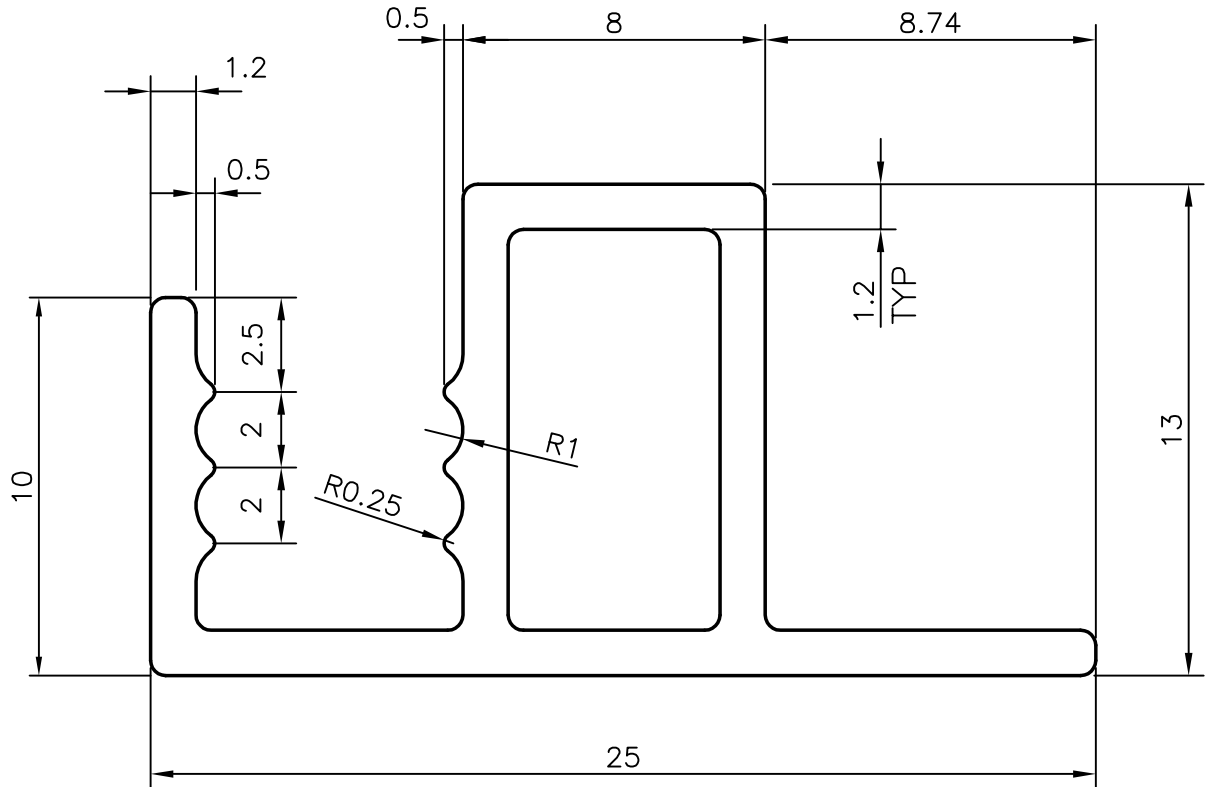
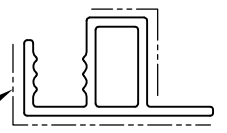

AVERAGE WEIGHT:- 0.768 kg/ 3658 mm.



SYMBOL OF QUALITY
AN ISO 9001 COMPANY

JINDAL ALUMINIUM LTD.
BANGALORE-560073 (INDIA)

	NAME	DATE
DRAWN	MALINGAPPA	12.03.2005
CHECKED		
APPROVED		

1. ALL DIMENSIONS ARE IN mm.
2. ROUND OFF ALL SHARP CORNERS WITH 0.40 mm.
3. TOLERANCES WILL BE AS PER IS: 6477-1983 UNLESS OTHERWISE SPECIFIED

SCALE	5:1
AREA mm ²	77.884
PERIMETER mm.	93.79
WEIGHT kg/m	0.210

PARTY'S NAME	S.S. METALS, COCHIN.
PARTY'S DRAWING No.	LIGHTER OF SECTION NO. 20107
ALLOY & TEMPER	HE9 WP
DESCRIPTION	MISCELLANEOUS SECTION

DRAWING No.	SECTION No.
P-5368	-
X379	X379
20121	20121