

8892
12274
20796

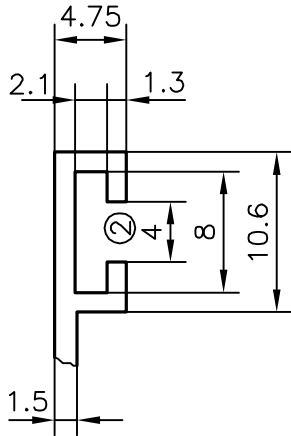

A = 2x
(2:1)

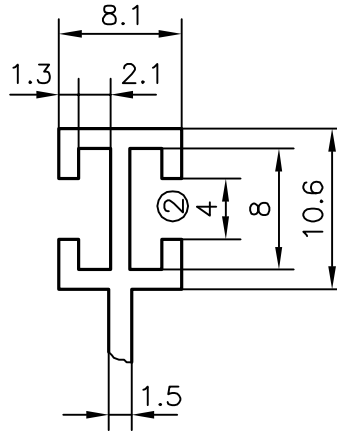

B = 3x
(2:1)

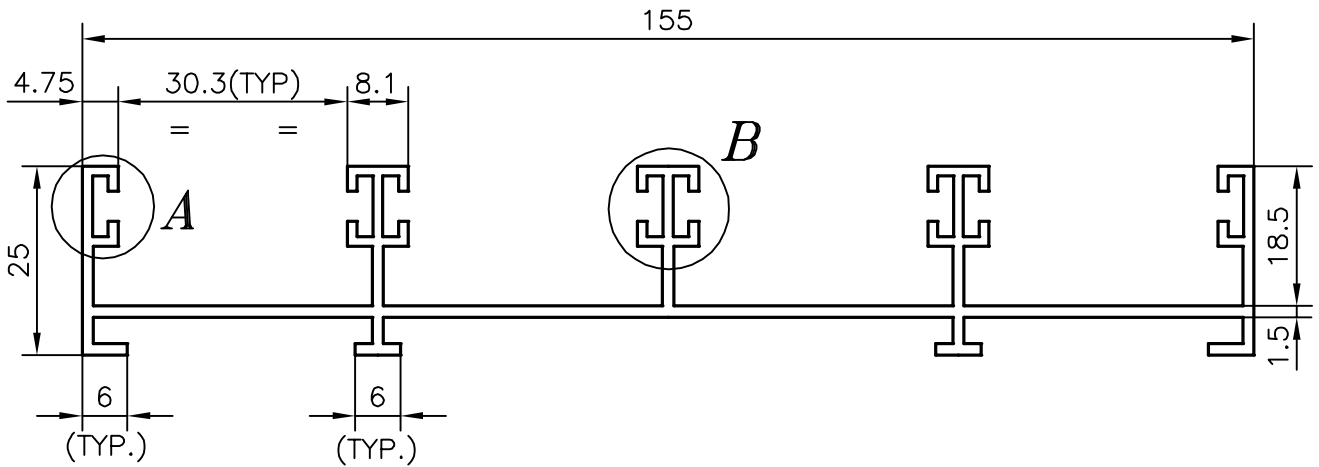

METHOD OF BUNDLING (PACKING)

SCALE
N.T.S.

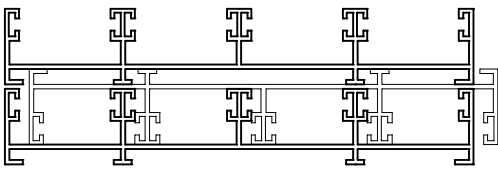

GENERAL WALL THICKNESS:- 1.50 mm.,
UNLESS OTHERWISE SPECIFIED

2	DIMENSION CHANGED FROM 5 mm. TO 4 mm., AS PER PARTY'S REQUIREMENTS (02-08-97)		
<i>ISSUE</i>	<i>DESCRIPTION</i>	<i>CHD BY</i>	<i>APPD BY</i>

REVISION

JINDAL ALUMINIUM LTD.
BANGALORE-560073

		NAME	DATE
		DRAWN	R.D.Sharma 13-08-96
		CHECKED	
		APPROVED	
PARTY'S NAME	AMBIKA METAL, MUMBAI	SCALE	1:1 & 2:1
PARTY'S DRAWING No.	AS PER SAMPLE	WEIGHT kg/m	1.434
ALLOY & TEMPER	HE9 WP	SECTION No.	20796
LENGTH	3658 mm.	DRAWING No.	
DESCRIPTION	WINDOW SECTION	20796	

1. ALL DIMENSIONS ARE IN mm.
2. ROUND OFF ALL SHARP CORNERS WITH 0.4 mm.
3. TOLERANCES WILL BE AS PER IS: 3965-1981 ,UNLESS OTHERWISE SPECIFIED