

8893
12275
20797

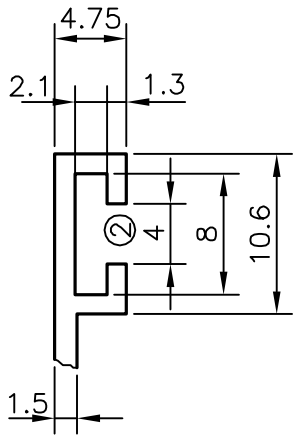

A = 2x
(2:1)

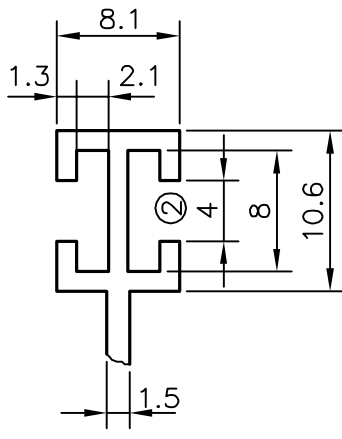

B = 3x
(2:1)

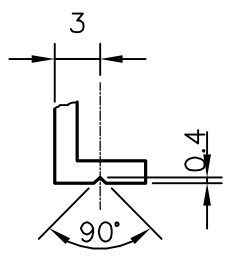

C = 2x
(2:1)

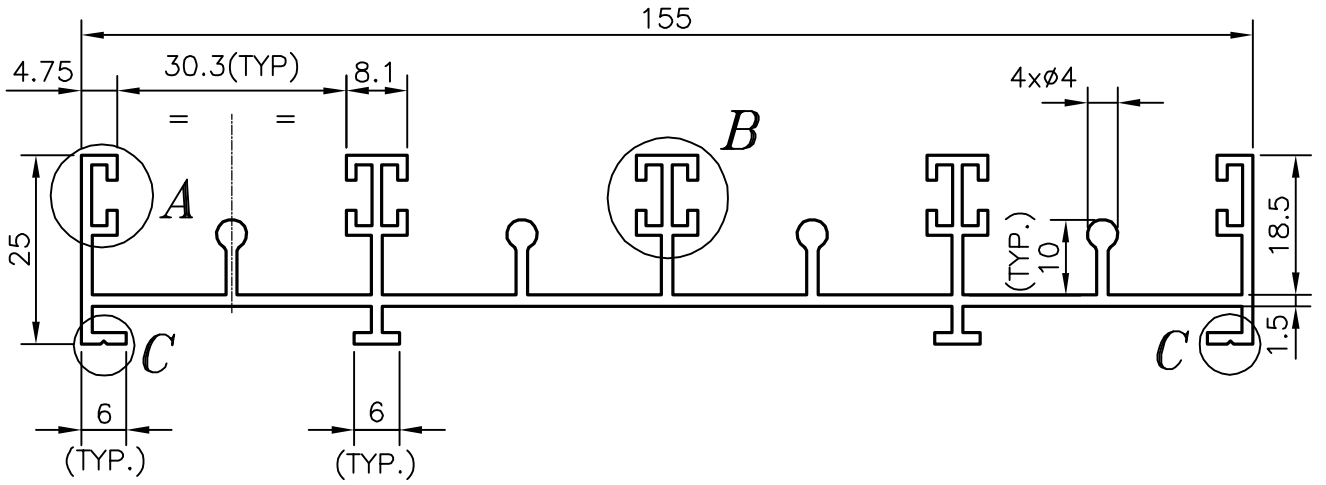

METHOD OF BUNDLING (PACKING) SCALE N.T.S.

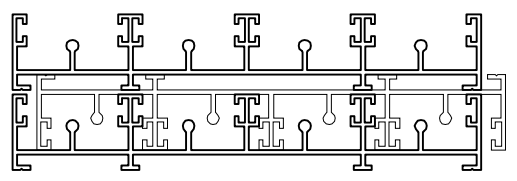

GENERAL WALL THICKNESS:- 1.50 mm.,
UNLESS OTHERWISE SPECIFIED

2	DIMENSION CHANGED FROM 5 mm. TO 4 mm., AS PER PARTY'S REQUIREMENTS (02-08-97)		
ISSUE	DESCRIPTION	CHD BY	APPD BY

REVISION

JINDAL ALUMINIUM LTD.
BANGALORE-560073

		NAME	DATE
		DRAWN	R.D.Sharma 13-08-96
		CHECKED	
		APPROVED	
PARTY'S NAME	BHARAT ALUMINIUM CENTRE, MUMBAI	SCALE	1:1 & 2:1
PARTY'S DRAWING No.	AS PER SAMPLE	WEIGHT kg/m	1.667
ALLOY & TEMPER	HE9 WP	SECTION No.	20797
LENGTH	3658 mm.	DRAWING No.	
DESCRIPTION	WINDOW SECTION	20797	

1. ALL DIMENSIONS ARE IN mm.
2. ROUND OFF ALL SHARP CORNERS WITH 0.4 mm.
3. TOLERANCES WILL BE AS PER IS: 3965-1981 ,UNLESS OTHERWISE SPECIFIED