

P-3981

9386

20981

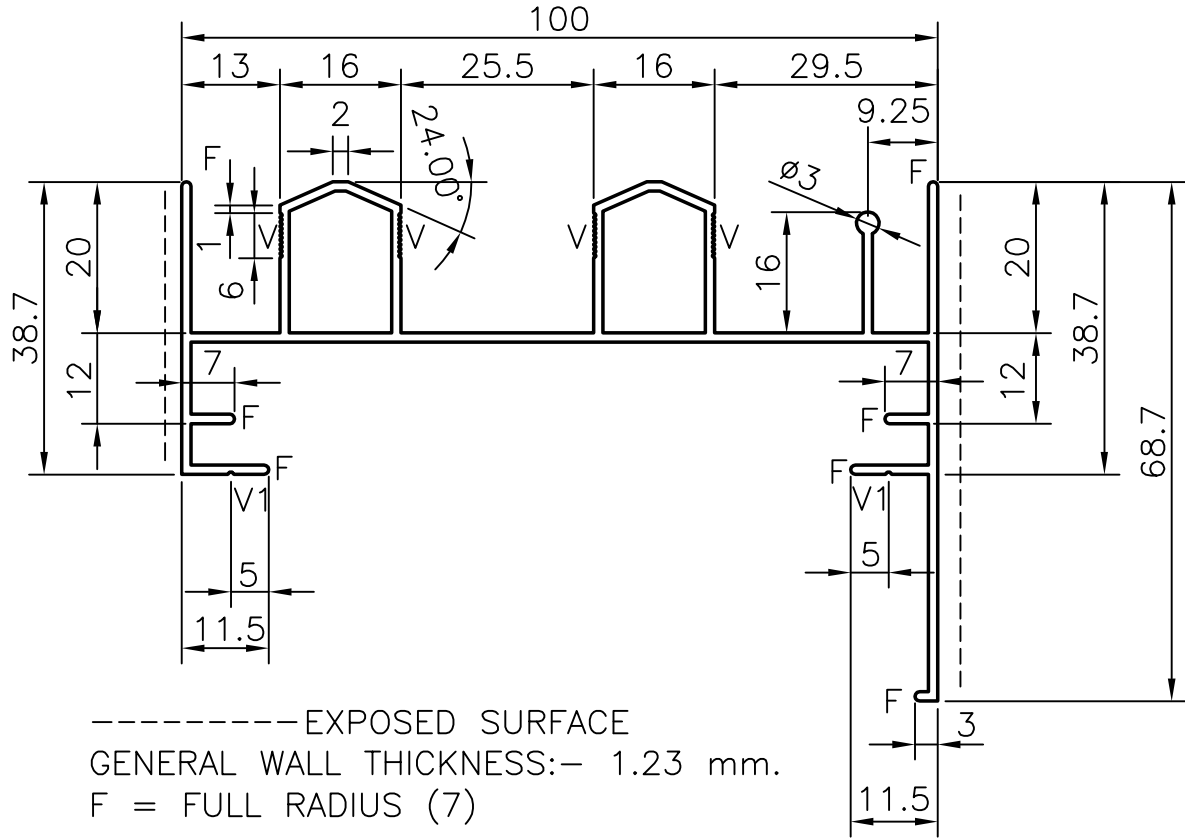

----- EXPOSED SURFACE
 GENERAL WALL THICKNESS:- 1.23 mm.
 F = FULL RADIUS (7)
 V = 0.3x90° 'VEE' GROOVE (40)
 V1 = 0.3x90° 'VEE' GROOVE (2)
 MATCHING SECTION:- 9391



SYMBOL OF QUALITY
 AN ISO 9002 COMPANY

JINDAL ALUMINIUM LTD.
 BANGALORE-560073 (INDIA)

NAME DATE

DRAWN MALINGAPPA 20.10.2003

CHECKED

APPROVED

SCALE 1:1

AREA mm² 432.3

PERIMETER 593.9 mm

WEIGHT kg/m 1.167

SECTION No. 20981

DRAWING No. 20981

1. ALL DIMENSIONS ARE IN mm.
2. ROUND OFF ALL SHARP CORNERS WITH 0.40 mm.
3. TOLERANCES WILL BE AS PER BS 1474-1987 UNLESS OTHERWISE SPECIFIED

PARTY'S NAME OXFORD ALUMINIUM & GLASS WORKS, DUBAI

PARTY'S DRAWING No. OX-102

ALLOY & TEMPER 6063 T6

DESCRIPTION WINDOW SECTION