

P-6564

S1802

21180

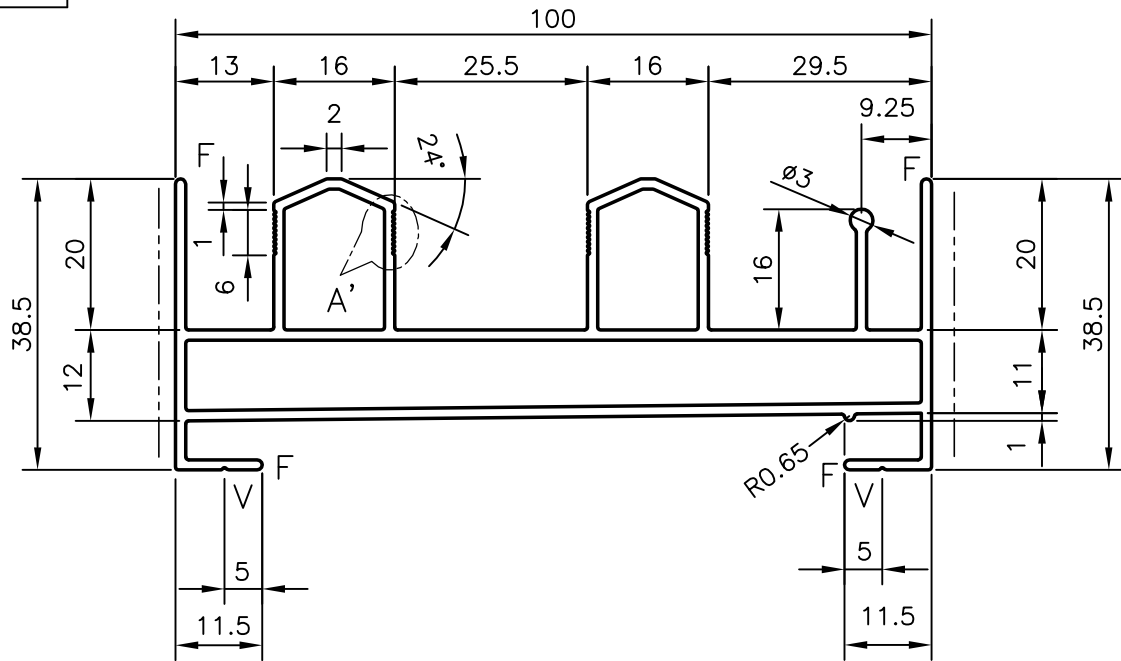

----- EXPOSED SURFACE
 GENERAL WALL THICKNESS:- 1.35 mm.
 F = FULL RADIUS (4)
 V = 0.3x90° 'VEE' GROOVE (2)

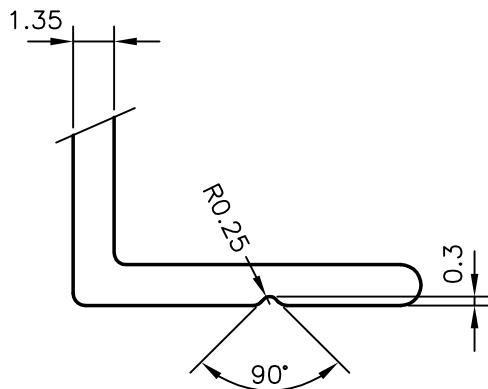

'VEE' GROOVE DETAILS

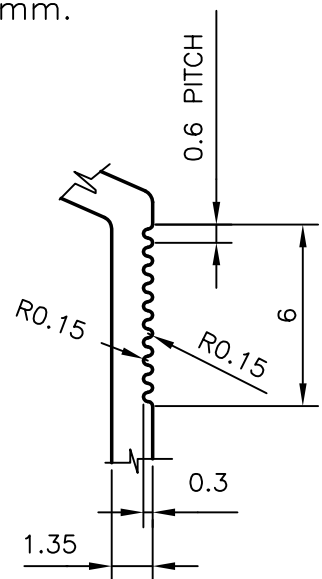

DETAIL 'A'



SYMBOL OF QUALITY
 AN ISO 9001 COMPANY

JINDAL ALUMINIUM LTD.
 BANGALORE-560073 (INDIA)

	NAME	DATE
DRAWN	j.p.kaushik	11-07-2006
CHECKED		
APPROVED		
SCALE		1:1
AREA mm ²		547.382
PERIMETER mm.		484.919
WEIGHT kg/m		1.478
DRAWING No.	SECTION No.	
P-6564	-	
S1802	S1802	
21180	21180	

1. ALL DIMENSIONS ARE IN mm.
2. ROUND OFF ALL SHARP CORNERS WITH 0.40 mm.
3. TOLERANCES WILL BE AS PER IS:6477-1983 UNLESS OTHERWISE SPECIFIED

PARTY'S NAME R & R ALUTECH PVT. LTD. BANGALORE

PARTY'S DRAWING No. AS PER SKETCH

ALLOY & TEMPER HE9 WP

DESCRIPTION WINDOW SECTION